



Flora and Fauna Assessment

Department of Education

31 January 2025

School Name	Melrose Park High School	Consultancy Name	Water Technology
School ID Number	2114	Report Status	Draft
School Address	Corner of Hope Street and Wharf Road, Melrose Park	Report Date	31 January 2025
School Region	City of Paramatta	Contract Number	DDWO05306/23

Document Status

Version	Doc type	Reviewed by	Approved by	Date issued
1.0	Draft	C. Radford	M. Aberton	19 November 2024
2.0	Draft	M.Huxley	M. Aberton	22 November 2024
3.0	Draft	M.Huxley	M.Aberton	31 January 2025
4.0	Draft	M.Huxley	M.Aberton	31 January 2025
5.0	Draft	M.Huxley	M.Aberton	31 January 2025

Project Details

Project Name	Melrose Park High School
Client	Department of Education
Water Technology Project Manager	Narelle Poole
Water Technology Project Director	Steven Molino
Authors	Marion Huxley
Document Number	4.0



Education

COPYRIGHT

Water Technology Pty Ltd has produced this document in accordance with instructions from Department of Education for their use only. The concepts and information contained in this document are the copyright of Water Technology Pty Ltd. Use or copying of this document in whole or in part without written permission of Water Technology Pty Ltd constitutes an infringement of copyright.

Water Technology Pty Ltd does not warrant this document is definitive nor free from error and does not accept liability for any loss caused, or arising from, reliance upon the information provided herein.

Suite 3, Level 1, 20 Wentworth Street
Parramatta NSW 2150
Telephone (02) 8080 7346
ACN 093 377 283



ACKNOWLEDGEMENT OF COUNTRY

The Board and employees of Water Technology acknowledge and respect the Aboriginal and Torres Strait Islander Peoples as the Traditional Custodians of Country throughout Australia. We specifically acknowledge the Traditional Custodians of the land on which our offices reside and where we undertake our work.

We respect the knowledge, skills and lived experiences of Aboriginal and Torres Strait Islander Peoples, who we continue to learn from and collaborate with. We also extend our respect to all First Nations Peoples, their cultures and to their Elders, past and present.



Artwork by Maurice Goolagong 2023. This piece was commissioned by Water Technology and visualises the important connections we have to water, and the cultural significance of journeys taken by traditional custodians of our land to meeting places, where communities connect with each other around waterways.

The symbolism in the artwork includes:

- Seven circles representing each of the States and Territories in Australia where we do our work
- Blue dots between each circle representing the waterways that connect us
- The animals that rely on healthy waterways for their home
- Black and white dots representing all the different communities that we visit in our work
- Hands that are for the people we help on our journey

CONTENTS

1	EXECUTIVE SUMMARY	6
2	INTRODUCTION AND DECLARATION	7
2.1	Summary of the Activity	7
2.2	Determination	8
2.3	Significance of Environmental Impacts	8
3	DELIVERABLE	9
4	PROJECT JUSTIFICATION	10
4.1	Options	10
4.2	Consideration of Ecologically Sustainable Development	10
5	SITE DESCRIPTION	11
5.1	Site Location and Background	11
6	RELEVANT LEGISLATION	13
6.1	Environmental Planning, Assessment Act 1979 and Local Government Act 1993	13
6.1.1	State Environmental Planning Policy (Transport and Infrastructure) 2021	13
6.2	Water Management Act 2000	13
6.3	Biodiversity Conservation Act 2016	13
6.4	Environment Protection and Biodiversity Conservation Act 1999	14
6.5	Parramatta Local Environmental Plan 2023	14
6.6	Parramatta Development Control Plan 2011 – As amended 13 Mar 2020	14
7	EXISTING ENVIRONMENT	15
7.1	Existing Environment	15
7.1.1	Desktop search	15
7.1.2	Vegetation communities	15
7.1.3	Threatened Species	15
7.1.4	Supporting Documents	15
7.2	Site Visit	19
7.2.1	Flora	19
7.2.2	Fauna	19
8	SIGNIFICANCE OF ENVIRONMENTAL IMPACTS	22
9	POTENTIAL IMPACTS	23
9.1	Construction Impacts	23
9.1.1	Vegetation	23
9.1.2	Grey-headed Flying-fox	23
9.1.3	Contractors and Staff Inductions	23
9.1.4	Hygiene	23
9.1.5	Mitigation Measures	27

10	CONCLUSION AND RECOMMENDATIONS	29
11	REFERENCES	31

APPENDICES

Appendix A Protected Matters Search

Appendix B Likelihood of Occurrence

Appendix C Arborist Report - Rev A

LIST OF FIGURES

Figure 5-1	Site Aerial	12
Figure 7-1	Plant Community Types	16
Figure 7-2	Historic Image	17
Figure 7-3	Threatened species	18
Figure 7-4	Tree Protection Zones	20
Figure 9-1	Plans courtesy of NBRS Nominated Architects	24
Figure 9-2	Constraints Map	25
Figure 9-3	Draft Copy Tree Plan curtesy of Naturally Trees	26

LIST OF TABLES

Table 3-1	FFA Deliverable	9
Table 4-1	Consideration of principles of ecologically sustainable development (ESD)	10
Table 7-1	Tree Inventory	21
Table 9-1	Mitigation measures for pre-construction impacts (PI)	27
Table 9-2	Mitigation measures for construction impacts (CI)	28
Table 10-1	Project Stage Design (D) Construction (C) Operation (O)	29

ACRONYMS AND DEFINITIONS

Acronym	Definition
BC Act	<i>Biodiversity Conservation Act 2016</i>
BV	Biodiversity Values
DCP	Development Control Plan
DD	Due Diligence
EP&A Act	<i>Environmental Planning and Assessment Act 1979</i>
EPBC Act	<i>Environment Protection and Biodiversity Conservation Act 1999</i>
FM Act	<i>Fisheries Management Act 1994</i>
LEP	Local Environment Plan
LGA	Local Government Area
MNES	Matter of National Environmental Significance
PCT	Plant Community Type
FFA	Flora and Fauna Assessment
SEARS	Secretary's Environmental Assessment Requirements
SINSW	Schools Infrastructure New South Wales
SSD	State Significant Development
TEC	Threatened Ecological Community
WM Act	<i>Water Management Act 2000</i>

1 EXECUTIVE SUMMARY

A Flora and Fauna Assessment has been conducted to identify potential constraints that may impede the future school infrastructure of the Melrose Park High School. This assessment aims to seek approval for a development without consent application under Part 5 of the EP&A Act, mitigating any risks during the delivery of the school. This report documents the findings of the biodiversity assessment, identifying potential biodiversity constraints relevant to the proposed development under the NSW Biodiversity Conservation Act 2016, Commonwealth Environment Protection and Biodiversity Conservation Act 1999, and the NSW Fisheries Management Act 1994.

As the planning pathway is under Part 5 of the EP&A Act a Biodiversity Development Assessment Report (BDAR) nor Species Impact Statement (SIS) was required for the proposed development of Melrose Park High School.

Melrose Park High School is a cleared site. No significant biodiversity areas were mapped, and no Plant Community Types were found on site. All mapped threatened species were determined to have a low likelihood of occurrence, and no evidence of threatened species was observed during the site assessment. The site had no Key Fish habitat.

The Flora and Fauna Assessment concluded that there will be no significant impacts on matters of national environmental significance. As there were no threatened species found, a Test of Significance was not required. Consequently, no referral to the Australian Minister for the Environment under the Environment Protection and Biodiversity Conservation Act 1999 is required. The proposal would be unlikely to cause a significant impact on the environment. Therefore, it is not necessary for an Environmental Impact Statement to be prepared and approval to be sought from the Minister for Planning under the Environment Protection and Biodiversity Conservation Act 1999.

2 INTRODUCTION AND DECLARATION

This Melrose Park High School Flora and Fauna Assessment (FFA) has been prepared by Water Technology on behalf of the Department of Education (DoE) to assess the potential environmental impacts that could arise from the construction and use of the new Melrose Park High School project (the Activity) at 37 Hope Street, Melrose Park. This report supports the assessment of the proposed Activity under Part 5 of the Environmental Planning and Assessment Act 1979. The Activity is proposed by the DoE to meet the growth in educational demand in the Melrose Park precinct.

This report has been prepared to assess potential biodiversity impacts for the Melrose Park High School.

This report accompanies a Review of Environment Factors (REF) that seeks approval for redeveloping the Melrose Park High School. Refer to the Review of Environmental Factors for a full description of works.

The Melrose Park High School will be assessed under Part 5, Division 5.1, the Department of Education serves as both the proponent and the determining authority. The Department of Education must examine all matters likely to affect the environment from this activity.

The construction company will make sure the proposal is carried out as described in this FFA. If the scope of work or work methods, described in this FFA, change significantly following determination, an additional environmental impact assessment, or FFA Addendum, may be required.

2.1 Summary of the Activity

The proposed activity involves the construction and use of a new high school in two stages for approximately 1,000 students.

Stage 1 of the proposed activity includes the following:

- Site preparation works.
- Construction of Block A – a six-storey (with additional roof/plant level) school building in the south-western portion of the site containing staff rooms and General Learning Spaces (GLS).
- Construction of Block B – a one storey (double height) hall, gymnasium, canteen and covered outdoor learning area (COLA) building in the south-eastern portion of the site.
- Construction of Block C – a single storey plant and storage building at the north-eastern portion of the site.
- Associated landscaping.
- Construction of on-site car parking.
- Provision and augmentation of services infrastructure.
- Associated public domain infrastructure works to support the school, including (but not limited to):
- Provision of kiss and drop facilities along Wharf Road, and widening of the Wharf Road footpath.
- Raised pedestrian crossings on Wharf Road and Hope Street.

Stage 2 of the proposed activity includes the following:

- Construction of Block D – a five-storey (with additional roof/plant level) school building in the north-western portion of the site containing staff rooms and GLS:
- Additional open play spaces within the terrace areas of Building D.
- Minor layout amendments to Block A.

The Review of Environmental Factors prepared by Ethos Urban provides a full description of the proposed works.

2.2 Determination

- The proposed activity can proceed subject to mitigation measures and/or conditions relayed in this FFA.
- The activity is unlikely to be classed as a controlled action under the Commonwealth Environmental Protection and Biodiversity Conservation Act 1999 (EPBC Act) so no referral is required.

2.3 Significance of Environmental Impacts

Based on the identification of potential issues, and an assessment of the nature and extent of the impacts of the proposed development, it is determined that:

- The extent and nature of potential impacts are low and will not have significant impact on the locality, community and/or the environment.
- Potential impacts can be appropriately mitigated or managed to ensure that there is no significant impact on the environment.

3 DELIVERABLE

See below FFA deliverable requirement from Schools Infrastructure New South Wales (SINSW) Table 3-1.

Table 3-1 FFA Deliverable

Item	Requirement	Relevant Section of Report
1.0	Address all relevant legislation, environmental planning instruments (EPIs) (including drafts), plans, policies, guidelines and planning circulars.	See Section 6
2.0	Trees and vegetation	See Section 7
2.1	Assess the number, location, condition and significance of trees to be removed and retained and note any existing canopy coverage to be retained on-site.	See Section 7.2.1
3.0	Ecologically Sustainable Development (ESD)	See Section 4.2
4.0	Biodiversity	See Section 7
4.1	Assess any biodiversity impacts associated with the development in accordance with the Biodiversity Conservation Act 2016 and the Biodiversity Assessment Method 2020.	See Section 9

4 PROJECT JUSTIFICATION

The Melrose Park High School is part of the NSW Government's plan to rebuild public education in 2024-25. This will ensure growing communities get access to public education.

4.1 Options

Option 1 – Do Nothing: Demand for high schools in the region will remain unmet.

Option 2 – Implement Project Proposal: (Preferred option) Melrose Park High School enhanced by providing more educational facilities for the local community. By providing enhanced services and spaces, the new proposed Melrose Park High School aims to meet the current and future needs of the community.

4.2 Consideration of Ecologically Sustainable Development

The proposal has been considered against the principles of ecologically sustainable development (ESD) (refer to Table 4-1).

Table 4-1 Consideration of principles of ecologically sustainable development (ESD)

ESD Principle	Consideration in FFA
Precautionary principle	The proposal will not result in serious or irreversible environmental damage and there is no scientific uncertainty relating to the proposal.
Intergenerational equity	The proposal will help to meet the needs of future generations by providing education facilities, which can be used for future generations.
Conservation of biological diversity and ecological integrity	The proposal will not significantly impact on biological diversity or impact ecological integrity.
Improved valuation, pricing and incentive mechanisms	The proposal will provide cost efficient use of resources and provide optimum outcomes for the community, environment and with respect to financial cost.

5 SITE DESCRIPTION

5.1 Site Location and Background

The site is located at 37 Hope Street, Melrose Park within the Parramatta LGA. The school covers an approximate area of 9,500m² and is generally rectangular in shape. The site is currently cleared and vacant. The site is located approximately 8km east of the Parramatta CBD.

Melrose Park High School is a cleared lot with no buildings and no trees. An aerial image of the site is shown in Figure 5-1 below. The property boundary is distinct from the surveyed site.



Figure 5-1 Site Aerial



6 RELEVANT LEGISLATION

Legislation and policy relevant to the biodiversity component of works within the subject site are outlined below:

6.1 Environmental Planning, Assessment Act 1979 and Local Government Act 1993

Planning and development within NSW is regulated by the Environmental Planning & Assessment Act 1979 (EP&A Act).

The proposed works are permitted without consent under the State Environmental Planning Policy (Transport and Infrastructure) 2021 (TISEPP). Where works do not require development consent but require approval of a Government organisation under any legislation, then they are defined as an activity under Part 5 of the EP&A Act. Division 5.1 and Section 5.7 of the EP&A Act requires any such Government body to determine whether the impacts of the activity are likely to be significant. A FFA contributes to that determination.

A FFA is prepared, to inform a Review of Environmental Factors, to meet the requirements of Clause 171 of the *Environmental Planning and Assessment Regulation 2023*.

6.1.1 State Environmental Planning Policy (Transport and Infrastructure) 2021

The State Environmental Planning Policy (Transport and Infrastructure) 2021 (TISEPP) provides for the efficient provision of public infrastructure in NSW. The aim of this Policy is to facilitate the effective delivery of infrastructure across the State.

6.2 Water Management Act 2000

The Water Management Act 2000 (WM Act) provides for the sustainable and integrated management of the water sources of the State for the benefit of both present and future generations. The WM Act defines principles of water management, sets out water licensing laws and environmental water provisions.

Section 91 (2) states that: *waterfront land means—...where the prescribed distance is 40 metres or (if the regulations prescribe a lesser distance, either generally or in relation to a particular location or class of locations) that lesser distance.*

This project is being carried out further than 40 metres from waterfront so is exempt from requiring a Controlled Activity Approval in accordance with the WM Act.

6.3 Biodiversity Conservation Act 2016

The Biodiversity Conservation Act 2016 (BC Act) includes the Biodiversity Offsets Scheme (BOS) that governs how biodiversity offsets will be used to ensure they offset the loss due to development and deliver conservation outcomes. The Act and Regulations also govern the Biodiversity Assessment Method (BAM) as a scientific method that assesses biodiversity losses from impacts at development sites and gains from conserving land at stewardship sites.

Public authorities seeking to undertake an activity under Part 5 of the EP&A Act can voluntarily opt-in to the BOS and BAM scheme, or alternatively can elect to undertake an Assessment of Significance and proceed with a Part 5 approval. It will be required to:

- take serious and irreversible impacts into consideration; and
- determine if there are any additional and appropriate measures that will minimise the impact if the activity is to be carried out or approved.
- The potential ecological impacts of the proposal are discussed in Section 9 of this FFA.



6.4 Environment Protection and Biodiversity Conservation Act 1999

Under the Commonwealth Environment Protection and Biodiversity Conservation Act 1999 (EPBC Act), Commonwealth approval is required for certain actions. Actions which have or may have or are likely to have a significant impact on Matters of National Environmental Significance (MNES). MNES include nationally threatened species or endangered ecological communities. Under the EPBC Act an assessment of the impact of a proposal on a MNES must be undertaken to determine whether there is likely to be a significant impact. If the assessment concludes there is a significant impact, then it will become a controlled action under the EPBC Act and the proposal must be referred to the Commonwealth. Approval from the relevant Federal Minister is also required for any actions that may have a significant impact on matters of National Environmental Significance, except in circumstances which are set out in the EPBC Act.

Approval from the Commonwealth is in addition to any approvals under NSW legislation.

The potential ecological impacts of the proposal are discussed in Section 9 of this FFA. It is concluded that the proposal is not likely to have a significant impact on any EPBC listed threatened species, populations or communities nor is it likely to impact on any MNES and so does not require referral to the Commonwealth under the EPBC Act.

6.5 Parramatta Local Environmental Plan 2023

The *Parramatta Local Environmental Plan 2023* (LEP) current version came into effect on 18 August 2023. This plan aims to make local environmental planning provisions for land in the Parramatta LGA in accordance with the relevant standard environmental planning instrument.

The works are to be conducted as per LEP zoned land. The objectives of this zone include:

- To provide for infrastructure and related uses.
- To prevent development that is not compatible with or that may detract from the provision of infrastructure.
- The proposed works are compliant with the objectives of this zoning, as it will provide new school infrastructure at the site.

6.6 Parramatta Development Control Plan 2011 – As amended 13 Mar 2020

The aim of the *Parramatta Development Control Plan 2011* (DCP) is to allow detailed provisions to be made to control and guide development and subdivision within the Parramatta LGA.

Several additional Development Control Plans may apply to the subject, including:

- Holroyd DCP 2013 - as amended 22 Jul 2015
- Auburn DCP 2016 - Carter Street Precinct
- Melrose Park North Site-Specific Development Control Plan
- The Hills DCP 2012 - as amended 21 Oct 2016
- Auburn DCP 2014 - Wentworth Point Precinct.pdf
- Auburn DCP 2010 - Amendment 6
- Hornsby DCP 2013 - as amended 18 Dec 2014



7 EXISTING ENVIRONMENT

7.1 Existing Environment

The subject site encompasses an area of approximately 9471m², (Figure 5-1). Melrose Park High School is a cleared lot with no buildings and no trees. Outside the site, there are native trees along the eastern side near the Wharf Road boundary.

7.1.1 Desktop search

Prior to undertaking the ecological field survey, desktop searches were conducted to provide a context of the surrounding environment.

7.1.2 Vegetation communities

A review of the vegetation mapping databases using the SEED portal (NSW Government's central resource for Sharing and Enabling Environmental Data in NSW) was undertaken to identify Plant Community Types (PCTs) present within the area. As indicated in Figure 7-1, no PCTs were mapped as being present within the project site.

Analysis of high-resolution satellite imagery indicated that no native eucalyptus trees are present on the subject site. Previously, the site was occupied by a large building, which has since been demolished and cleared.

Historic photographs from 1943 revealed the trees adjacent to the site boundary were planted and are not remnants of native vegetation (Figure 7-2).

7.1.3 Threatened Species

A search of the DCCEEW BioNet Atlas revealed 4,270 records of 68 listed species were previously recorded within 10 km of the site. Analysis of the Protected Matters Search Tool indicated 13 listed threatened ecological communities, 111 listed threatened species, and 59 listed migratory species previously recorded within 10 km of the subject site. No World Heritage Properties, National Heritage Places, Protected Marine Areas, nor Wetlands of international importance occurred within 10 km of the site (Appendix A).

The DCCEEW BioNet Atlas mapping identified two endangered or threatened species near the site, including *Pteropus poliocephalus* (Grey-headed Flying-fox), and the White-bellied Sea Eagle (*Haliaeetus leucogaster*). The Likelihood of Occurrence analysis indicated the Grey-headed Flying-fox had low likelihood to occur within the site, and the White-bellied Sea Eagle had a low likelihood to occur within the site (Appendix B).

The subject site was not mapped as containing any Key Fish Habitat, nor is it in proximity to significant waterways or waterfront land, thus no further provisions within the FM Act and WM Act are not required for the proposed development.

Due to the cryptic and nocturnal nature of many species, the fauna assessment primarily evaluated the site's potential as habitat. The precautionary principle was adopted, assuming the presence of threatened species if suitable habitat exists.

7.1.4 Supporting Documents

An arboricultural impact appraisal was conducted by Naturally Trees report (2024) to assess the impact of the activity on the trees on the site (Appendix C). The appraisal determined that the activity would have no adverse impact on the trees if appropriate protective measures are taken.



Figure 7-1 Plant Community Types



Figure 7-2 Historic Image



Figure 7-3 Threatened species



7.2 Site Visit

On 6 November 2024, ecologist Petra Arola conducted a site assessment for Melrose Park High School, involving a walkthrough of all accessible vegetated areas.

An opportunistic fauna survey included searches for proxy evidence of fauna activity such as tree scratches, scats, and bird nests. As many faunal species are cryptic and/or nocturnal, they are unlikely to be detected during a short survey. The fauna assessment is largely an assessment of the potential of the site as habitat for various fauna species. Apart from species recorded at the site there is no certainty as to the presence or absence of the species discussed. Therefore, it is important to adopt the precautionary principle, it is assumed that any threatened species are likely to occur at the site if suitable habitat exists.

An assessment of potential habitat features for threatened species, such as tree hollows or crevices in tree bark was also conducted.

7.2.1 Flora

The vegetation on site did not represent any nearby PCTs. The native canopy vegetation present outside the site boundary consisted of five large native trees including spotted gum (*Corymbia maculata*). Figure 7-4 shows the trees at the site and their relative Tree Protection Zones (TPZs). Table 7-1 shows the Tree Inventory Relative to Proposed Site Boundary. Some of the trees outside the site boundary have TPZs within the Site.

These trees occurred along the boundary fence line at Wharf Road. No large, continuous patches of vegetation were present. The subject site was extensively cleared. Analysis of historic images from 1943 indicated that the trees present are most likely planted (Figure 7-2). The canopy trees were isolated from each other by large areas of managed grassland. No trees will be impacted by the proposed activity.

7.2.2 Fauna

The fauna survey did not find potential nesting or roosting habitat such as stick nests or tree hollows within the subject site. Five isolated canopy trees are present adjacent to the eastern boundary fence off the site (Figure 5-1). These did not possess any habitat features such as nests or hollows, and are not likely used by any threatened fauna species. No significant landscape features such as caves, culverts, rivers, or waterbodies were present.



Figure 7-4 Tree Protection Zones



Table 7-1 Tree Inventory

Tree Number	Species	Growth Cycle
1	Spotted Gum (<i>Corymbia maculata</i>)	Mature
2	Spotted Gum (<i>Corymbia maculata</i>)	Mature
3	Spotted Gum (<i>Corymbia maculata</i>)	Mature
4	Spotted Gum (<i>Corymbia maculata</i>)	Mature
5	Spotted Gum (<i>Corymbia maculata</i>)	Mature
6	Eucalyptus sp.	Mature
7	Eucalyptus sp.	Mature
8	Eucalyptus sp.	Mature
9	Eucalyptus sp.	Juvenile
10	Eucalyptus sp.	Juvenile
11	Eucalyptus sp.	Juvenile
12	Eucalyptus sp.	Juvenile
13	Eucalyptus sp.	Juvenile
14	Eucalyptus sp.	Juvenile
15	Eucalyptus sp.	Juvenile
16	Eucalyptus sp.	Juvenile



8 SIGNIFICANCE OF ENVIRONMENTAL IMPACTS

Based on the identification of potential issues, and an assessment of the nature and extent of the impacts of the proposed activity, it is determined that:

- The extent and nature of potential impacts are low and will not have significant impact on the locality, community and/or the environment.
- Potential impacts can be appropriately mitigated or managed to ensure that there is no significant impact on the environment.

No threatened flora or fauna species are considered highly likely to occur within the subject site. The terrestrial flora and fauna survey was limited to less than one hour. The field survey was restricted to the area of impact of the proposed works.

As there were no threatened species nor habitat to support these species found, a Test of Significance was not required. As many faunal species likely to occur within the project area are cryptic and/or nocturnal, or may only visit the site on occasion, they are unlikely to be detected even during seasonal surveys. The fauna assessment is, accordingly, largely an assessment of the potential of the project site as habitat for various fauna species. Therefore, it is important to adopt the precautionary principle such that it is assumed that threatened species may be at the site if suitable habitat exists.



9 POTENTIAL IMPACTS

9.1 Construction Impacts

The following is a summary of the direct and indirect impacts to the biodiversity potentially persisting onsite.

9.1.1 Vegetation

The proposal does not involve the removal of any trees; all existing trees are outside the site boundary and will be incorporated into the Wharf Road Reserve (refer to Figure 9-1 for proposed plans and



Figure 9-2 Constraints Map

for the Constraints map). The constraints map highlights 'no go zones' in red, areas which should not be impacted by construction.

The proposal revealed that there are no trees scheduled for removal. Instead, all trees, located primarily without the eastern side of the site, will be retained and protected. These trees are in good condition and hold significant value, contributing to the site's existing canopy coverage, which will be preserved. Activities will take



place outside the Tree Protection Zones (TPZs) of these established native trees to prevent any damage. Refer to Figure 7-4 for TPZs and Table 7-1 for a tree inventory.

The arboricultural method statement (Naturally Trees report 2024) outlined the necessary precautions to protect the trees, including tree protection fencing, ground protection, working within the TPZ, and a schedule of works and responsibilities. The arboricultural impact appraisal concluded that with these protective measures, the proposed activity could proceed without adversely affecting the trees on site (Appendix C).

The proposed activity may impact nine high-category and two low-category trees by disturbing their TPZs during construction activities such as the removal and installation of surfacing, structures, and landscaping (Figure 9-3). A 3% incursion into the TPZ of Tree 3 is deemed acceptable according to the Australian Standard Protection of Trees on Development Sites (AS4970-2009).

Referring to the Naturally Trees (2024) arborist assessment the proposed path will affect the TPZs of Trees 2, 3, 4, and 5, necessitating a footpath design that accommodates tree roots. A suspended timber or steel structure is recommended to prevent impacts. Trees 8 and 9, being low category, are outside the proposed works area. With the proper precautions detailed in the arboricultural method statement, the activity should not adversely impact the trees or their contribution to local amenity or character (Appendix C).

9.1.2 Grey-headed Flying-fox

The noise, light, and increased human presence from construction activities may disrupt the foraging behaviour of the Grey-headed Flying-fox and deter them from using the site and surrounds. Additionally, any removal of flowering native trees, which serve as important feeding habitats, could reduce the availability of food resources, thereby affecting their feeding patterns and overall health.

9.1.3 Contractors and Staff Inductions

Induction of all contractors and staff outlining the ecological sensitivity of the site, the need to minimise ecological impact, and all other required mitigation measures is to be undertaken.

9.1.4 Hygiene

Basic hygiene protocols would be implemented for construction personnel and machinery on site to reduce the potential for invasion by plant pathogens including *Phytophthora cinnamomi*, the fungus myrtle rust *Uredo rangelli* and amphibian chytrid fungus.





Figure 9-2 Constraints Map

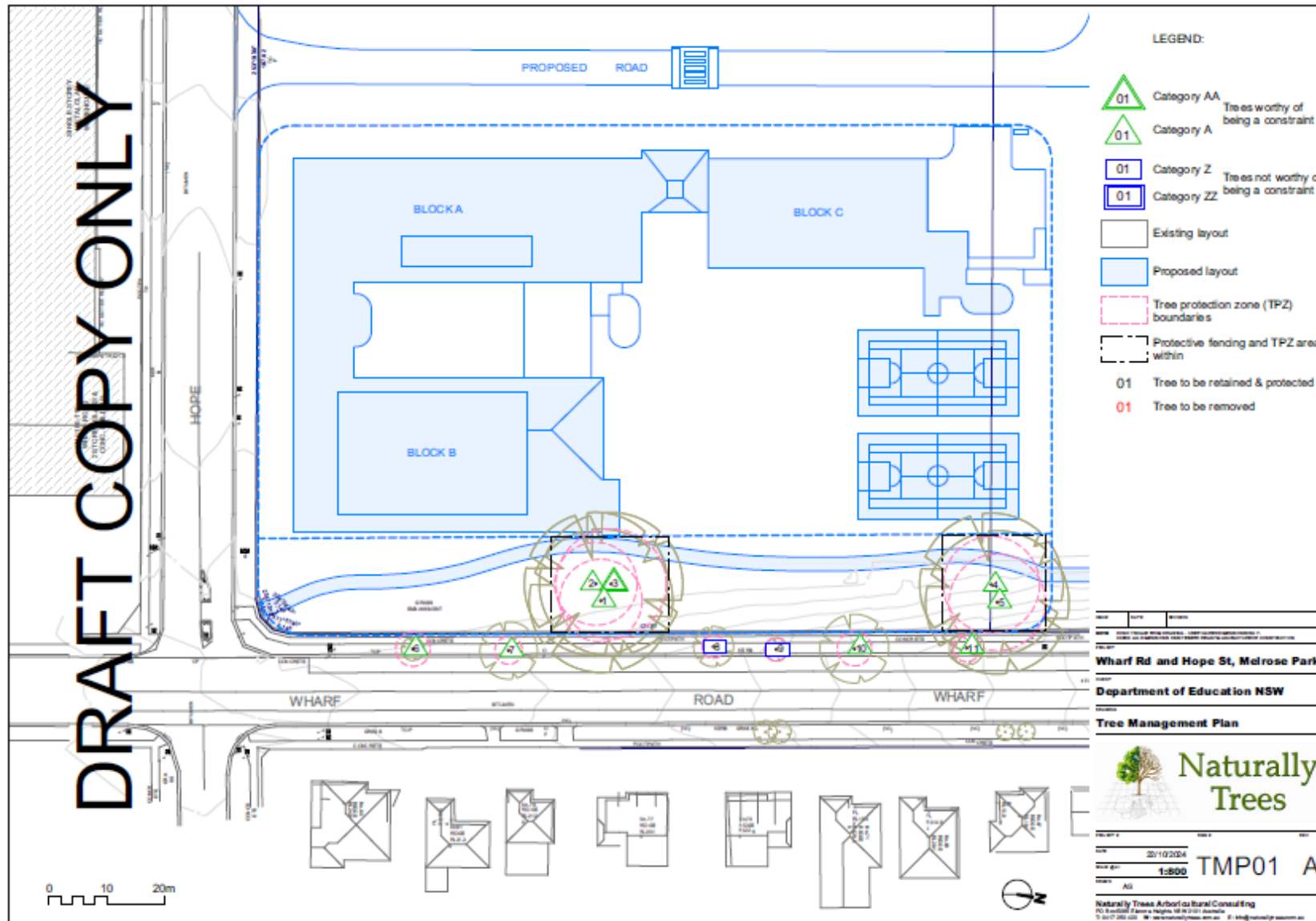

Figure 9-3 Draft Copy Tree Plan courtesy of Naturally Trees



9.1.5 Mitigation Measures

Measures that will be implemented to address potential pre-construction impacts are listed in Table 9-1 and construction impacts are listed in Table 9-2. Detailed tree mitigation measures during pre-construction and construction should be adhered to.

Table 9-1 Mitigation measures for pre-construction impacts (PI)

FFA	Mitigation Measure	Timing
PI1	Tree protection must be approved by a Consulting Arborist AQF Level 5. No materials, mixing, parking, disposal, repairs, refuelling, fires, stockpiling, or backfilling is allowed near remaining trees. Removal or lopping of trees needs written permission from the Superintendent.	Pre-construction
PI2	All trees to be protected shall be clearly identified and all TPZs surveyed.	Pre-construction
PI3	Protective fencing around existing trees and within TPZs must be installed before any site work begins. The fence must be 1800mm high chain wire mesh fixed to Galvanised steel posts, enclosing an area to prevent damage as defined in the Tree Protection Plan. No storage inside fenced area.	Pre-construction
PI4	Use AS 4454 leaf mulch with 90% recycled content for tree protection fencing. Chip trees marked for removal and use mulch 100mm deep. Avoid soil, weeds, sticks, and stones. Comply with AS 4454 (1999) and AS 4419 (1998).	Pre-construction
PI5	Tree protection signage must be attached to tree protection zones before works begin. Signs should be displayed prominently and repeated at 10m intervals or closer when the fence changes direction. Signs must include information about the tree protection zone, access restrictions, developer's contact details, and Site Arborist information.	Pre-construction
PI6	Outline protocols for any necessary pruning or removal of trees. All tree works must be performed by qualified tree workers (minimum AQF Level 2) under the supervision of the Consulting Arborist, adhering to the NSW Workcover Code of Practice for the Amenity Tree Industry (1998).	Pre-construction
PI7	Induction of all contractors and staff outlining the ecological sensitivity of the site, no-go areas, the need to minimise ecological impact, and all other required mitigation measures is to be undertaken.	Pre-construction
PI19	An Erosion and Sediment Control Plan will be prepared.	Pre-construction
PI20	Property boundaries, existing levels of the land in relation to the building, roads, and where stormwater surface flows enter and leave the site.	Pre-construction
PI21	The location of stabilised construction access points.	Pre-construction
PI22	The location of perimeter sediment/erosion controls.	Pre-construction
PI23	Any 'no-go' areas that are not to be disturbed.	Pre-construction
PI24	The location of stockpile areas.	Pre-construction
PI25	The location of proposed temporary and permanent site drainage.	Pre-construction
PI26	Specific measures to prevent pollution of stormwater off the site, such as sediment fences, sediment basins, and stabilised access points.	Pre-construction



Table 9-2 Mitigation measures for construction impacts (CI)

FFA	Mitigation Measure	Timing
C11	Tree Protection Zones (TPZs) will be maintained around vegetation to be retained. TPZs will be maintained in accordance with Australian Standard 4970 (2009) Protection of Trees on Development Sites (AS-4970). No activities are to take place within the Structural Root Zones (SRZs) of mature trees. No works, stockpiling of materials, excavation, parking or any other potentially harmful activities will be undertaken within TPZs unless a Level 5 Arborist has provided confirmation that the works will not impact the tree.	Construction
C12	No pedestrian or plant access is permissible to the TPZ.	Construction
C13	Avoid storing bulk or harmful materials near trees. Keep spoil from excavations away from TPZs. Ensure wind-blown materials like cement don't harm trees. Contaminants stored properly with spill measures.	Construction
C14	Protect the trees from harm. Avoid tying ropes, cables, or similar items to trees. No staff members. No plant, machinery, or materials can enter the tree protection fencing.	Construction
C15	Do not fill or compact soil above tree roots enclosed by protection fencing during construction near trees. Guidelines must be followed to prevent soil compaction in these areas. Protection includes using elevated planks attached to scaffolding to prevent ground compression.	Construction
C16	Trenching is not allowed in TPZs or tree protection fencing. Approval needed for trenching, must be done by hand with arborist supervision.	Construction
C17	Contractors are to maintain plants are watered. Apply water at an appropriate rate suitable for the plant species during periods of little or no rainfall.	Construction
C18	All site facilities must be located outside of TPZ. Chemicals and contaminants must be stored properly in an enclosed area with a spill bund to prevent runoff in case of accidents.	Construction
C19	Basic hygiene protocols would be implemented for construction personnel and machinery on site to reduce the potential for invasion by plant pathogens including <i>Phytophthora cinnamomi</i> , the fungus myrtle rust <i>Uredo rangelli</i> and amphibian chytrid fungus.	Construction
C110	The Consulting Arborist will conduct regular site inspections to monitor the health and stability of retained trees, ensuring compliance with the TMP. Any signs of stress or damage will be promptly addressed with appropriate remedial actions.	Construction
C11	Upon completion of the construction activities, conduct a final health assessment of all retained trees to document any changes in condition. The Consulting Arborist will provide a detailed report with recommendations for any ongoing care or additional mitigation measures needed to support the long-term health of the trees.	Construction
C12	An Erosion and Sediment Control Plan will be prepared.	Construction
C13	Property boundaries, existing levels of the land in relation to the building, roads, and where stormwater surface flows enter and leave the site.	Construction
C14	The location of stabilised construction access points.	Construction
C15	The location of perimeter sediment/erosion controls.	Construction
C16	The location of proposed temporary and permanent site drainage.	Construction
C17	Specific measures to prevent pollution of stormwater off the site, such as sediment fences, sediment basins, and stabilised access points.	Construction



10 CONCLUSION AND RECOMMENDATIONS

Subject to implementing the recommendations/mitigation measures set out below and in Section 9.1.5 of this report, the conclusion of this assessment is that the proposed Activity is not likely to significantly affect the environment in relation to ecological matters.

There are no trees within the site; however, trees along the site boundary may extend into the area, with their drip lines encroaching on the site. As a precautionary measure, potential impacts on these trees should be considered. Activities within the tree TPZs will require precautions to avoid damage, with a qualified arborist overseeing the process and providing a Tree Protection Plan. Contractors and staff will be inducted on the site's ecological sensitivity, and basic hygiene protocols will be implemented to prevent plant pathogens and fungi.

If these mitigation measures are followed, the ecological impact of the construction can be minimised, ensuring the protection of the remaining trees and local wildlife.

This FFA for the Melrose Park High School has assessed the potential environmental impacts of the proposed activity. The assessment, conducted by Water Technology, found no significant biodiversity areas or threatened species on the site that cannot be mitigated. Consequently, the project will not cause significant environmental impacts, and no further referral or Environmental Impact Statement is required. This conclusion supports the progression of the redevelopment project under the current planning and environmental regulations, ensuring that the school infrastructure can proceed with minimal biodiversity disruption.

Please refer below to the mitigation measures, Table 10-1.

Table 10-1 Project Stage Design (D) Construction (C) Operation (O)

Project Stage	Mitigation Measures	Relevant Section of Report
C	Outline protocols for any necessary pruning or removal of trees. All tree works must be performed by qualified tree workers (minimum AQF Level 2) under the supervision of the Consulting Arborist, adhering to the NSW Workcover Code of Practice for the Amenity Tree Industry (1998).	Section 9.1.5
C	Tree protection must be approved by a Consulting Arborist AQF Level 5. No materials, mixing, parking, disposal, repairs, refuelling, fires, stockpiling, or backfilling is allowed near remaining trees. Removal or lopping of trees needs written permission from the Superintendent.	Section 9.1.5
C	All trees to be protected shall be clearly identified and all TPZs surveyed.	Section 9.1.5
C	Protective fencing around existing trees and within TPZs must be installed before any site work begins. The fence must be 1800mm high chain wire mesh fixed to Galvanised steel posts, enclosing an area to prevent damage as defined in the Tree Protection Plan. No storage inside fenced area.	Section 9.1.5
C	Use AS 4454 leaf mulch with 90% recycled content for tree protection fencing. Chip trees marked for removal and use mulch 100mm deep. Avoid soil, weeds, sticks, and stones. Comply with AS 4454 (1999) and AS 4419 (1998).	Section 9.1.5



Project Stage	Mitigation Measures	Relevant Section of Report
C	Tree protection signage must be attached to tree protection zones before works begin. Signs should be displayed prominently and repeated at 10m intervals or closer when the fence changes direction. Signs must include information about the tree protection zone, access restrictions, developer's contact details, and Site Arborist information.	Section 9.1.5
C	Induction of all contractors and staff outlining the ecological sensitivity of the site, no-go areas, the need to minimise ecological impact, and all other required mitigation measures is to be undertaken.	Section 9.1.5
C	Tree Protection Zones (TPZs) will be maintained around vegetation to be retained. TPZs will be maintained in accordance with Australian Standard 4970 (2009) Protection of Trees on Development Sites (AS-4970). No activities are to take place within the Structural Root Zones (SRZs) of mature trees. No works, stockpiling of materials, excavation, parking or any other potentially harmful activities will be undertaken within TPZs unless a Level 5 Arborist has provided confirmation that the works will not impact the tree.	Section 9.1.5
C	No pedestrian or plant access is permissible to the TPZ.	Section 9.1.5
C	Avoid storing bulk or harmful materials near trees. Keep spoil from excavations away from TPZs. Ensure wind-blown materials like cement don't harm trees. Contaminants stored properly with spill measures.	Section 9.1.5
C	Protect the tree from harm. Avoid tying ropes, cables, or similar items to trees. No staff members. No plant, machinery, or materials can enter the tree protection fencing.	Section 9.1.5
C	Do not fill or compact soil above tree roots enclosed by protection fencing during construction near trees. Guidelines must be followed to prevent soil compaction in these areas. Protection includes using elevated planks attached to scaffolding to prevent ground compression.	Section 9.1.5
C	Trenching is not allowed in TPZs or tree protection fencing. Approval needed for trenching, must be done by hand with arborist supervision.	Section 9.1.5
C	All site facilities must be located outside of TPZ. Chemicals and contaminants must be stored properly in an enclosed area with a spill bund to prevent runoff in case of accidents.	Section 9.1.5
C	An Erosion and Sediment Control Plan to be prepared to inform the REF. This plan includes detailed information on property boundaries, existing land levels in relation to the building and roads, and the locations where stormwater surface flows enter and exit the site. It also identifies stabilised construction access points, perimeter sediment and erosion controls, and any designated 'no-go' areas that are not to be disturbed	Section 9.1.5
C	Locations of stockpile areas and proposed temporary and permanent site drainage systems.	Section 9.1.5
C	To prevent stormwater pollution off-site, specific measures such as sediment fences, sediment basins, and stabilised access points have been included. This plan will be implemented during pre-construction and construction phases.	Section 9.1.5



11 REFERENCES

- Naturally Trees. (2024). DRAFT Dept. of Education NSW_Melrose Park High School_Arborist Report - Rev A [Arborist Report]. Naturally Trees Arboricultural Consulting.
- DAWE (2023) EPBC Protected Matters Search Tool [Online tool] Accessed 7 November 2024. Available at: <https://pmst.awe.gov.au/#/map?lng=131.52832031250003&lat=-28.6905876542507&zoom=5&baseLayers=Imagery>
- Department of Environment, Climate Change and Water NSW (2009) Commonwealth Advice -. [Online]. Accessed 7 November 2024. Available at: <https://www.environment.gov.au/biodiversity/threatened/communities/pubs/112-listing-advice.pdf>
- Department of Environment, Climate Change and Water NSW (2010b). Sydney Growth Centres Strategic Assessment Program Report. Department of Environment, Climate Change and Water NSW, Sydney.
- Ecological Australia. (2023). New Liverpool High School Biodiversity Development Assessment Report. CBRE on behalf of Schools Infrastructure NSW.
- MetroMap (2023) Spatial satellite imagery dated 05/05/2022. [Online tool] Accessed 7 November 2024. Available at: https://web.metromap.com.au/map?lat=33.41671080587806&lng=149.6053356300763&z=17.459764213268205&layer_id=310
- MetroMap (2023) Spatial satellite imagery. [Online tool] Accessed 7 November 2024. Available at: https://web.metromap.com.au/map?lat=-33.41671080587806&lng=149.6053356300763&z=17.459764213268205&layer_id=310
- NSW DPE (2023) Biodiversity Values Map [Online tool] Accessed 7 November 2024. Available at: <https://www.lmbc.nsw.gov.au/Maps/index.html?viewer=BOSETMap>
- NSW DPE (2023) NSW Planning Portal. [Online tool] Accessed 7 November 2024. Available at: <https://www.planningportal.nsw.gov.au/spatialviewer/#/find-a-property/address>
- NSW DPE (2023) State Vegetation Type Map [Online tool] Accessed 7 November 2024. Available at: <https://datasets.seed.nsw.gov.au/dataset/nsw-state-vegetation-type-map>
- NSW DPE (Department of Planning and Environment) (2022) Register of biodiversity certification orders. [Online] Accessed 7 November 2024. Available at: <https://www.environment.nsw.gov.au/topics/animals-and-plants/biodiversity-offsets-scheme/about-the-biodiversity-offsets-scheme/biodiversity-certification/biodiversity-certification-orders>
- NSW DPI (2023) Key Fish Habitat Mapping [Online tool] Accessed 7 November 2024. Available at: https://webmap.industry.nsw.gov.au/Html5Viewer/index.html?viewer=Fisheries_Data_Portal
- NSW OEH (2023) BioNet Atlas of NSW Wildlife [Online tool] Accessed 7 November 2024. Available at: https://www.environment.nsw.gov.au/atlaspublicapp/UI_Modules/ATLAS/_AtlasSearch.aspx
- NSW OEH (2023) BioNet Vegetation Classification [Online tool] Accessed 7 November 2024. Available at: <https://www.environment.nsw.gov.au/NSWVCA20PRapp/LoginPR.aspx>
- NSW OEH (2023) NSW eSpade [Online tool] Accessed 7 November 2024. Available at: <https://www.environment.nsw.gov.au/eSpade2Webapp/>
- NSW OEH (2023) Threatened biodiversity profile search [Online tool] Accessed 7 November 2024. Available at: <https://www.environment.nsw.gov.au/threatenedspeciesapp/>
- NSW Sixmaps (2022) Spatial area tool. [Online tool] Accessed 7 November 2024. Available at: <https://maps.six.nsw.gov.au/>
- NSW Sixmaps (2023) Spatial area tool . [Online tool] Accessed 7 November 2024. Available at: <https://maps.six.nsw.gov.au/>

APPENDIX A PROTECTED MATTERS SEARCH

23050121_Biodiversity DD-Melrose Park HS-WT-DDWO05306-23_FFA



Australian Government

Department of Climate Change, Energy,
the Environment and Water

EPBC Act Protected Matters Report

This report provides general guidance on matters of national environmental significance and other matters protected by the EPBC Act in the area you have selected. Please see the caveat for interpretation of information provided here.

Report created: 23-Sep-2024

[Summary](#)

[Details](#)

[Matters of NES](#)

[Other Matters Protected by the EPBC Act](#)

[Extra Information](#)

[Caveat](#)

[Acknowledgements](#)

Summary

Matters of National Environment Significance

This part of the report summarises the matters of national environmental significance that may occur in, or may relate to, the area you nominated. Further information is available in the detail part of the report, which can be accessed by scrolling or following the links below. If you are proposing to undertake an activity that may have a significant impact on one or more matters of national environmental significance then you should consider the [Administrative Guidelines on Significance](#).

World Heritage Properties:	None
National Heritage Places:	None
Wetlands of International Importance (Ramsar	None
Great Barrier Reef Marine Park:	None
Commonwealth Marine Area:	None
Listed Threatened Ecological Communities:	12
Listed Threatened Species:	104
Listed Migratory Species:	42

Other Matters Protected by the EPBC Act

This part of the report summarises other matters protected under the Act that may relate to the area you nominated. Approval may be required for a proposed activity that significantly affects the environment on Commonwealth land, when the action is outside the Commonwealth land, or the environment anywhere when the action is taken on Commonwealth land. Approval may also be required for the Commonwealth or Commonwealth agencies proposing to take an action that is likely to have a significant impact on the environment anywhere.

The EPBC Act protects the environment on Commonwealth land, the environment from the actions taken on Commonwealth land, and the environment from actions taken by Commonwealth agencies. As heritage values of a place are part of the 'environment', these aspects of the EPBC Act protect the Commonwealth Heritage values of a Commonwealth Heritage place. Information on the new heritage laws can be found at <https://www.dcceew.gov.au/parks-heritage/heritage>

A [permit](#) may be required for activities in or on a Commonwealth area that may affect a member of a listed threatened species or ecological community, a member of a listed migratory species, whales and other cetaceans, or a member of a listed marine species.

Commonwealth Lands:	1021
Commonwealth Heritage Places:	5
Listed Marine Species:	51
Whales and Other Cetaceans:	None
Critical Habitats:	None
Commonwealth Reserves Terrestrial:	None
Australian Marine Parks:	None
Habitat Critical to the Survival of Marine Turtles:	None

Extra Information

This part of the report provides information that may also be relevant to the area you have

State and Territory Reserves:	4
Regional Forest Agreements:	None
Nationally Important Wetlands:	2
EPBC Act Referrals:	62
Key Ecological Features (Marine):	None
Biologically Important Areas:	None
Bioregional Assessments:	1
Geological and Bioregional Assessments:	None

Details

Matters of National Environmental Significance

Listed Threatened Ecological Communities

[Resource Information]

For threatened ecological communities where the distribution is well known, maps are derived from recovery plans, State vegetation maps, remote sensing imagery and other sources. Where threatened ecological community distributions are less well known, existing vegetation maps and point location data are used to produce indicative distribution maps.

Status of Vulnerable, Disallowed and Ineligible are not MNES under the EPBC Act.

Community Name	Threatened Category	Presence Text	Buffer Status
Castlereagh Scribbly Gum and Agnes Banks Woodlands of the Sydney Basin Bioregion	Endangered	Community likely to occur within area	In feature area
Coastal Swamp Oak (Casuarina glauca) Forest of New South Wales and South East Queensland ecological community	Endangered	Community likely to occur within area	In feature area
Coastal Swamp Sclerophyll Forest of New South Wales and South East Queensland	Endangered	Community likely to occur within area	In buffer area only
Coastal Upland Swamps in the Sydney Basin Bioregion	Endangered	Community likely to occur within area	In buffer area only
Cooks River/Castlereagh Ironbark Forest of the Sydney Basin Bioregion	Critically Endangered	Community likely to occur within area	In feature area
Cumberland Plain Shale Woodlands and Shale-Gravel Transition Forest	Critically Endangered	Community likely to occur within area	In buffer area only
River-flat eucalypt forest on coastal floodplains of southern New South Wales and eastern Victoria	Critically Endangered	Community likely to occur within area	In feature area
Shale Sandstone Transition Forest of the Sydney Basin Bioregion	Critically Endangered	Community likely to occur within area	In buffer area only
Subtropical and Temperate Coastal Saltmarsh	Vulnerable	Community likely to occur within area	In buffer area only
Turpentine-Ironbark Forest of the Sydney Basin Bioregion	Critically Endangered	Community likely to occur within area	In buffer area only
Upland Basalt Eucalypt Forests of the Sydney Basin Bioregion	Endangered	Community may occur	In buffer area only within area
Western Sydney Dry Rainforest and Moist Woodland on Shale	Critically Endangered	Community likely to occur within area	In feature area

Listed Threatened Species

[Resource Information]

Status of Conservation Dependent and Extinct are not MNES under the EPBC Act.
Number is the current name ID.

Scientific Name	Threatened Category	Presence Text	Buffer Status
BIRD			
Anthochaera phrygia Regent Honeyeater [82338]	Critically Endangered	Species or species habitat known to occur within area	In feature area
Aphelocephala leucopsis Southern Whiteface [529]	Vulnerable	Species or species habitat may occur within area	In feature area
Ardenna grisea Sooty Shearwater [82651]	Vulnerable	Species or species habitat likely to occur within area	In buffer area only
Botaurus poiciloptilus Australasian Bittern [1001]	Endangered	Species or species habitat known to occur within area	In feature area
Calidris acuminata Sharp-tailed Sandpiper [874]	Vulnerable	Species or species habitat known to occur within area	In feature area
Calidris canutus Red Knot, Knot [855]	Vulnerable	Species or species habitat may occur within area	In buffer area only
Calidris ferruginea Curlew Sandpiper [856]	Critically Endangered	Species or species habitat likely to occur within area	In feature area
Callocephalon fimbriatum Gang-gang Cockatoo [768]	Endangered	Species or species habitat known to occur within area	In feature area
Calyptorhynchus lathami lathami South-eastern Glossy Black-Cockatoo [67036]	Vulnerable	Species or species habitat known to occur within area	In feature area
Charadrius leschenaultii Greater Sand Plover, Large Sand Plover [877]	Vulnerable	Species or species habitat may occur within area	In feature area

Scientific Name	Threatened Category	Presence Text	Buffer Status
Climacteris picumnus victoriae Brown Treecreeper (south-eastern) [67062]	Vulnerable	Species or species habitat likely to occur within area	In feature area
Dasyornis brachypterus Eastern Bristlebird [533]	Endangered	Species or species habitat may occur within area	In buffer area only
Diomedea antipodensis Antipodean Albatross [64458]	Vulnerable	Foraging, feeding or related behaviour likely to occur within area	In buffer area only
Diomedea antipodensis gibsoni Gibson's Albatross [82270]	Vulnerable	Foraging, feeding or related behaviour likely to occur within area	In buffer area only
Diomedea epomophora Southern Royal Albatross [89221]	Vulnerable	Foraging, feeding or related behaviour likely to occur within area	In buffer area only
Diomedea exulans Wandering Albatross [89223]	Vulnerable	Foraging, feeding or related behaviour likely to occur within area	In buffer area only
Diomedea sanfordi Northern Royal Albatross [64456]	Endangered	Species or species habitat may occur within area	In buffer area only
Erythroriorchis radiatus Red Goshawk [942]	Endangered	Species or species habitat may occur within area	In feature area
Falco hypoleucos Grey Falcon [929]	Vulnerable	Species or species habitat likely to occur within area	In feature area
Gallinago hardwickii Latham's Snipe, Japanese Snipe [863]	Vulnerable	Species or species habitat known to occur within area	In feature area

Scientific Name	Threatened Category	Presence Text	Buffer Status
Grantiella picta Painted Honeyeater [470]	Vulnerable	Species or species habitat likely to occur within area	In feature area
Hirundapus caudacutus White-throated Needletail [682]	Vulnerable	Species or species habitat known to occur within area	In feature area
Lathamus discolor Swift Parrot [744]	Critically Endangered	Species or species habitat known to occur within area	In feature area
Limosa lapponica baueri Nunivak Bar-tailed Godwit, Western Alaskan Bar-tailed Godwit [86380]	Endangered	Species or species habitat likely to occur within area	In buffer area only
Macronectes giganteus Southern Giant-Petrel, Southern Giant Petrel [1060]	Endangered	Species or species habitat may occur within area	In buffer area only
Macronectes halli Northern Giant Petrel [1061]	Vulnerable	Foraging, feeding or related behaviour likely to occur within area	In buffer area only
Melanodryas cucullata cucullata South-eastern Hooded Robin, Hooded Robin (south-eastern) [67093]	Endangered	Species or species habitat likely to occur within area	In feature area
Neophema chrysogaster Orange-bellied Parrot [747]	Critically Endangered	Species or species habitat may occur within area	In buffer area only
Neophema chrysostoma Blue-winged Parrot [726]	Vulnerable	Species or species habitat may occur within area	In feature area
Numenius madagascariensis Eastern Curlew, Far Eastern Curlew [847]	Critically Endangered	Species or species habitat likely to occur within area	In feature area
Pachyptila turtur subantarctica Fairy Prion (southern) [64445]	Vulnerable	Species or species habitat known to occur within area	In buffer area only

Scientific Name	Threatened Category	Presence Text	Buffer Status
Pycnoptilus floccosus Pilotbird [525]	Vulnerable	Species or species habitat likely to occur within area	In feature area
Rostratula australis Australian Painted Snipe [77037]	Endangered	Species or species habitat known to occur within area	In feature area
Stagonopleura guttata Diamond Firetail [59398]	Vulnerable	Species or species habitat likely to occur within area	In feature area
Sternula nereis nereis Australian Fairy Tern [82950]	Vulnerable	Species or species habitat may occur within area	In buffer area only
Thalassarche bulleri Buller's Albatross, Pacific Albatross [64460]	Vulnerable	Species or species habitat may occur within area	In buffer area only
Thalassarche bulleri platei Northern Buller's Albatross, Pacific Albatross [82273]	Vulnerable	Species or species habitat may occur within area	In buffer area only
Thalassarche cauta Shy Albatross [89224]	Endangered	Foraging, feeding or related behaviour likely to occur within area	In buffer area only
Thalassarche eremita Chatham Albatross [64457]	Endangered	Foraging, feeding or related behaviour may occur within area	In buffer area only
Thalassarche impavida Campbell Albatross, Campbell Black-browed Albatross [64459]	Vulnerable	Species or species habitat may occur within area	In buffer area only
Thalassarche melanophris Black-browed Albatross [66472]	Vulnerable	Foraging, feeding or related behaviour likely to occur within area	In buffer area only

Scientific Name	Threatened Category	Presence Text	Buffer Status
Thalassarche salvini Salvin's Albatross [64463]	Vulnerable	Foraging, feeding or related behaviour likely to occur within area	In buffer area only
Thalassarche steadi White-capped Albatross [64462]	Vulnerable	Foraging, feeding or related behaviour known to occur within area	In buffer area only
Tringa nebularia Common Greenshank, Greenshank [832]	Endangered	Species or species habitat likely to occur within area	In feature area
FISH			
Epinephelus daemeli Black Rockcod, Black Cod, Saddled Rockcod [68449]	Vulnerable	Species or species habitat likely to occur within area	In buffer area only
Macquaria australasica Macquarie Perch [66632]	Endangered	Species or species habitat known to occur within area	In feature area
Prototroctes maraena Australian Grayling [26179]	Vulnerable	Species or species habitat may occur within area	In buffer area only
FROG			
Heleioporus australiacus Giant Burrowing Frog [1973]	Vulnerable	Species or species habitat likely to occur within area	In buffer area only
Litoria aurea Green and Golden Bell Frog [1870]	Vulnerable	Species or species habitat known to occur within area	In feature area
Mixophyes balbus Stuttering Frog, Southern Barred Frog (in Victoria) [1942]	Vulnerable	Species or species habitat may occur within area	In buffer area only
INSECT			
Austrocordulia leonardi Sydney Hawk Dragonfly [84741]	Endangered	Species or species habitat may occur within area	In buffer area only
MAMMAL			

Scientific Name	Threatened Category	Presence Text	Buffer Status
Chalinolobus dwyeri Large-eared Pied Bat, Large Pied Bat [183]	Endangered	Species or species habitat known to occur within area	In feature area
Dasyurus maculatus maculatus (SE mainland population) Spot-tailed Quoll, Spotted-tail Quoll, Tiger Quoll (southeastern mainland population) [75184]	Endangered	Species or species habitat known to occur within area	In feature area
Isoodon obesulus obesulus Southern Brown Bandicoot (eastern), Southern Brown Bandicoot (south-eastern) [68050]	Endangered	Species or species habitat may occur within area	In buffer area only
Notamacropus parma Parma Wallaby [89289]	Vulnerable	Species or species habitat may occur within area	In buffer area only
Petauroides volans Greater Glider (southern and central) [254]	Endangered	Species or species habitat likely to occur within area	In feature area
Petaurus australis australis Yellow-bellied Glider (south-eastern) [87600]	Vulnerable	Species or species habitat likely to occur within area	In feature area
Petrogale penicillata Brush-tailed Rock-wallaby [225]	Vulnerable	Species or species habitat may occur within area	In buffer area only
Phascolarctos cinereus (combined populations of Qld, NSW and the ACT) Koala (combined populations of Queensland, New South Wales and the Australian Capital Territory) [85104]	Endangered	Species or species habitat known to occur within area	In feature area
Pseudomys novaehollandiae New Holland Mouse, Pookila [96]	Vulnerable	Species or species habitat known to occur within area	In feature area
Pteropus poliocephalus Grey-headed Flying-fox [186]	Vulnerable	Roosting known to occur within area	In feature area
PLANT			
Acacia baueri subsp. aspera [18662]	Endangered	Species or species habitat may occur within area	In buffer area only

Scientific Name	Threatened Category	Presence Text	Buffer Status
Acacia bynoeana Bynoe's Wattle, Tiny Wattle [8575]	Vulnerable	Species or species habitat may occur within area	In feature area
Acacia pubescens Downy Wattle, Hairy Stemmed Wattle [18800]	Vulnerable	Species or species habitat known to occur within area	In feature area
Acacia terminalis subsp. Eastern Sydney (G.P.Phillips 126) listed as Acacia terminalis subsp. terminalis MS			
Sunshine Wattle (Sydney region) [91564]	Endangered	Species or species habitat may occur within area	In buffer area only
Allocasuarina glareicola [21932]	Endangered	Species or species habitat known to occur within area	In feature area
Caladenia tessellata Thick-lipped Spider-orchid, Daddy Long-legs [2119]	Vulnerable	Species or species habitat likely to occur within area	In buffer area only
Cryptostylis hunteriana Leafless Tongue-orchid [19533]	Vulnerable	Species or species habitat likely to occur within area	In feature area
Cynanchum elegans White-flowered Wax Plant [12533]	Endangered	Species or species habitat known to occur within area	In buffer area only
Darwinia biflora [14619]	Vulnerable	Species or species habitat may occur within area	In buffer area only
Deyeuxia appressa [7438]	Endangered	Species or species habitat likely to occur within area	In buffer area only
Eucalyptus camfieldii Camfield's Stringybark [15460]	Vulnerable	Species or species habitat known to occur within area	In buffer area only
Genoplesium baueri Yellow Gnat-orchid, Bauer's Midge Orchid, Brittle Midge Orchid [7528]	Endangered	Species or species habitat likely to occur within area	In feature area

Scientific Name	Threatened Category	Presence Text	Buffer Status
Grevillea parviflora subsp. parviflora Small-flower Grevillea [64910]	Vulnerable	Species or species habitat known to occur within area	In feature area
Haloragis exalata subsp. exalata Wingless Raspwort, Square Raspwort [24636]	Vulnerable	Species or species habitat may occur within area	In buffer area only
Hibbertia puberula subsp. glabrescens [86645]	Critically Endangered	Species or species habitat known to occur within area	In buffer area only
Leucopogon exolasius Woronora Beard-heath [14251]	Vulnerable	Species or species habitat known to occur within area	In feature area
Melaleuca biconvexa Biconvex Paperbark [5583]	Vulnerable	Species or species habitat may occur within area	In buffer area only
Melaleuca deanei Deane's Melaleuca [5818]	Vulnerable	Species or species habitat known to occur within area	In buffer area only
Persicaria elatior Knotweed, Tall Knotweed [5831]	Vulnerable	Species or species habitat likely to occur within area	In feature area
Persoonia hirsuta Hairy Geebung, Hairy Persoonia [19006]	Endangered	Species or species habitat known to occur within area	In buffer area only
Persoonia nutans Nodding Geebung [18119]	Endangered	Species or species habitat known to occur within area	In feature area
Pimelea curviflora var. curviflora [4182]	Vulnerable	Species or species habitat likely to occur within area	In buffer area only
Pimelea spicata Spiked Rice-flower [20834]	Endangered	Species or species habitat known to occur within area	In feature area

Scientific Name	Threatened Category	Presence Text	Buffer Status
Pomaderris brunnea Rufous Pomaderris, Brown Pomaderris [16845]	Vulnerable	Species or species habitat known to occur within area	In feature area
Pterostylis gibbosa Illawarra Greenhood, Rufa Greenhood, Pouched Greenhood [4562]	Endangered	Species or species habitat may occur within area	In buffer area only
Pterostylis saxicola Sydney Plains Greenhood [64537]	Endangered	Species or species habitat known to occur within area	In feature area
Pultenaea aristata [18062]	Vulnerable	Species or species habitat known to occur within area	In buffer area only
Pultenaea parviflora [19380]	Vulnerable	Species or species habitat may occur within area	In buffer area only
Rhizanthella slateri Eastern Underground Orchid [11768]	Endangered	Species or species habitat may occur within area	In buffer area only
Rhodamnia rubescens Scrub Turpentine, Brown Malletwood [15763]	Critically Endangered	Species or species habitat known to occur within area	In feature area
Rhodomyrtus psidioides Native Guava [19162]	Critically Endangered	Species or species habitat may occur within area	In feature area
Syzygium paniculatum Magenta Lilly Pilly, Magenta Cherry, Daguba, Scrub Cherry, Creek Lilly Pilly, Brush Cherry [20307]	Vulnerable	Species or species habitat likely to occur within area	In feature area
Thelymitra kangaloonica Kangaloon Sun Orchid [81861]	Critically Endangered	Species or species habitat may occur within area	In buffer area only
Thesium australe Austral Toadflax, Toadflax [15202]	Vulnerable	Species or species habitat may occur within area	In feature area

REPTILE

Scientific Name	Threatened Category	Presence Text	Buffer Status
Aprasia parapulchella Pink-tailed Worm-lizard, Pink-tailed Legless Lizard [1665]	Vulnerable	Species or species habitat may occur within area	In buffer area only
Caretta caretta Loggerhead Turtle [1763]	Endangered	Species or species habitat likely to occur within area	In buffer area only
Chelonia mydas Green Turtle [1765]	Vulnerable	Species or species habitat known to occur within area	In buffer area only
Dermochelys coriacea Leatherback Turtle, Leathery Turtle, Luth [1768]	Endangered	Species or species habitat known to occur within area	In buffer area only
Eretmochelys imbricata Hawksbill Turtle [1766]	Vulnerable	Species or species habitat known to occur within area	In buffer area only
Hoplocephalus bungaroides Broad-headed Snake [1182]	Endangered	Species or species habitat likely to occur within area	In buffer area only
Natator depressus Flatback Turtle [59257]	Vulnerable	Species or species habitat known to occur within area	In buffer area only
SHARK			
Sphyrna lewini Scalloped Hammerhead [85267]	Conservation Dependent	Species or species habitat likely to occur within area	In buffer area only
SNAIL			
Pommerhelix duralensis Dural Land Snail [85268]	Endangered	Species or species habitat likely to occur within area	In buffer area only
Listed Migratory Species [Resource Information]			
Scientific Name	Threatened Category	Presence Text	Buffer Status
Migratory Marine Birds			
Apus pacificus Fork-tailed Swift [678]		Species or species habitat likely to occur within area	In feature area

Scientific Name	Threatened Category	Presence Text	Buffer Status
Ardenna grisea Sooty Shearwater [82651]	Vulnerable	Species or species habitat likely to occur within area	In buffer area only
Diomedea antipodensis Antipodean Albatross [64458]	Vulnerable	Foraging, feeding or related behaviour likely to occur within area	In buffer area only
Diomedea epomophora Southern Royal Albatross [89221]	Vulnerable	Foraging, feeding or related behaviour likely to occur within area	In buffer area only
Diomedea exulans Wandering Albatross [89223]	Vulnerable	Foraging, feeding or related behaviour likely to occur within area	In buffer area only
Diomedea sanfordi Northern Royal Albatross [64456]	Endangered	Species or species habitat may occur within area	In buffer area only
Macronectes giganteus Southern Giant-Petrel, Southern Giant Petrel [1060]	Endangered	Species or species habitat may occur within area	In buffer area only
Macronectes halli Northern Giant Petrel [1061]	Vulnerable	Foraging, feeding or related behaviour likely to occur within area	In buffer area only
Phaethon lepturus White-tailed Tropicbird [1014]		Species or species habitat may occur within area	In buffer area only
Thalassarche bulleri Buller's Albatross, Pacific Albatross [64460]	Vulnerable	Species or species habitat may occur within area	In buffer area only
Thalassarche cauta Shy Albatross [89224]	Endangered	Foraging, feeding or related behaviour likely to occur within area	In buffer area only

Scientific Name	Threatened Category	Presence Text	Buffer Status
Thalassarche eremita Chatham Albatross [64457]	Endangered	Foraging, feeding or related behaviour may occur within area	In buffer area only
Thalassarche impavida Campbell Albatross, Campbell Black-browed Albatross [64459]	Vulnerable	Species or species habitat may occur within area	In buffer area only
Thalassarche melanophris Black-browed Albatross [66472]	Vulnerable	Foraging, feeding or related behaviour likely to occur within area	In buffer area only
Thalassarche salvini Salvin's Albatross [64463]	Vulnerable	Foraging, feeding or related behaviour likely to occur within area	In buffer area only
Thalassarche steadi White-capped Albatross [64462]	Vulnerable	Foraging, feeding or related behaviour known to occur within area	In buffer area only
Migratory Marine Species			
Caretta caretta Loggerhead Turtle [1763]	Endangered	Species or species habitat likely to occur within area	In buffer area only
Chelonia mydas Green Turtle [1765]	Vulnerable	Species or species habitat known to occur within area	In buffer area only
Dermochelys coriacea Leatherback Turtle, Leathery Turtle, Luth [1768]	Endangered	Species or species habitat known to occur within area	In buffer area only
Eretmochelys imbricata Hawksbill Turtle [1766]	Vulnerable	Species or species habitat known to occur within area	In buffer area only
Lamna nasus Porbeagle, Mackerel Shark [83288]		Species or species habitat likely to occur within area	In buffer area only

Scientific Name	Threatened Category	Presence Text	Buffer Status
Mobula alfredi as Manta alfredi Reef Manta Ray, Coastal Manta Ray [90033]		Species or species habitat may occur within area	In buffer area only
Mobula birostris as Manta birostris Giant Manta Ray [90034]		Species or species habitat may occur within area	In buffer area only
Natator depressus Flatback Turtle [59257]		Vulnerable	Species or species habitat known to occur within area
Migratory Terrestrial Species			
Cuculus optatus Oriental Cuckoo, Horsfield's Cuckoo [86651]	Vulnerable	Species or species habitat may occur within area	In feature area
Hirundapus caudacutus White-throated Needletail [682]		Species or species habitat known to occur within area	In feature area
Monarcha melanopsis Black-faced Monarch [609]		Species or species habitat known to occur within area	In feature area
Motacilla flava Yellow Wagtail [644]		Species or species habitat likely to occur within area	In feature area
Myiagra cyanoleuca Satin Flycatcher [612]		Species or species habitat known to occur within area	In feature area
Rhipidura rufifrons Rufous Fantail [592]		Species or species habitat known to occur within area	In feature area
Symposiachrus trivirgatus as Monarcha trivirgatus Spectacled Monarch [83946]		Species or species habitat may occur within area	In buffer area only
Migratory Wetlands Species			
Actitis hypoleucos Common Sandpiper [59309]		Species or species habitat known to occur within area	In feature area

Scientific Name	Threatened Category	Presence Text	Buffer Status
Calidris acuminata Sharp-tailed Sandpiper [874]	Vulnerable	Species or species habitat known to occur within area	In feature area
Calidris canutus Red Knot, Knot [855]	Vulnerable	Species or species habitat may occur within area	In buffer area only
Calidris ferruginea Curlew Sandpiper [856]	Critically Endangered	Species or species habitat likely to occur within area	In feature area
Calidris melanotos Pectoral Sandpiper [858]		Species or species habitat known to occur within area	In feature area
Charadrius leschenaultii Greater Sand Plover, Large Sand Plover [877]	Vulnerable	Species or species habitat may occur within area	In feature area
Gallinago hardwickii Latham's Snipe, Japanese Snipe [863]	Vulnerable	Species or species habitat known to occur within area	In feature area
Limosa lapponica Bar-tailed Godwit [844]		Species or species habitat likely to occur within area	In buffer area only
Numenius madagascariensis Eastern Curlew, Far Eastern Curlew [847]	Critically Endangered	Species or species habitat likely to occur within area	In feature area
Pandion haliaetus Osprey [952]		Species or species habitat known to occur within area	In feature area
Tringa nebularia Common Greenshank, Greenshank [832]	Endangered	Species or species habitat likely to occur within area	In feature area

Other Matters Protected by the EPBC Act

Commonwealth Lands [\[Resource Information \]](#)

The Commonwealth area listed below may indicate the presence of Commonwealth land in this vicinity. Due to the unreliability of the data source, all proposals should be checked as to whether it impacts on a Commonwealth area, before making a definitive decision. Contact the State or Territory government land department for further information.

Commonwealth Land Name	State	Buffer Status
Australian Wool Testing Authority Limited		
Commonwealth Land - Australian Wool Testing Authority Limited [14537]	NSW	In buffer area only

Commonwealth Trading Bank of Australia		
Commonwealth Land - Commonwealth Trading Bank of Australia [14503]	NSW	In buffer area only
Commonwealth Land - Commonwealth Trading Bank of Australia [13347]	NSW	In buffer area only
Commonwealth Land - Commonwealth Trading Bank of Australia [13346]	NSW	In buffer area only

Communications, Information Technology and the Arts - Australian Postal Corporation		
Commonwealth Land - Australian Postal Commission [14504]	NSW	In buffer area only
Commonwealth Land - Australian Postal Commission [13864]	NSW	In buffer area only
Commonwealth Land - Australian Postal Commission [14426]	NSW	In buffer area only
Commonwealth Land - Australian Postal Commission [13350]	NSW	In buffer area only
Commonwealth Land - Australian Postal Commission [13845]	NSW	In buffer area only
Commonwealth Land - Australian Postal Commission [14495]	NSW	In buffer area only
Commonwealth Land - Australian Postal Corporation [14602]	NSW	In buffer area only

Communications, Information Technology and the Arts - Telstra Corporation Limited		
Commonwealth Land - Australian Telecommunications Commission [13883]	NSW	In buffer area only
Commonwealth Land - Australian Telecommunications Commission [13882]	NSW	In buffer area only
Commonwealth Land - Australian Telecommunications Commission [14496]	NSW	In buffer area only
Commonwealth Land - Australian Telecommunications Commission [13342]	NSW	In buffer area only
Commonwealth Land - Australian Telecommunications Commission [13866]	NSW	In buffer area only
Commonwealth Land - Australian Telecommunications Commission [14428]	NSW	In buffer area only

Commonwealth Land Name	State	Buffer Status
Commonwealth Land - Australian Telecommunications Commission [14485]	NSW	In buffer area only
Commonwealth Land - Australian Telecommunications Commission [14484]	NSW	In buffer area only
Commonwealth Land - Australian Telecommunications Commission [13358]	NSW	In buffer area only
Commonwealth Land - Australian Telecommunications Commission [13455]	NSW	In buffer area only
Commonwealth Land - Australian Telecommunications Commission [14494]	NSW	In buffer area only
Commonwealth Land - Australian Telecommunications Corporation [13503]	NSW	In buffer area only
Commonwealth Land - Australian Telecommunications Corporation [14601]	NSW	In buffer area only
Commonwealth Land - Australian Telecommunications Corporation [13343]	NSW	In buffer area only
Commonwealth Land - Telstra Corporation Limited [15733]	NSW	In buffer area only
Commonwealth Land - Telstra Corporation Limited [13860]	NSW	In buffer area only
Commonwealth Land - Telstra Corporation Limited [15703]	NSW	In buffer area only
Commonwealth Land - Telstra Corporation Limited [14442]	NSW	In buffer area only
Commonwealth Land - Telstra Corporation Limited [13849]	NSW	In buffer area only
Defence		
Commonwealth Land - Defence Service Homes Corporation [14505]	NSW	In buffer area only
Commonwealth Land - Defence Service Homes Corporation [14573]	NSW	In buffer area only
Commonwealth Land - Defence Service Homes Corporation [13872]	NSW	In buffer area only
Commonwealth Land - Defence Service Homes Corporation [13870]	NSW	In buffer area only
Commonwealth Land - Defence Service Homes Corporation [13873]	NSW	In buffer area only
Commonwealth Land - Defence Service Homes Corporation [13879]	NSW	In buffer area only
Commonwealth Land - Defence Service Homes Corporation [13877]	NSW	In buffer area only
Commonwealth Land - Defence Service Homes Corporation [13875]	NSW	In buffer area only
Commonwealth Land - Defence Service Homes Corporation [13874]	NSW	In buffer area only
Commonwealth Land - Defence Service Homes Corporation [13871]	NSW	In buffer area only

Commonwealth Land Name	State	Buffer Status
Commonwealth Land - Defence Service Homes Corporation [13869]	NSW	In buffer area only
Commonwealth Land - Defence Service Homes Corporation [13005]	NSW	In buffer area only
Commonwealth Land - Defence Service Homes Corporation [13003]	NSW	In buffer area only
Commonwealth Land - Defence Service Homes Corporation [13846]	NSW	In buffer area only
Commonwealth Land - Defence Service Homes Corporation [14572]	NSW	In buffer area only
Commonwealth Land - Defence Service Homes Corporation [13876]	NSW	In buffer area only
Commonwealth Land - Director of Defence Service Homes [14569]	NSW	In buffer area only
Commonwealth Land - Director of Defence Service Homes [14571]	NSW	In buffer area only
Defence - CAMP SAPPER-EAST HILLS (Lot 2) : CAMP SAPPER TRAINING AREA (Lot 1) [10237]	NSW	In buffer area only
Defence - CAMP SAPPER-EAST HILLS (Lot 2) : CAMP SAPPER TRAINING AREA (Lot 1) [10236]	NSW	In buffer area only
Defence - CHESTER HILL (NO 2 STORE DPT) [10011]	NSW	In buffer area only
Defence - CHESTER HILL (NO 2 STORE DPT) [10010]	NSW	In buffer area only
Defence - EAST HILLS BARRACKS - OP SAFE HAVEN [10191]	NSW	In buffer area only
Defence - INGLEBURN AREA (Bardia Barracks) [10200]	NSW	In buffer area only
Defence - INGLEBURN AREA (Bardia Barracks) [10198]	NSW	In buffer area only
Defence - INGLEBURN AREA (Bardia Barracks) [10199]	NSW	In buffer area only
Defence - INGLEBURN AREA (Bardia Barracks) [10194]	NSW	In buffer area only
Defence - INGLEBURN AREA (Bardia Barracks) [10196]	NSW	In buffer area only
Defence - INGLEBURN AREA (Bardia Barracks) [10195]	NSW	In buffer area only
Defence - INGLEBURN AREA (Bardia Barracks) [10192]	NSW	In buffer area only
Defence - INGLEBURN AREA (Bardia Barracks) [10197]	NSW	In buffer area only
Defence - INGLEBURN AREA (Bardia Barracks) [10193]	NSW	In buffer area only
Defence - MERRYLANDS [10204]	NSW	In buffer area only
Defence - MOOREBANK AREA INC SME [10205]	NSW	In buffer area only
Defence - RAAF STORES DEPOT REGENTS PARK [10009]	NSW	In buffer area only
Defence - RAAF STORES DEPOT REGENTS PARK [10008]	NSW	In buffer area only

Commonwealth Land Name	State	Buffer Status
Defence - Suite 8, Library Plaza [10230]	NSW	In buffer area only
Defence - VILLAWOOD - MOTOR REPAIR W/SHP (VILLAWOOD GEMS BASE) [10231]	NSW	In buffer area only
Defence - WET BRIDGING SITE - CASULA [10211]	NSW	In buffer area only
Defence - Defence Housing Authority		
Commonwealth Land - Defence Housing Authority [15555]	NSW	In buffer area only
Commonwealth Land - Defence Housing Authority [15556]	NSW	In buffer area only
Commonwealth Land - Defence Housing Authority [15147]	NSW	In buffer area only
Commonwealth Land - Defence Housing Authority [13578]	NSW	In buffer area only
Commonwealth Land - Defence Housing Authority [15143]	NSW	In buffer area only
Commonwealth Land - Defence Housing Authority [16438]	NSW	In buffer area only
Commonwealth Land - Defence Housing Authority [15142]	NSW	In buffer area only
Commonwealth Land - Defence Housing Authority [15550]	NSW	In buffer area only
Commonwealth Land - Defence Housing Authority [15145]	NSW	In buffer area only
Commonwealth Land - Defence Housing Authority [15558]	NSW	In buffer area only
Commonwealth Land - Defence Housing Authority [15144]	NSW	In buffer area only
Commonwealth Land - Defence Housing Authority [15559]	NSW	In buffer area only
Commonwealth Land - Defence Housing Authority [15666]	NSW	In buffer area only
Commonwealth Land - Defence Housing Authority [15553]	NSW	In buffer area only
Commonwealth Land - Defence Housing Authority [15554]	NSW	In buffer area only
Commonwealth Land - Defence Housing Authority [15141]	NSW	In buffer area only
Commonwealth Land - Defence Housing Authority [15551]	NSW	In buffer area only
Commonwealth Land - Defence Housing Authority [13816]	NSW	In buffer area only
Commonwealth Land - Defence Housing Authority [15552]	NSW	In buffer area only
Commonwealth Land - Defence Housing Authority [13554]	NSW	In buffer area only
Commonwealth Land - Defence Housing Authority [15326]	NSW	In buffer area only
Commonwealth Land - Defence Housing Authority [13557]	NSW	In buffer area only
Commonwealth Land - Defence Housing Authority [13556]	NSW	In buffer area only

Commonwealth Land Name	State	Buffer Status
Commonwealth Land - Defence Housing Authority [13410]	NSW	In buffer area only
Commonwealth Land - Defence Housing Authority [15762]	NSW	In buffer area only
Commonwealth Land - Defence Housing Authority [16560]	NSW	In buffer area only
Commonwealth Land - Defence Housing Authority [13728]	NSW	In buffer area only
Commonwealth Land - Defence Housing Authority [15168]	NSW	In buffer area only
Commonwealth Land - Defence Housing Authority [13555]	NSW	In buffer area only
Commonwealth Land - Defence Housing Authority [15765]	NSW	In buffer area only
Commonwealth Land - Defence Housing Authority [13415]	NSW	In buffer area only
Commonwealth Land - Defence Housing Authority [15766]	NSW	In buffer area only
Commonwealth Land - Defence Housing Authority [15767]	NSW	In buffer area only
Commonwealth Land - Defence Housing Authority [13411]	NSW	In buffer area only
Commonwealth Land - Defence Housing Authority [13412]	NSW	In buffer area only
Commonwealth Land - Defence Housing Authority [13413]	NSW	In buffer area only
Commonwealth Land - Defence Housing Authority [13414]	NSW	In buffer area only
Commonwealth Land - Defence Housing Authority [13448]	NSW	In buffer area only
Commonwealth Land - Defence Housing Authority [15851]	NSW	In buffer area only
Commonwealth Land - Defence Housing Authority [15850]	NSW	In buffer area only
Commonwealth Land - Defence Housing Authority [15853]	NSW	In buffer area only
Commonwealth Land - Defence Housing Authority [13440]	NSW	In buffer area only
Commonwealth Land - Defence Housing Authority [15852]	NSW	In buffer area only
Commonwealth Land - Defence Housing Authority [13441]	NSW	In buffer area only
Commonwealth Land - Defence Housing Authority [15855]	NSW	In buffer area only
Commonwealth Land - Defence Housing Authority [13811]	NSW	In buffer area only
Commonwealth Land - Defence Housing Authority [13443]	NSW	In buffer area only
Commonwealth Land - Defence Housing Authority [15857]	NSW	In buffer area only
Commonwealth Land - Defence Housing Authority [13444]	NSW	In buffer area only
Commonwealth Land - Defence Housing Authority [15856]	NSW	In buffer area only

Commonwealth Land Name	State	Buffer Status
Commonwealth Land - Defence Housing Authority [13445]	NSW	In buffer area only
Commonwealth Land - Defence Housing Authority [13810]	NSW	In buffer area only
Commonwealth Land - Defence Housing Authority [13446]	NSW	In buffer area only
Commonwealth Land - Defence Housing Authority [15149]	NSW	In buffer area only
Commonwealth Land - Defence Housing Authority [13447]	NSW	In buffer area only
Commonwealth Land - Defence Housing Authority [15764]	NSW	In buffer area only
Commonwealth Land - Defence Housing Authority [13812]	NSW	In buffer area only
Commonwealth Land - Defence Housing Authority [15768]	NSW	In buffer area only
Commonwealth Land - Defence Housing Authority [15769]	NSW	In buffer area only
Commonwealth Land - Defence Housing Authority [13419]	NSW	In buffer area only
Commonwealth Land - Defence Housing Authority [13638]	NSW	In buffer area only
Commonwealth Land - Defence Housing Authority [13416]	NSW	In buffer area only
Commonwealth Land - Defence Housing Authority [13639]	NSW	In buffer area only
Commonwealth Land - Defence Housing Authority [13417]	NSW	In buffer area only
Commonwealth Land - Defence Housing Authority [15557]	NSW	In buffer area only
Commonwealth Land - Defence Housing Authority [13633]	NSW	In buffer area only
Commonwealth Land - Defence Housing Authority [15478]	NSW	In buffer area only
Commonwealth Land - Defence Housing Authority [13631]	NSW	In buffer area only
Commonwealth Land - Defence Housing Authority [13632]	NSW	In buffer area only
Commonwealth Land - Defence Housing Authority [13630]	NSW	In buffer area only
Commonwealth Land - Defence Housing Authority [13827]	NSW	In buffer area only
Commonwealth Land - Defence Housing Authority [13577]	NSW	In buffer area only
Commonwealth Land - Defence Housing Authority [13699]	NSW	In buffer area only
Commonwealth Land - Defence Housing Authority [13576]	NSW	In buffer area only
Commonwealth Land - Defence Housing Authority [13548]	NSW	In buffer area only
Commonwealth Land - Defence Housing Authority [16004]	NSW	In buffer area only
Commonwealth Land - Defence Housing Authority [15576]	NSW	In buffer area only

Commonwealth Land Name	State	Buffer Status
Commonwealth Land - Defence Housing Authority [15763]	NSW	In buffer area only
Commonwealth Land - Defence Housing Authority [15859]	NSW	In buffer area only
Commonwealth Land - Defence Housing Authority [13813]	NSW	In buffer area only
Commonwealth Land - Defence Housing Authority [15836]	NSW	In buffer area only
Commonwealth Land - Defence Housing Authority [15837]	NSW	In buffer area only
Commonwealth Land - Defence Housing Authority [13780]	NSW	In buffer area only
Commonwealth Land - Defence Housing Authority [15838]	NSW	In buffer area only
Commonwealth Land - Defence Housing Authority [13781]	NSW	In buffer area only
Commonwealth Land - Defence Housing Authority [15839]	NSW	In buffer area only
Commonwealth Land - Defence Housing Authority [13782]	NSW	In buffer area only
Commonwealth Land - Defence Housing Authority [13783]	NSW	In buffer area only
Commonwealth Land - Defence Housing Authority [13784]	NSW	In buffer area only
Commonwealth Land - Defence Housing Authority [13785]	NSW	In buffer area only
Commonwealth Land - Defence Housing Authority [13768]	NSW	In buffer area only
Commonwealth Land - Defence Housing Authority [13786]	NSW	In buffer area only
Commonwealth Land - Defence Housing Authority [13787]	NSW	In buffer area only
Commonwealth Land - Defence Housing Authority [13788]	NSW	In buffer area only
Commonwealth Land - Defence Housing Authority [15830]	NSW	In buffer area only
Commonwealth Land - Defence Housing Authority [13789]	NSW	In buffer area only
Commonwealth Land - Defence Housing Authority [15831]	NSW	In buffer area only
Commonwealth Land - Defence Housing Authority [15832]	NSW	In buffer area only
Commonwealth Land - Defence Housing Authority [15833]	NSW	In buffer area only
Commonwealth Land - Defence Housing Authority [15834]	NSW	In buffer area only
Commonwealth Land - Defence Housing Authority [15835]	NSW	In buffer area only
Commonwealth Land - Defence Housing Authority [13694]	NSW	In buffer area only
Commonwealth Land - Defence Housing Authority [13697]	NSW	In buffer area only
Commonwealth Land - Defence Housing Authority [13696]	NSW	In buffer area only

Commonwealth Land Name	State	Buffer Status
Commonwealth Land - Defence Housing Authority [13764]	NSW	In buffer area only
Commonwealth Land - Defence Housing Authority [13690]	NSW	In buffer area only
Commonwealth Land - Defence Housing Authority [13378]	NSW	In buffer area only
Commonwealth Land - Defence Housing Authority [13693]	NSW	In buffer area only
Commonwealth Land - Defence Housing Authority [13766]	NSW	In buffer area only
Commonwealth Land - Defence Housing Authority [13692]	NSW	In buffer area only
Commonwealth Land - Defence Housing Authority [13769]	NSW	In buffer area only
Commonwealth Land - Defence Housing Authority [13695]	NSW	In buffer area only
Commonwealth Land - Defence Housing Authority [13760]	NSW	In buffer area only
Commonwealth Land - Defence Housing Authority [15986]	NSW	In buffer area only
Commonwealth Land - Defence Housing Authority [13763]	NSW	In buffer area only
Commonwealth Land - Defence Housing Authority [13698]	NSW	In buffer area only
Commonwealth Land - Defence Housing Authority [13762]	NSW	In buffer area only
Commonwealth Land - Defence Housing Authority [13579]	NSW	In buffer area only
Commonwealth Land - Defence Housing Authority [13765]	NSW	In buffer area only
Commonwealth Land - Defence Housing Authority [15167]	NSW	In buffer area only
Commonwealth Land - Defence Housing Authority [13524]	NSW	In buffer area only
Commonwealth Land - Defence Housing Authority [15164]	NSW	In buffer area only
Commonwealth Land - Defence Housing Authority [13375]	NSW	In buffer area only
Commonwealth Land - Defence Housing Authority [15161]	NSW	In buffer area only
Commonwealth Land - Defence Housing Authority [16504]	NSW	In buffer area only
Commonwealth Land - Defence Housing Authority [15166]	NSW	In buffer area only
Commonwealth Land - Defence Housing Authority [13817]	NSW	In buffer area only
Commonwealth Land - Defence Housing Authority [13645]	NSW	In buffer area only
Commonwealth Land - Defence Housing Authority [15988]	NSW	In buffer area only
Commonwealth Land - Defence Housing Authority [13644]	NSW	In buffer area only
Commonwealth Land - Defence Housing Authority [15989]	NSW	In buffer area only

Commonwealth Land Name	State	Buffer Status
Commonwealth Land - Defence Housing Authority [15165]	NSW	In buffer area only
Commonwealth Land - Defence Housing Authority [13761]	NSW	In buffer area only
Commonwealth Land - Defence Housing Authority [13519]	NSW	In buffer area only
Commonwealth Land - Defence Housing Authority [15984]	NSW	In buffer area only
Commonwealth Land - Defence Housing Authority [15985]	NSW	In buffer area only
Commonwealth Land - Defence Housing Authority [15163]	NSW	In buffer area only
Commonwealth Land - Defence Housing Authority [15160]	NSW	In buffer area only
Commonwealth Land - Defence Housing Authority [15162]	NSW	In buffer area only
Commonwealth Land - Defence Housing Authority [13838]	NSW	In buffer area only
Commonwealth Land - Defence Housing Authority [15921]	NSW	In buffer area only
Commonwealth Land - Defence Housing Authority [13843]	NSW	In buffer area only
Commonwealth Land - Defence Housing Authority [15498]	NSW	In buffer area only
Commonwealth Land - Defence Housing Authority [13374]	NSW	In buffer area only
Commonwealth Land - Defence Housing Authority [13801]	NSW	In buffer area only
Commonwealth Land - Defence Housing Authority [16488]	NSW	In buffer area only
Commonwealth Land - Defence Housing Authority [15488]	NSW	In buffer area only
Commonwealth Land - Defence Housing Authority [15794]	NSW	In buffer area only
Commonwealth Land - Defence Housing Authority [15493]	NSW	In buffer area only
Commonwealth Land - Defence Housing Authority [13549]	NSW	In buffer area only
Commonwealth Land - Defence Housing Authority [15492]	NSW	In buffer area only
Commonwealth Land - Defence Housing Authority [15983]	NSW	In buffer area only
Commonwealth Land - Defence Housing Authority [15491]	NSW	In buffer area only
Commonwealth Land - Defence Housing Authority [15795]	NSW	In buffer area only
Commonwealth Land - Defence Housing Authority [15490]	NSW	In buffer area only
Commonwealth Land - Defence Housing Authority [13473]	NSW	In buffer area only
Commonwealth Land - Defence Housing Authority [15497]	NSW	In buffer area only
Commonwealth Land - Defence Housing Authority [15980]	NSW	In buffer area only

Commonwealth Land Name	State	Buffer Status
Commonwealth Land - Defence Housing Authority [15496]	NSW	In buffer area only
Commonwealth Land - Defence Housing Authority [15987]	NSW	In buffer area only
Commonwealth Land - Defence Housing Authority [15495]	NSW	In buffer area only
Commonwealth Land - Defence Housing Authority [15982]	NSW	In buffer area only
Commonwealth Land - Defence Housing Authority [15494]	NSW	In buffer area only
Commonwealth Land - Defence Housing Authority [15981]	NSW	In buffer area only
Commonwealth Land - Defence Housing Authority [13403]	NSW	In buffer area only
Commonwealth Land - Defence Housing Authority [15668]	NSW	In buffer area only
Commonwealth Land - Defence Housing Authority [13534]	NSW	In buffer area only
Commonwealth Land - Defence Housing Authority [13536]	NSW	In buffer area only
Commonwealth Land - Defence Housing Authority [13535]	NSW	In buffer area only
Commonwealth Land - Defence Housing Authority [13530]	NSW	In buffer area only
Commonwealth Land - Defence Housing Authority [13857]	NSW	In buffer area only
Commonwealth Land - Defence Housing Authority [13532]	NSW	In buffer area only
Commonwealth Land - Defence Housing Authority [13531]	NSW	In buffer area only
Commonwealth Land - Defence Housing Authority [15584]	NSW	In buffer area only
Commonwealth Land - Defence Housing Authority [13501]	NSW	In buffer area only
Commonwealth Land - Defence Housing Authority [15585]	NSW	In buffer area only
Commonwealth Land - Defence Housing Authority [13409]	NSW	In buffer area only
Commonwealth Land - Defence Housing Authority [15582]	NSW	In buffer area only
Commonwealth Land - Defence Housing Authority [15583]	NSW	In buffer area only
Commonwealth Land - Defence Housing Authority [15580]	NSW	In buffer area only
Commonwealth Land - Defence Housing Authority [15581]	NSW	In buffer area only
Commonwealth Land - Defence Housing Authority [13856]	NSW	In buffer area only
Commonwealth Land - Defence Housing Authority [13855]	NSW	In buffer area only
Commonwealth Land - Defence Housing Authority [13854]	NSW	In buffer area only
Commonwealth Land - Defence Housing Authority [13853]	NSW	In buffer area only

Commonwealth Land Name	State	Buffer Status
Commonwealth Land - Defence Housing Authority [13852]	NSW	In buffer area only
Commonwealth Land - Defence Housing Authority [13851]	NSW	In buffer area only
Commonwealth Land - Defence Housing Authority [13850]	NSW	In buffer area only
Commonwealth Land - Defence Housing Authority [13369]	NSW	In buffer area only
Commonwealth Land - Defence Housing Authority [13800]	NSW	In buffer area only
Commonwealth Land - Defence Housing Authority [15786]	NSW	In buffer area only
Commonwealth Land - Defence Housing Authority [13819]	NSW	In buffer area only
Commonwealth Land - Defence Housing Authority [13405]	NSW	In buffer area only
Commonwealth Land - Defence Housing Authority [15780]	NSW	In buffer area only
Commonwealth Land - Defence Housing Authority [13722]	NSW	In buffer area only
Commonwealth Land - Defence Housing Authority [15324]	NSW	In buffer area only
Commonwealth Land - Defence Housing Authority [13797]	NSW	In buffer area only
Commonwealth Land - Defence Housing Authority [13723]	NSW	In buffer area only
Commonwealth Land - Defence Housing Authority [13635]	NSW	In buffer area only
Commonwealth Land - Defence Housing Authority [13634]	NSW	In buffer area only
Commonwealth Land - Defence Housing Authority [13637]	NSW	In buffer area only
Commonwealth Land - Defence Housing Authority [13636]	NSW	In buffer area only
Commonwealth Land - Defence Housing Authority [15781]	NSW	In buffer area only
Commonwealth Land - Defence Housing Authority [13814]	NSW	In buffer area only
Commonwealth Land - Defence Housing Authority [16087]	NSW	In buffer area only
Commonwealth Land - Defence Housing Authority [15785]	NSW	In buffer area only
Commonwealth Land - Defence Housing Authority [13815]	NSW	In buffer area only
Commonwealth Land - Defence Housing Authority [15787]	NSW	In buffer area only
Commonwealth Land - Defence Housing Authority [15784]	NSW	In buffer area only
Commonwealth Land - Defence Housing Authority [15664]	NSW	In buffer area only
Commonwealth Land - Defence Housing Authority [15667]	NSW	In buffer area only
Commonwealth Land - Defence Housing Authority [15789]	NSW	In buffer area only

Commonwealth Land Name	State	Buffer Status
Commonwealth Land - Defence Housing Authority [13458]	NSW	In buffer area only
Commonwealth Land - Defence Housing Authority [15693]	NSW	In buffer area only
Commonwealth Land - Defence Housing Authority [15691]	NSW	In buffer area only
Commonwealth Land - Defence Housing Authority [16086]	NSW	In buffer area only
Commonwealth Land - Defence Housing Authority [16085]	NSW	In buffer area only
Commonwealth Land - Defence Housing Authority [16083]	NSW	In buffer area only
Commonwealth Land - Defence Housing Authority [16088]	NSW	In buffer area only
Commonwealth Land - Defence Housing Authority [13606]	NSW	In buffer area only
Commonwealth Land - Defence Housing Authority [13609]	NSW	In buffer area only
Commonwealth Land - Defence Housing Authority [13608]	NSW	In buffer area only
Commonwealth Land - Defence Housing Authority [15615]	NSW	In buffer area only
Commonwealth Land - Defence Housing Authority [13835]	NSW	In buffer area only
Commonwealth Land - Defence Housing Authority [13759]	NSW	In buffer area only
Commonwealth Land - Defence Housing Authority [13834]	NSW	In buffer area only
Commonwealth Land - Defence Housing Authority [13830]	NSW	In buffer area only
Commonwealth Land - Defence Housing Authority [13833]	NSW	In buffer area only
Commonwealth Land - Defence Housing Authority [13832]	NSW	In buffer area only
Commonwealth Land - Defence Housing Authority [13831]	NSW	In buffer area only
Commonwealth Land - Defence Housing Authority [13431]	NSW	In buffer area only
Commonwealth Land - Defence Housing Authority [15922]	NSW	In buffer area only
Commonwealth Land - Defence Housing Authority [13837]	NSW	In buffer area only
Commonwealth Land - Defence Housing Authority [13430]	NSW	In buffer area only
Commonwealth Land - Defence Housing Authority [15805]	NSW	In buffer area only
Commonwealth Land - Defence Housing Authority [16007]	NSW	In buffer area only
Commonwealth Land - Defence Housing Authority [15808]	NSW	In buffer area only
Commonwealth Land - Defence Housing Authority [15809]	NSW	In buffer area only
Commonwealth Land - Defence Housing Authority [16003]	NSW	In buffer area only

Commonwealth Land Name	State	Buffer Status
Commonwealth Land - Defence Housing Authority [16002]	NSW	In buffer area only
Commonwealth Land - Defence Housing Authority [16001]	NSW	In buffer area only
Commonwealth Land - Defence Housing Authority [16000]	NSW	In buffer area only
Commonwealth Land - Defence Housing Authority [15804]	NSW	In buffer area only
Commonwealth Land - Defence Housing Authority [13735]	NSW	In buffer area only
Commonwealth Land - Defence Housing Authority [13702]	NSW	In buffer area only
Commonwealth Land - Defence Housing Authority [13701]	NSW	In buffer area only
Commonwealth Land - Defence Housing Authority [13737]	NSW	In buffer area only
Commonwealth Land - Defence Housing Authority [13704]	NSW	In buffer area only
Commonwealth Land - Defence Housing Authority [13734]	NSW	In buffer area only
Commonwealth Land - Defence Housing Authority [13703]	NSW	In buffer area only
Commonwealth Land - Defence Housing Authority [15800]	NSW	In buffer area only
Commonwealth Land - Defence Housing Authority [13708]	NSW	In buffer area only
Commonwealth Land - Defence Housing Authority [15801]	NSW	In buffer area only
Commonwealth Land - Defence Housing Authority [15802]	NSW	In buffer area only
Commonwealth Land - Defence Housing Authority [13700]	NSW	In buffer area only
Commonwealth Land - Defence Housing Authority [15803]	NSW	In buffer area only
Commonwealth Land - Defence Housing Authority [13709]	NSW	In buffer area only
Commonwealth Land - Defence Housing Authority [15806]	NSW	In buffer area only
Commonwealth Land - Defence Housing Authority [15807]	NSW	In buffer area only
Commonwealth Land - Defence Housing Authority [13706]	NSW	In buffer area only
Commonwealth Land - Defence Housing Authority [13705]	NSW	In buffer area only
Commonwealth Land - Defence Housing Authority [13707]	NSW	In buffer area only
Commonwealth Land - Defence Housing Authority [13738]	NSW	In buffer area only
Commonwealth Land - Defence Housing Authority [13739]	NSW	In buffer area only
Commonwealth Land - Defence Housing Authority [13732]	NSW	In buffer area only
Commonwealth Land - Defence Housing Authority [13733]	NSW	In buffer area only

Commonwealth Land Name	State	Buffer Status
Commonwealth Land - Defence Housing Authority [15782]	NSW	In buffer area only
Commonwealth Land - Defence Housing Authority [16302]	NSW	In buffer area only
Commonwealth Land - Defence Housing Authority [15320]	NSW	In buffer area only
Commonwealth Land - Defence Housing Authority [13730]	NSW	In buffer area only
Commonwealth Land - Defence Housing Authority [13731]	NSW	In buffer area only
Commonwealth Land - Defence Housing Authority [13736]	NSW	In buffer area only
Commonwealth Land - Defence Housing Authority [13979]	NSW	In buffer area only
Commonwealth Land - Defence Housing Authority [13558]	NSW	In buffer area only
Commonwealth Land - Defence Housing Authority [13550]	NSW	In buffer area only
Commonwealth Land - Defence Housing Authority [13551]	NSW	In buffer area only
Commonwealth Land - Defence Housing Authority [13552]	NSW	In buffer area only
Commonwealth Land - Defence Housing Authority [13553]	NSW	In buffer area only
Commonwealth Land - Defence Housing Authority [13750]	NSW	In buffer area only
Commonwealth Land - Defence Housing Authority [13751]	NSW	In buffer area only
Commonwealth Land - Defence Housing Authority [13559]	NSW	In buffer area only
Commonwealth Land - Defence Housing Authority [16437]	NSW	In buffer area only
Commonwealth Land - Defence Housing Authority [16518]	NSW	In buffer area only
Commonwealth Land - Defence Housing Authority [13753]	NSW	In buffer area only
Commonwealth Land - Defence Housing Authority [13368]	NSW	In buffer area only
Commonwealth Land - Defence Housing Authority [14441]	NSW	In buffer area only
Commonwealth Land - Defence Housing Authority [15868]	NSW	In buffer area only
Commonwealth Land - Defence Housing Authority [15869]	NSW	In buffer area only
Commonwealth Land - Defence Housing Authority [15866]	NSW	In buffer area only
Commonwealth Land - Defence Housing Authority [15867]	NSW	In buffer area only
Commonwealth Land - Defence Housing Authority [15864]	NSW	In buffer area only
Commonwealth Land - Defence Housing Authority [13809]	NSW	In buffer area only
Commonwealth Land - Defence Housing Authority [13682]	NSW	In buffer area only

Commonwealth Land Name	State	Buffer Status
Commonwealth Land - Defence Housing Authority [13974]	NSW	In buffer area only
Commonwealth Land - Defence Housing Authority [13977]	NSW	In buffer area only
Commonwealth Land - Defence Housing Authority [13975]	NSW	In buffer area only
Commonwealth Land - Defence Housing Authority [13976]	NSW	In buffer area only
Commonwealth Land - Defence Housing Authority [12195]	NSW	In buffer area only
Commonwealth Land - Defence Housing Authority [13973]	NSW	In buffer area only
Commonwealth Land - Defence Housing Authority [13525]	NSW	In buffer area only
Commonwealth Land - Defence Housing Authority [13526]	NSW	In buffer area only
Commonwealth Land - Defence Housing Authority [15871]	NSW	In buffer area only
Commonwealth Land - Defence Housing Authority [13523]	NSW	In buffer area only
Commonwealth Land - Defence Housing Authority [15470]	NSW	In buffer area only
Commonwealth Land - Defence Housing Authority [15877]	NSW	In buffer area only
Commonwealth Land - Defence Housing Authority [13521]	NSW	In buffer area only
Commonwealth Land - Defence Housing Authority [15870]	NSW	In buffer area only
Commonwealth Land - Defence Housing Authority [13522]	NSW	In buffer area only
Commonwealth Land - Defence Housing Authority [15875]	NSW	In buffer area only
Commonwealth Land - Defence Housing Authority [15876]	NSW	In buffer area only
Commonwealth Land - Defence Housing Authority [12189]	NSW	In buffer area only
Commonwealth Land - Defence Housing Authority [13672]	NSW	In buffer area only
Commonwealth Land - Defence Housing Authority [13795]	NSW	In buffer area only
Commonwealth Land - Defence Housing Authority [13778]	NSW	In buffer area only
Commonwealth Land - Defence Housing Authority [13590]	NSW	In buffer area only
Commonwealth Land - Defence Housing Authority [13779]	NSW	In buffer area only
Commonwealth Land - Defence Housing Authority [15874]	NSW	In buffer area only
Commonwealth Land - Defence Housing Authority [13516]	NSW	In buffer area only
Commonwealth Land - Defence Housing Authority [15878]	NSW	In buffer area only
Commonwealth Land - Defence Housing Authority [12187]	NSW	In buffer area only

Commonwealth Land Name	State	Buffer Status
Commonwealth Land - Defence Housing Authority [15578]	NSW	In buffer area only
Commonwealth Land - Defence Housing Authority [13529]	NSW	In buffer area only
Commonwealth Land - Defence Housing Authority [13528]	NSW	In buffer area only
Commonwealth Land - Defence Housing Authority [13527]	NSW	In buffer area only
Commonwealth Land - Defence Housing Authority [14536]	NSW	In buffer area only
Commonwealth Land - Defence Housing Authority [13770]	NSW	In buffer area only
Commonwealth Land - Defence Housing Authority [14535]	NSW	In buffer area only
Commonwealth Land - Defence Housing Authority [13668]	NSW	In buffer area only
Commonwealth Land - Defence Housing Authority [13741]	NSW	In buffer area only
Commonwealth Land - Defence Housing Authority [13740]	NSW	In buffer area only
Commonwealth Land - Defence Housing Authority [13742]	NSW	In buffer area only
Commonwealth Land - Defence Housing Authority [15873]	NSW	In buffer area only
Commonwealth Land - Defence Housing Authority [13513]	NSW	In buffer area only
Commonwealth Land - Defence Housing Authority [16291]	NSW	In buffer area only
Commonwealth Land - Defence Housing Authority [13744]	NSW	In buffer area only
Commonwealth Land - Defence Housing Authority [13745]	NSW	In buffer area only
Commonwealth Land - Defence Housing Authority [13678]	NSW	In buffer area only
Commonwealth Land - Defence Housing Authority [12193]	NSW	In buffer area only
Commonwealth Land - Defence Housing Authority [12190]	NSW	In buffer area only
Commonwealth Land - Defence Housing Authority [12192]	NSW	In buffer area only
Commonwealth Land - Defence Housing Authority [13507]	NSW	In buffer area only
Commonwealth Land - Defence Housing Authority [13504]	NSW	In buffer area only
Commonwealth Land - Defence Housing Authority [12191]	NSW	In buffer area only
Commonwealth Land - Defence Housing Authority [12196]	NSW	In buffer area only
Commonwealth Land - Defence Housing Authority [14604]	NSW	In buffer area only
Commonwealth Land - Defence Housing Authority [13664]	NSW	In buffer area only
Commonwealth Land - Defence Housing Authority [13665]	NSW	In buffer area only

Commonwealth Land Name	State	Buffer Status
Commonwealth Land - Defence Housing Authority [13749]	NSW	In buffer area only
Commonwealth Land - Defence Housing Authority [13743]	NSW	In buffer area only
Commonwealth Land - Defence Housing Authority [13663]	NSW	In buffer area only
Commonwealth Land - Defence Housing Authority [13660]	NSW	In buffer area only
Commonwealth Land - Defence Housing Authority [13667]	NSW	In buffer area only
Commonwealth Land - Defence Housing Authority [13662]	NSW	In buffer area only
Commonwealth Land - Defence Housing Authority [13661]	NSW	In buffer area only
Commonwealth Land - Defence Housing Authority [13509]	NSW	In buffer area only
Commonwealth Land - Defence Housing Authority [12198]	NSW	In buffer area only
Commonwealth Land - Defence Housing Authority [16555]	NSW	In buffer area only
Commonwealth Land - Defence Housing Authority [16554]	NSW	In buffer area only
Commonwealth Land - Defence Housing Authority [16552]	NSW	In buffer area only
Commonwealth Land - Defence Housing Authority [14603]	NSW	In buffer area only
Commonwealth Land - Defence Housing Authority [13449]	NSW	In buffer area only
Commonwealth Land - Defence Housing Authority [13428]	NSW	In buffer area only
Commonwealth Land - Defence Housing Authority [16026]	NSW	In buffer area only
Commonwealth Land - Defence Housing Authority [16027]	NSW	In buffer area only
Commonwealth Land - Defence Housing Authority [13589]	NSW	In buffer area only
Commonwealth Land - Defence Housing Authority [15637]	NSW	In buffer area only
Commonwealth Land - Defence Housing Authority [16551]	NSW	In buffer area only
Commonwealth Land - Defence Housing Authority [16550]	NSW	In buffer area only
Commonwealth Land - Defence Housing Authority [16553]	NSW	In buffer area only
Commonwealth Land - Defence Housing Authority [15598]	NSW	In buffer area only
Commonwealth Land - Defence Housing Authority [13767]	NSW	In buffer area only
Commonwealth Land - Defence Housing Authority [13605]	NSW	In buffer area only
Commonwealth Land - Defence Housing Authority [13602]	NSW	In buffer area only
Commonwealth Land - Defence Housing Authority [13476]	NSW	In buffer area only

Commonwealth Land Name	State	Buffer Status
Commonwealth Land - Defence Housing Authority [13477]	NSW	In buffer area only
Commonwealth Land - Defence Housing Authority [13474]	NSW	In buffer area only
Commonwealth Land - Defence Housing Authority [13475]	NSW	In buffer area only
Commonwealth Land - Defence Housing Authority [13379]	NSW	In buffer area only
Commonwealth Land - Defence Housing Authority [16364]	NSW	In buffer area only
Commonwealth Land - Defence Housing Authority [13471]	NSW	In buffer area only
Commonwealth Land - Defence Housing Authority [16353]	NSW	In buffer area only
Commonwealth Land - Defence Housing Authority [15568]	NSW	In buffer area only
Commonwealth Land - Defence Housing Authority [13520]	NSW	In buffer area only
Commonwealth Land - Defence Housing Authority [15567]	NSW	In buffer area only
Commonwealth Land - Defence Housing Authority [15566]	NSW	In buffer area only
Commonwealth Land - Defence Housing Authority [15464]	NSW	In buffer area only
Commonwealth Land - Defence Housing Authority [15571]	NSW	In buffer area only
Commonwealth Land - Defence Housing Authority [15479]	NSW	In buffer area only
Commonwealth Land - Defence Housing Authority [15814]	NSW	In buffer area only
Commonwealth Land - Defence Housing Authority [13344]	NSW	In buffer area only
Commonwealth Land - Defence Housing Authority [13345]	NSW	In buffer area only
Commonwealth Land - Defence Housing Authority [16352]	NSW	In buffer area only
Commonwealth Land - Defence Housing Authority [13710]	NSW	In buffer area only
Commonwealth Land - Defence Housing Authority [13711]	NSW	In buffer area only
Commonwealth Land - Defence Housing Authority [13712]	NSW	In buffer area only
Commonwealth Land - Defence Housing Authority [13713]	NSW	In buffer area only
Commonwealth Land - Defence Housing Authority [13716]	NSW	In buffer area only
Commonwealth Land - Defence Housing Authority [13717]	NSW	In buffer area only
Commonwealth Land - Defence Housing Authority [15317]	NSW	In buffer area only
Commonwealth Land - Defence Housing Authority [15158]	NSW	In buffer area only
Commonwealth Land - Defence Housing Authority [13718]	NSW	In buffer area only

Commonwealth Land Name	State	Buffer Status
Commonwealth Land - Defence Housing Authority [13575]	NSW	In buffer area only
Commonwealth Land - Defence Housing Authority [13719]	NSW	In buffer area only
Commonwealth Land - Defence Housing Authority [15316]	NSW	In buffer area only
Commonwealth Land - Defence Housing Authority [15843]	NSW	In buffer area only
Commonwealth Land - Defence Housing Authority [15319]	NSW	In buffer area only
Commonwealth Land - Defence Housing Authority [13571]	NSW	In buffer area only
Commonwealth Land - Defence Housing Authority [15996]	NSW	In buffer area only
Commonwealth Land - Defence Housing Authority [13572]	NSW	In buffer area only
Commonwealth Land - Defence Housing Authority [15995]	NSW	In buffer area only
Commonwealth Land - Defence Housing Authority [13573]	NSW	In buffer area only
Commonwealth Land - Defence Housing Authority [13574]	NSW	In buffer area only
Commonwealth Land - Defence Housing Authority [15992]	NSW	In buffer area only
Commonwealth Land - Defence Housing Authority [15991]	NSW	In buffer area only
Commonwealth Land - Defence Housing Authority [15994]	NSW	In buffer area only
Commonwealth Land - Defence Housing Authority [13570]	NSW	In buffer area only
Commonwealth Land - Defence Housing Authority [15993]	NSW	In buffer area only
Commonwealth Land - Defence Housing Authority [12185]	NSW	In buffer area only
Commonwealth Land - Defence Housing Authority [13514]	NSW	In buffer area only
Commonwealth Land - Defence Housing Authority [15990]	NSW	In buffer area only
Commonwealth Land - Defence Housing Authority [13518]	NSW	In buffer area only
Commonwealth Land - Defence Housing Authority [15829]	NSW	In buffer area only
Commonwealth Land - Defence Housing Authority [15824]	NSW	In buffer area only
Commonwealth Land - Defence Housing Authority [13867]	NSW	In buffer area only
Commonwealth Land - Defence Housing Authority [15828]	NSW	In buffer area only
Commonwealth Land - Defence Housing Authority [13512]	NSW	In buffer area only
Commonwealth Land - Defence Housing Authority [15827]	NSW	In buffer area only
Commonwealth Land - Defence Housing Authority [12183]	NSW	In buffer area only

Commonwealth Land Name	State	Buffer Status
Commonwealth Land - Defence Housing Authority [15820]	NSW	In buffer area only
Commonwealth Land - Defence Housing Authority [15825]	NSW	In buffer area only
Commonwealth Land - Defence Housing Authority [15826]	NSW	In buffer area only
Commonwealth Land - Defence Housing Authority [15823]	NSW	In buffer area only
Commonwealth Land - Defence Housing Authority [13396]	NSW	In buffer area only
Commonwealth Land - Defence Housing Authority [15821]	NSW	In buffer area only
Commonwealth Land - Defence Housing Authority [15822]	NSW	In buffer area only
Commonwealth Land - Defence Housing Authority [13394]	NSW	In buffer area only
Commonwealth Land - Defence Housing Authority [13398]	NSW	In buffer area only
Commonwealth Land - Defence Housing Authority [13666]	NSW	In buffer area only
Commonwealth Land - Defence Housing Authority [13399]	NSW	In buffer area only
Commonwealth Land - Defence Housing Authority [13450]	NSW	In buffer area only
Commonwealth Land - Defence Housing Authority [15325]	NSW	In buffer area only
Commonwealth Land - Defence Housing Authority [13804]	NSW	In buffer area only
Commonwealth Land - Defence Housing Authority [13392]	NSW	In buffer area only
Commonwealth Land - Defence Housing Authority [13393]	NSW	In buffer area only
Commonwealth Land - Defence Housing Authority [13351]	NSW	In buffer area only
Commonwealth Land - Defence Housing Authority [13390]	NSW	In buffer area only
Commonwealth Land - Defence Housing Authority [15468]	NSW	In buffer area only
Commonwealth Land - Defence Housing Authority [13391]	NSW	In buffer area only
Commonwealth Land - Defence Housing Authority [13357]	NSW	In buffer area only
Commonwealth Land - Defence Housing Authority [15997]	NSW	In buffer area only
Commonwealth Land - Defence Housing Authority [13451]	NSW	In buffer area only
Commonwealth Land - Defence Housing Authority [13452]	NSW	In buffer area only
Commonwealth Land - Defence Housing Authority [13453]	NSW	In buffer area only
Commonwealth Land - Defence Housing Authority [13353]	NSW	In buffer area only
Commonwealth Land - Defence Housing Authority [15665]	NSW	In buffer area only

Commonwealth Land Name	State	Buffer Status
Commonwealth Land - Defence Housing Authority [15455]	NSW	In buffer area only
Commonwealth Land - Defence Housing Authority [15999]	NSW	In buffer area only
Commonwealth Land - Defence Housing Authority [13457]	NSW	In buffer area only
Commonwealth Land - Defence Housing Authority [15998]	NSW	In buffer area only
Commonwealth Land - Defence Housing Authority [13599]	NSW	In buffer area only
Commonwealth Land - Defence Housing Authority [15172]	NSW	In buffer area only
Commonwealth Land - Defence Housing Authority [13818]	NSW	In buffer area only
Commonwealth Land - Defence Housing Authority [15173]	NSW	In buffer area only
Commonwealth Land - Defence Housing Authority [13799]	NSW	In buffer area only
Commonwealth Land - Defence Housing Authority [15170]	NSW	In buffer area only
Commonwealth Land - Defence Housing Authority [15171]	NSW	In buffer area only
Commonwealth Land - Defence Housing Authority [15174]	NSW	In buffer area only
Commonwealth Land - Defence Housing Authority [15865]	NSW	In buffer area only
Commonwealth Land - Defence Housing Authority [15175]	NSW	In buffer area only
Commonwealth Land - Defence Housing Authority [15858]	NSW	In buffer area only
Commonwealth Land - Defence Housing Authority [13659]	NSW	In buffer area only
Commonwealth Land - Defence Housing Authority [16509]	NSW	In buffer area only
Commonwealth Land - Defence Housing Authority [13658]	NSW	In buffer area only
Commonwealth Land - Defence Housing Authority [13542]	NSW	In buffer area only
Commonwealth Land - Defence Housing Authority [13492]	NSW	In buffer area only
Commonwealth Land - Defence Housing Authority [16502]	NSW	In buffer area only
Commonwealth Land - Defence Housing Authority [13493]	NSW	In buffer area only
Commonwealth Land - Defence Housing Authority [16503]	NSW	In buffer area only
Commonwealth Land - Defence Housing Authority [13490]	NSW	In buffer area only
Commonwealth Land - Defence Housing Authority [16506]	NSW	In buffer area only
Commonwealth Land - Defence Housing Authority [13491]	NSW	In buffer area only
Commonwealth Land - Defence Housing Authority [16507]	NSW	In buffer area only

Commonwealth Land Name	State	Buffer Status
Commonwealth Land - Defence Housing Authority [16505]	NSW	In buffer area only
Commonwealth Land - Defence Housing Authority [15467]	NSW	In buffer area only
Commonwealth Land - Defence Housing Authority [16508]	NSW	In buffer area only
Commonwealth Land - Defence Housing Authority [15549]	NSW	In buffer area only
Commonwealth Land - Defence Housing Authority [13540]	NSW	In buffer area only
Commonwealth Land - Defence Housing Authority [15463]	NSW	In buffer area only
Commonwealth Land - Defence Housing Authority [15462]	NSW	In buffer area only
Commonwealth Land - Defence Housing Authority [13496]	NSW	In buffer area only
Commonwealth Land - Defence Housing Authority [13355]	NSW	In buffer area only
Commonwealth Land - Defence Housing Authority [13497]	NSW	In buffer area only
Commonwealth Land - Defence Housing Authority [13354]	NSW	In buffer area only
Commonwealth Land - Defence Housing Authority [13494]	NSW	In buffer area only
Commonwealth Land - Defence Housing Authority [13495]	NSW	In buffer area only
Commonwealth Land - Defence Housing Authority [13356]	NSW	In buffer area only
Commonwealth Land - Defence Housing Authority [16181]	NSW	In buffer area only
Commonwealth Land - Defence Housing Authority [16180]	NSW	In buffer area only
Commonwealth Land - Defence Housing Authority [16183]	NSW	In buffer area only
Commonwealth Land - Defence Housing Authority [16182]	NSW	In buffer area only
Commonwealth Land - Defence Housing Authority [15466]	NSW	In buffer area only
Commonwealth Land - Defence Housing Authority [13348]	NSW	In buffer area only
Commonwealth Land - Defence Housing Authority [13349]	NSW	In buffer area only
Commonwealth Land - Defence Housing Authority [13604]	NSW	In buffer area only
Commonwealth Land - Defence Housing Authority [12184]	NSW	In buffer area only
Commonwealth Land - Defence Housing Authority [16478]	NSW	In buffer area only
Commonwealth Land - Defence Housing Authority [16479]	NSW	In buffer area only
Commonwealth Land - Defence Housing Authority [12140]	NSW	In buffer area only
Commonwealth Land - Defence Housing Authority [13498]	NSW	In buffer area only

Commonwealth Land Name	State	Buffer Status
Commonwealth Land - Defence Housing Authority [12142]	NSW	In buffer area only
Commonwealth Land - Defence Housing Authority [13798]	NSW	In buffer area only
Commonwealth Land - Defence Housing Authority [15458]	NSW	In buffer area only
Commonwealth Land - Defence Housing Authority [13510]	NSW	In buffer area only
Commonwealth Land - Defence Housing Authority [12186]	NSW	In buffer area only
Commonwealth Land - Defence Housing Authority [13511]	NSW	In buffer area only
Commonwealth Land - Defence Housing Authority [12188]	NSW	In buffer area only
Commonwealth Land - Defence Housing Authority [16187]	NSW	In buffer area only
Commonwealth Land - Defence Housing Authority [16185]	NSW	In buffer area only
Commonwealth Land - Defence Housing Authority [13517]	NSW	In buffer area only
Commonwealth Land - Defence Housing Authority [16186]	NSW	In buffer area only
Commonwealth Land - Defence Housing Authority [13515]	NSW	In buffer area only
Commonwealth Land - Defence Housing Authority [13791]	NSW	In buffer area only
Commonwealth Land - Defence Housing Authority [13792]	NSW	In buffer area only
Commonwealth Land - Defence Housing Authority [13793]	NSW	In buffer area only
Commonwealth Land - Defence Housing Authority [13365]	NSW	In buffer area only
Commonwealth Land - Defence Housing Authority [15454]	NSW	In buffer area only
Commonwealth Land - Defence Housing Authority [15457]	NSW	In buffer area only
Commonwealth Land - Defence Housing Authority [15456]	NSW	In buffer area only
Commonwealth Land - Defence Housing Authority [13790]	NSW	In buffer area only
Commonwealth Land - Defence Housing Authority [13364]	NSW	In buffer area only
Commonwealth Land - Defence Housing Authority [13367]	NSW	In buffer area only
Commonwealth Land - Defence Housing Authority [15579]	NSW	In buffer area only
Commonwealth Land - Defence Housing Authority [13487]	NSW	In buffer area only
Commonwealth Land - Defence Housing Authority [15471]	NSW	In buffer area only
Commonwealth Land - Defence Housing Authority [13480]	NSW	In buffer area only
Commonwealth Land - Defence Housing Authority [13485]	NSW	In buffer area only

Commonwealth Land Name	State	Buffer Status
Commonwealth Land - Defence Housing Authority [13486]	NSW	In buffer area only
Commonwealth Land - Defence Housing Authority [15575]	NSW	In buffer area only
Commonwealth Land - Defence Housing Authority [13483]	NSW	In buffer area only
Commonwealth Land - Defence Housing Authority [15574]	NSW	In buffer area only
Commonwealth Land - Defence Housing Authority [13488]	NSW	In buffer area only
Commonwealth Land - Defence Housing Authority [15577]	NSW	In buffer area only
Commonwealth Land - Defence Housing Authority [13481]	NSW	In buffer area only
Commonwealth Land - Defence Housing Authority [13482]	NSW	In buffer area only
Commonwealth Land - Defence Housing Authority [16354]	NSW	In buffer area only
Commonwealth Land - Defence Housing Authority [16355]	NSW	In buffer area only
Commonwealth Land - Defence Housing Authority [15573]	NSW	In buffer area only
Commonwealth Land - Defence Housing Authority [13366]	NSW	In buffer area only
Commonwealth Land - Defence Housing Authority [13363]	NSW	In buffer area only
Commonwealth Land - Defence Housing Authority [13361]	NSW	In buffer area only
Commonwealth Land - Defence Housing Authority [13406]	NSW	In buffer area only
Commonwealth Land - Defence Housing Authority [13404]	NSW	In buffer area only
Commonwealth Land - Defence Housing Authority [13747]	NSW	In buffer area only
Commonwealth Land - Defence Housing Authority [13400]	NSW	In buffer area only
Commonwealth Land - Defence Housing Authority [13484]	NSW	In buffer area only
Commonwealth Land - Defence Housing Authority [13614]	NSW	In buffer area only
Commonwealth Land - Defence Housing Authority [13479]	NSW	In buffer area only
Commonwealth Land - Defence Housing Authority [13478]	NSW	In buffer area only
Commonwealth Land - Defence Housing Authority [13370]	NSW	In buffer area only
Commonwealth Land - Defence Housing Authority [12141]	NSW	In buffer area only
Commonwealth Land - Defence Housing Authority [13371]	NSW	In buffer area only
Commonwealth Land - Defence Housing Authority [13499]	NSW	In buffer area only
Commonwealth Land - Defence Housing Authority [13376]	NSW	In buffer area only

Commonwealth Land Name	State	Buffer Status
Commonwealth Land - Defence Housing Authority [15477]	NSW	In buffer area only
Commonwealth Land - Defence Housing Authority [13377]	NSW	In buffer area only
Commonwealth Land - Defence Housing Authority [15812]	NSW	In buffer area only
Commonwealth Land - Defence Housing Authority [15475]	NSW	In buffer area only
Commonwealth Land - Defence Housing Authority [15476]	NSW	In buffer area only
Commonwealth Land - Defence Housing Authority [15473]	NSW	In buffer area only
Commonwealth Land - Defence Housing Authority [15474]	NSW	In buffer area only
Commonwealth Land - Defence Housing Authority [15472]	NSW	In buffer area only
Commonwealth Land - Defence Housing Authority [13402]	NSW	In buffer area only
Commonwealth Land - Defence Housing Authority [13401]	NSW	In buffer area only
Commonwealth Land - Defence Housing Authority [13746]	NSW	In buffer area only
Commonwealth Land - Defence Housing Authority [13563]	NSW	In buffer area only
Commonwealth Land - Defence Housing Authority [13562]	NSW	In buffer area only
Commonwealth Land - Defence Housing Authority [13561]	NSW	In buffer area only
Commonwealth Land - Defence Housing Authority [13560]	NSW	In buffer area only
Commonwealth Land - Defence Housing Authority [13567]	NSW	In buffer area only
Commonwealth Land - Defence Housing Authority [13566]	NSW	In buffer area only
Commonwealth Land - Defence Housing Authority [13565]	NSW	In buffer area only
Commonwealth Land - Defence Housing Authority [13489]	NSW	In buffer area only
Commonwealth Land - Defence Housing Authority [13829]	NSW	In buffer area only
Commonwealth Land - Defence Housing Authority [13681]	NSW	In buffer area only
Commonwealth Land - Defence Housing Authority [15157]	NSW	In buffer area only
Commonwealth Land - Defence Housing Authority [15156]	NSW	In buffer area only
Commonwealth Land - Defence Housing Authority [15151]	NSW	In buffer area only
Commonwealth Land - Defence Housing Authority [15150]	NSW	In buffer area only
Commonwealth Land - Defence Housing Authority [15841]	NSW	In buffer area only
Commonwealth Land - Defence Housing Authority [15840]	NSW	In buffer area only

Commonwealth Land Name	State	Buffer Status
Commonwealth Land - Defence Housing Authority [15155]	NSW	In buffer area only
Commonwealth Land - Defence Housing Authority [15154]	NSW	In buffer area only
Commonwealth Land - Defence Housing Authority [15148]	NSW	In buffer area only
Commonwealth Land - Defence Housing Authority [13582]	NSW	In buffer area only
Commonwealth Land - Defence Housing Authority [15842]	NSW	In buffer area only
Commonwealth Land - Defence Housing Authority [15159]	NSW	In buffer area only
Commonwealth Land - Defence Housing Authority [13587]	NSW	In buffer area only
Commonwealth Land - Defence Housing Authority [13586]	NSW	In buffer area only
Commonwealth Land - Defence Housing Authority [13581]	NSW	In buffer area only
Commonwealth Land - Defence Housing Authority [13580]	NSW	In buffer area only
Commonwealth Land - Defence Housing Authority [15844]	NSW	In buffer area only
Commonwealth Land - Defence Housing Authority [15847]	NSW	In buffer area only
Commonwealth Land - Defence Housing Authority [15846]	NSW	In buffer area only
Commonwealth Land - Defence Housing Authority [13771]	NSW	In buffer area only
Commonwealth Land - Defence Housing Authority [13679]	NSW	In buffer area only
Commonwealth Land - Defence Housing Authority [15845]	NSW	In buffer area only
Commonwealth Land - Defence Housing Authority [13584]	NSW	In buffer area only
Commonwealth Land - Defence Housing Authority [13585]	NSW	In buffer area only
Commonwealth Land - Defence Housing Authority [13588]	NSW	In buffer area only
Commonwealth Land - Defence Housing Authority [13460]	NSW	In buffer area only
Commonwealth Land - Defence Housing Authority [13773]	NSW	In buffer area only
Commonwealth Land - Defence Housing Authority [15790]	NSW	In buffer area only
Commonwealth Land - Defence Housing Authority [15799]	NSW	In buffer area only
Commonwealth Land - Defence Housing Authority [15469]	NSW	In buffer area only
Commonwealth Land - Defence Housing Authority [15797]	NSW	In buffer area only
Commonwealth Land - Defence Housing Authority [15796]	NSW	In buffer area only
Commonwealth Land - Defence Housing Authority [15791]	NSW	In buffer area only

Commonwealth Land Name	State	Buffer Status
Commonwealth Land - Defence Housing Authority [13648]	NSW	In buffer area only
Commonwealth Land - Defence Housing Authority [16539]	NSW	In buffer area only
Commonwealth Land - Defence Housing Authority [16538]	NSW	In buffer area only
Commonwealth Land - Defence Housing Authority [13794]	NSW	In buffer area only
Commonwealth Land - Defence Housing Authority [15854]	NSW	In buffer area only
Commonwealth Land - Defence Housing Authority [15849]	NSW	In buffer area only
Commonwealth Land - Defence Housing Authority [13796]	NSW	In buffer area only
Commonwealth Land - Defence Housing Authority [15798]	NSW	In buffer area only
Commonwealth Land - Defence Housing Authority [16537]	NSW	In buffer area only
Commonwealth Land - Defence Housing Authority [16489]	NSW	In buffer area only
Commonwealth Land - Defence Housing Authority [15152]	NSW	In buffer area only
Commonwealth Land - Defence Housing Authority [16522]	NSW	In buffer area only
Commonwealth Land - Defence Housing Authority [16523]	NSW	In buffer area only
Commonwealth Land - Defence Housing Authority [14636]	NSW	In buffer area only
Commonwealth Land - Defence Housing Authority [14637]	NSW	In buffer area only
Commonwealth Land - Defence Housing Authority [13650]	NSW	In buffer area only
Commonwealth Land - Defence Housing Authority [15322]	NSW	In buffer area only
Commonwealth Land - Defence Housing Authority [13651]	NSW	In buffer area only
Commonwealth Land - Defence Housing Authority [13828]	NSW	In buffer area only
Commonwealth Land - Defence Housing Authority [13652]	NSW	In buffer area only
Commonwealth Land - Defence Housing Authority [13653]	NSW	In buffer area only
Commonwealth Land - Defence Housing Authority [15321]	NSW	In buffer area only
Commonwealth Land - Defence Housing Authority [13654]	NSW	In buffer area only
Commonwealth Land - Defence Housing Authority [13655]	NSW	In buffer area only
Commonwealth Land - Defence Housing Authority [13656]	NSW	In buffer area only
Commonwealth Land - Defence Housing Authority [13595]	NSW	In buffer area only
Commonwealth Land - Defence Housing Authority [13657]	NSW	In buffer area only

Commonwealth Land Name	State	Buffer Status
Commonwealth Land - Defence Housing Authority [15323]	NSW	In buffer area only
Commonwealth Land - Defence Housing Authority [13714]	NSW	In buffer area only
Commonwealth Land - Defence Housing Authority [13715]	NSW	In buffer area only
Commonwealth Land - Defence Housing Authority [13594]	NSW	In buffer area only
Commonwealth Land - Defence Housing Authority [13596]	NSW	In buffer area only
Commonwealth Land - Defence Housing Authority [13597]	NSW	In buffer area only
Commonwealth Land - Defence Housing Authority [13459]	NSW	In buffer area only
Commonwealth Land - Defence Housing Authority [13591]	NSW	In buffer area only
Commonwealth Land - Defence Housing Authority [13592]	NSW	In buffer area only
Commonwealth Land - Defence Housing Authority [13593]	NSW	In buffer area only
Commonwealth Land - Defence Housing Authority [13454]	NSW	In buffer area only
Commonwealth Land - Defence Housing Authority [13775]	NSW	In buffer area only
Commonwealth Land - Defence Housing Authority [13772]	NSW	In buffer area only
Commonwealth Land - Defence Housing Authority [13674]	NSW	In buffer area only
Commonwealth Land - Defence Housing Authority [13673]	NSW	In buffer area only
Commonwealth Land - Defence Housing Authority [13583]	NSW	In buffer area only
Commonwealth Land - Defence Housing Authority [13671]	NSW	In buffer area only
Commonwealth Land - Defence Housing Authority [13670]	NSW	In buffer area only
Commonwealth Land - Defence Housing Authority [13776]	NSW	In buffer area only
Commonwealth Land - Defence Housing Authority [13777]	NSW	In buffer area only
Commonwealth Land - Defence Housing Authority [13774]	NSW	In buffer area only
Commonwealth Land - Defence Housing Authority [13675]	NSW	In buffer area only
Commonwealth Land - Defence Housing Authority [13677]	NSW	In buffer area only
Commonwealth Land - Defence Housing Authority [13676]	NSW	In buffer area only
Commonwealth Land - Defence Housing Authority [14635]	NSW	In buffer area only
Commonwealth Land - Defence Housing Authority [14634]	NSW	In buffer area only
Commonwealth Land - Defence Housing Authority [14638]	NSW	In buffer area only

Commonwealth Land Name	State	Buffer Status
Commonwealth Land - Defence Housing Authority [14639]	NSW	In buffer area only
Commonwealth Land - Defence Housing Authority [15146]	NSW	In buffer area only
Commonwealth Land - Defence Housing Authority [13418]	NSW	In buffer area only
Commonwealth Land - Defence Housing Authority [13756]	NSW	In buffer area only
Commonwealth Land - Defence Housing Authority [13755]	NSW	In buffer area only
Commonwealth Land - Defence Housing Authority [16549]	NSW	In buffer area only
Commonwealth Land - Defence Housing Authority [13757]	NSW	In buffer area only
Commonwealth Land - Defence Housing Authority [13508]	NSW	In buffer area only
Commonwealth Land - Defence Housing Authority [15861]	NSW	In buffer area only
Commonwealth Land - Defence Housing Authority [15860]	NSW	In buffer area only
Commonwealth Land - Defence Housing Authority [15863]	NSW	In buffer area only
Commonwealth Land - Defence Housing Authority [15862]	NSW	In buffer area only
Commonwealth Land - Defence Housing Authority [13754]	NSW	In buffer area only
Commonwealth Land - Defence Housing Authority [13612]	NSW	In buffer area only
Commonwealth Land - Defence Housing Authority [13616]	NSW	In buffer area only
Commonwealth Land - Defence Housing Authority [13617]	NSW	In buffer area only
Commonwealth Land - Defence Housing Authority [13600]	NSW	In buffer area only
Commonwealth Land - Defence Housing Authority [13615]	NSW	In buffer area only
Commonwealth Land - Defence Housing Authority [13601]	NSW	In buffer area only
Commonwealth Land - Defence Housing Authority [13752]	NSW	In buffer area only
Commonwealth Land - Defence Housing Authority [13618]	NSW	In buffer area only
Commonwealth Land - Defence Housing Authority [13619]	NSW	In buffer area only
Commonwealth Land - Defence Housing Authority [13610]	NSW	In buffer area only
Commonwealth Land - Defence Housing Authority [13613]	NSW	In buffer area only
Commonwealth Land - Defence Housing Authority [16548]	NSW	In buffer area only
Commonwealth Land - Defence Housing Authority [13502]	NSW	In buffer area only
Commonwealth Land - Defence Housing Authority [13611]	NSW	In buffer area only

Commonwealth Land Name	State	Buffer Status
Commonwealth Land - Defence Housing Authority [13603]	NSW	In buffer area only
Commonwealth Land - Defence Housing Authority [16541]	NSW	In buffer area only
Commonwealth Land - Defence Housing Authority [16540]	NSW	In buffer area only
Commonwealth Land - Defence Housing Authority [16545]	NSW	In buffer area only
Commonwealth Land - Defence Housing Authority [16542]	NSW	In buffer area only
Commonwealth Land - Defence Housing Authority [16543]	NSW	In buffer area only
Commonwealth Land - Defence Housing Authority [16544]	NSW	In buffer area only
Commonwealth Land - Defence Housing Authority [16547]	NSW	In buffer area only
Commonwealth Land - Defence Housing Authority [16546]	NSW	In buffer area only
Commonwealth Land - Defence Housing Authority [13500]	NSW	In buffer area only
Commonwealth Land - Defence Housing Authority [15783]	NSW	In buffer area only
Commonwealth Land - Defence Housing Authority [16005]	NSW	In buffer area only
Commonwealth Land - Defence Housing Authority [13807]	NSW	In buffer area only
Commonwealth Land - Defence Housing Authority [13506]	NSW	In buffer area only
Commonwealth Land - Defence Housing Authority [13607]	NSW	In buffer area only
Commonwealth Land - Defence Housing Authority [13421]	NSW	In buffer area only
Commonwealth Land - Defence Housing Authority [13426]	NSW	In buffer area only
Commonwealth Land - Defence Housing Authority [13423]	NSW	In buffer area only
Commonwealth Land - Defence Housing Authority [13420]	NSW	In buffer area only
Commonwealth Land - Defence Housing Authority [13425]	NSW	In buffer area only
Commonwealth Land - Defence Housing Authority [13541]	NSW	In buffer area only
Commonwealth Land - Defence Housing Authority [13427]	NSW	In buffer area only
Commonwealth Land - Defence Housing Authority [13424]	NSW	In buffer area only
Commonwealth Land - Defence Housing Authority [16517]	NSW	In buffer area only
Commonwealth Land - Defence Housing Authority [16487]	NSW	In buffer area only
Commonwealth Land - Defence Housing Authority [16514]	NSW	In buffer area only
Commonwealth Land - Defence Housing Authority [16521]	NSW	In buffer area only

Commonwealth Land Name	State	Buffer Status
Commonwealth Land - Defence Housing Authority [16515]	NSW	In buffer area only
Commonwealth Land - Defence Housing Authority [13384]	NSW	In buffer area only
Commonwealth Land - Defence Housing Authority [13844]	NSW	In buffer area only
Commonwealth Land - Defence Housing Authority [15481]	NSW	In buffer area only
Commonwealth Land - Defence Housing Authority [16511]	NSW	In buffer area only
Commonwealth Land - Defence Housing Authority [15480]	NSW	In buffer area only
Commonwealth Land - Defence Housing Authority [16516]	NSW	In buffer area only
Commonwealth Land - Defence Housing Authority [13840]	NSW	In buffer area only
Commonwealth Land - Defence Housing Authority [13841]	NSW	In buffer area only
Commonwealth Land - Defence Housing Authority [13386]	NSW	In buffer area only
Commonwealth Land - Defence Housing Authority [13385]	NSW	In buffer area only
Commonwealth Land - Defence Housing Authority [13380]	NSW	In buffer area only
Commonwealth Land - Defence Housing Authority [13387]	NSW	In buffer area only
Commonwealth Land - Defence Housing Authority [13429]	NSW	In buffer area only
Commonwealth Land - Defence Housing Authority [13543]	NSW	In buffer area only
Commonwealth Land - Defence Housing Authority [13389]	NSW	In buffer area only
Commonwealth Land - Defence Housing Authority [13598]	NSW	In buffer area only
Commonwealth Land - Defence Housing Authority [13470]	NSW	In buffer area only
Commonwealth Land - Defence Housing Authority [13372]	NSW	In buffer area only
Commonwealth Land - Defence Housing Authority [13388]	NSW	In buffer area only
Commonwealth Land - Defence Housing Authority [13382]	NSW	In buffer area only
Commonwealth Land - Defence Housing Authority [13383]	NSW	In buffer area only
Commonwealth Land - Defence Housing Authority [12137]	NSW	In buffer area only
Commonwealth Land - Defence Housing Authority [13381]	NSW	In buffer area only
Commonwealth Land - Defence Housing Authority [13472]	NSW	In buffer area only
Commonwealth Land - Defence Housing Authority [12139]	NSW	In buffer area only
Commonwealth Land - Defence Housing Authority [12138]	NSW	In buffer area only

Commonwealth Land Name	State	Buffer Status
Commonwealth Land - Defence Housing Authority [15487]	NSW	In buffer area only
Commonwealth Land - Defence Housing Authority [16480]	NSW	In buffer area only
Commonwealth Land - Defence Housing Authority [13564]	NSW	In buffer area only
Commonwealth Land - Defence Housing Authority [13569]	NSW	In buffer area only
Commonwealth Land - Defence Housing Authority [13568]	NSW	In buffer area only
Commonwealth Land - Defence Housing Authority [13422]	NSW	In buffer area only
Commonwealth Land - Defence Housing Authority [13437]	NSW	In buffer area only
Commonwealth Land - Defence Housing Authority [13434]	NSW	In buffer area only
Commonwealth Land - Defence Housing Authority [13748]	NSW	In buffer area only
Commonwealth Land - Defence Housing Authority [13436]	NSW	In buffer area only
Commonwealth Land - Defence Housing Authority [13842]	NSW	In buffer area only
Commonwealth Land - Defence Housing Authority [14640]	NSW	In buffer area only
Commonwealth Land - Defence Housing Authority [14641]	NSW	In buffer area only
Commonwealth Land - Defence Housing Authority [13435]	NSW	In buffer area only
Commonwealth Land - Defence Housing Authority [13373]	NSW	In buffer area only
Commonwealth Land - Defence Housing Authority [15489]	NSW	In buffer area only
Commonwealth Land - Defence Housing Authority [13758]	NSW	In buffer area only
Commonwealth Land - Defence Housing Authority [16513]	NSW	In buffer area only
Commonwealth Land - Defence Housing Authority [16512]	NSW	In buffer area only
Commonwealth Land - Defence Housing Authority [16519]	NSW	In buffer area only
Commonwealth Land - Defence Housing Authority [14642]	NSW	In buffer area only
Commonwealth Land - Defence Housing Authority [13539]	NSW	In buffer area only
Commonwealth Land - Defence Housing Authority [13433]	NSW	In buffer area only
Commonwealth Land - Defence Housing Authority [13432]	NSW	In buffer area only
Commonwealth Land - Defence Housing Authority [16510]	NSW	In buffer area only
Commonwealth Land - Defence Housing Authority [13628]	NSW	In buffer area only
Commonwealth Land - Defence Housing Authority [13629]	NSW	In buffer area only

Commonwealth Land Name	State	Buffer Status
Commonwealth Land - Defence Housing Authority [15817]	NSW	In buffer area only
Commonwealth Land - Defence Housing Authority [13505]	NSW	In buffer area only
Commonwealth Land - Defence Housing Authority [15815]	NSW	In buffer area only
Commonwealth Land - Defence Housing Authority [13806]	NSW	In buffer area only
Commonwealth Land - Defence Housing Authority [15816]	NSW	In buffer area only
Commonwealth Land - Defence Housing Authority [15811]	NSW	In buffer area only
Commonwealth Land - Defence Housing Authority [15810]	NSW	In buffer area only
Commonwealth Land - Defence Housing Authority [15819]	NSW	In buffer area only
Commonwealth Land - Defence Housing Authority [15818]	NSW	In buffer area only
Commonwealth Land - Defence Housing Authority [15813]	NSW	In buffer area only
Commonwealth Land - Defence Housing Authority [12194]	NSW	In buffer area only
Commonwealth Land - Defence Housing Authority [13622]	NSW	In buffer area only
Commonwealth Land - Defence Housing Authority [13621]	NSW	In buffer area only
Commonwealth Land - Defence Housing Authority [13620]	NSW	In buffer area only
Commonwealth Land - Defence Housing Authority [15848]	NSW	In buffer area only
Commonwealth Land - Defence Housing Authority [13626]	NSW	In buffer area only
Commonwealth Land - Defence Housing Authority [13625]	NSW	In buffer area only
Commonwealth Land - Defence Housing Authority [13624]	NSW	In buffer area only
Commonwealth Land - Defence Housing Authority [15770]	NSW	In buffer area only
Commonwealth Land - Defence Housing Authority [13680]	NSW	In buffer area only
Commonwealth Land - Defence Housing Authority [13724]	NSW	In buffer area only
Commonwealth Land - Defence Housing Authority [13725]	NSW	In buffer area only
Commonwealth Land - Defence Housing Authority [13726]	NSW	In buffer area only
Commonwealth Land - Defence Housing Authority [13727]	NSW	In buffer area only
Commonwealth Land - Defence Housing Authority [15779]	NSW	In buffer area only
Commonwealth Land - Defence Housing Authority [13721]	NSW	In buffer area only
Commonwealth Land - Defence Housing Authority [13720]	NSW	In buffer area only

Commonwealth Land Name	State	Buffer Status
Commonwealth Land - Defence Housing Authority [13688]	NSW	In buffer area only
Commonwealth Land - Defence Housing Authority [13689]	NSW	In buffer area only
Commonwealth Land - Defence Housing Authority [15772]	NSW	In buffer area only
Commonwealth Land - Defence Housing Authority [15771]	NSW	In buffer area only
Commonwealth Land - Defence Housing Authority [15774]	NSW	In buffer area only
Commonwealth Land - Defence Housing Authority [15773]	NSW	In buffer area only
Commonwealth Land - Defence Housing Authority [15776]	NSW	In buffer area only
Commonwealth Land - Defence Housing Authority [15775]	NSW	In buffer area only
Commonwealth Land - Defence Housing Authority [15778]	NSW	In buffer area only
Commonwealth Land - Defence Housing Authority [15777]	NSW	In buffer area only
Commonwealth Land - Defence Housing Authority [13687]	NSW	In buffer area only
Commonwealth Land - Defence Housing Authority [13686]	NSW	In buffer area only
Commonwealth Land - Defence Housing Authority [13836]	NSW	In buffer area only
Commonwealth Land - Defence Housing Authority [13533]	NSW	In buffer area only
Commonwealth Land - Defence Housing Authority [13438]	NSW	In buffer area only
Commonwealth Land - Defence Housing Authority [13439]	NSW	In buffer area only
Commonwealth Land - Defence Housing Authority [13729]	NSW	In buffer area only
Commonwealth Land - Defence Housing Authority [13683]	NSW	In buffer area only
Commonwealth Land - Defence Housing Authority [13684]	NSW	In buffer area only
Commonwealth Land - Defence Housing Authority [13685]	NSW	In buffer area only
Commonwealth Land - Defence Housing Authority [15680]	NSW	In buffer area only
Commonwealth Land - Defence Housing Authority [13808]	NSW	In buffer area only
Commonwealth Land - Defence Housing Authority [13627]	NSW	In buffer area only
Commonwealth Land - Defence Housing Authority [16365]	NSW	In buffer area only
Commonwealth Land - Defence Housing Authority [15561]	NSW	In buffer area only
Commonwealth Land - Defence Housing Authority [15597]	NSW	In buffer area only
Commonwealth Land - Defence Housing Authority [16341]	NSW	In buffer area only

Commonwealth Land Name	State	Buffer Status
Commonwealth Land - Defence Housing Authority [13544]	NSW	In buffer area only
Commonwealth Land - Defence Housing Authority [13545]	NSW	In buffer area only
Commonwealth Land - Defence Housing Authority [13546]	NSW	In buffer area only
Commonwealth Land - Defence Housing Authority [13547]	NSW	In buffer area only
Commonwealth Land - Defence Housing Authority [13978]	NSW	In buffer area only
Commonwealth Land - Defence Housing Authority [15788]	NSW	In buffer area only
Commonwealth Land - Defence Housing Authority [15153]	NSW	In buffer area only
Commonwealth Land - Defence Housing Authority [13641]	NSW	In buffer area only
Commonwealth Land - Defence Housing Authority [13839]	NSW	In buffer area only
Commonwealth Land - Defence Housing Authority [13640]	NSW	In buffer area only
Commonwealth Land - Defence Housing Authority [13805]	NSW	In buffer area only
Commonwealth Land - Defence Housing Authority [13647]	NSW	In buffer area only
Commonwealth Land - Defence Housing Authority [13646]	NSW	In buffer area only
Commonwealth Land - Defence Housing Authority [13649]	NSW	In buffer area only
Commonwealth Land - Defence Housing Authority [13802]	NSW	In buffer area only
Commonwealth Land - Defence Housing Authority [15560]	NSW	In buffer area only
Commonwealth Land - Defence Housing Authority [13643]	NSW	In buffer area only
Commonwealth Land - Defence Housing Authority [15565]	NSW	In buffer area only
Commonwealth Land - Defence Housing Authority [13642]	NSW	In buffer area only
Commonwealth Land - Defence Housing Authority [15562]	NSW	In buffer area only
Commonwealth Land - Director of War Service Homes [16563]	NSW	In buffer area only
Commonwealth Land - Director of War Service Homes [13886]	NSW	In buffer area only
Commonwealth Land - Director of War Service Homes [14501]	NSW	In buffer area only
Commonwealth Land - Director of War Service Homes [13887]	NSW	In buffer area only
Commonwealth Land - Director of War Service Homes [14502]	NSW	In buffer area only
Commonwealth Land - Director of War Service Homes [13884]	NSW	In buffer area only
Commonwealth Land - Director of War Service Homes [14568]	NSW	In buffer area only

Commonwealth Land Name	State	Buffer Status
Commonwealth Land - Director of War Service Homes [14500]	NSW	In buffer area only
Commonwealth Land - Director of War Service Homes [14499]	NSW	In buffer area only
Commonwealth Land - Director of War Service Homes [14498]	NSW	In buffer area only
Commonwealth Land - Director of War Service Homes [13889]	NSW	In buffer area only
Commonwealth Land - Director of War Service Homes [13888]	NSW	In buffer area only
Commonwealth Land - Director of War Service Homes [14497]	NSW	In buffer area only
Commonwealth Land - Director of War Service Homes [13878]	NSW	In buffer area only
Commonwealth Land - Director of War Service Homes [14532]	NSW	In buffer area only
Commonwealth Land - Director of War Service Homes [14533]	NSW	In buffer area only
Commonwealth Land - Director of War Service Homes [14531]	NSW	In buffer area only
Commonwealth Land - Director of War Service Homes [13865]	NSW	In buffer area only
Commonwealth Land - Director of War Service Homes [13868]	NSW	In buffer area only
Commonwealth Land - Director of War Service Homes [13861]	NSW	In buffer area only
Commonwealth Land - Director of War Service Homes [13863]	NSW	In buffer area only
Commonwealth Land - Director of War Service Homes [13881]	NSW	In buffer area only
Commonwealth Land - Director of War Service Homes [14575]	NSW	In buffer area only
Commonwealth Land - Director of War Service Homes [14480]	NSW	In buffer area only
Commonwealth Land - Director of War Service Homes [13862]	NSW	In buffer area only
Commonwealth Land - Director of War Service Homes [14483]	NSW	In buffer area only
Commonwealth Land - Director of War Service Homes [13880]	NSW	In buffer area only
Commonwealth Land - Director of War Service Homes [13359]	NSW	In buffer area only
Commonwealth Land - Director of War Service Homes [14427]	NSW	In buffer area only
Commonwealth Land - Director of War Service Homes [14520]	NSW	In buffer area only
Commonwealth Land - Director of War Service Homes [13004]	NSW	In buffer area only
Commonwealth Land - Director of War Service Homes [13456]	NSW	In buffer area only
Commonwealth Land - Director of War Service Homes [14493]	NSW	In buffer area only
Commonwealth Land - Director of War Service Homes [14478]	NSW	In buffer area only

Commonwealth Land Name	State	Buffer Status
Commonwealth Land - Director of War Service Homes [14534]	NSW	In buffer area only
Commonwealth Land - Director of War Service Homes [14479]	NSW	In buffer area only
Commonwealth Land - Director of War Service Homes [14492]	NSW	In buffer area only
Commonwealth Land - Director of War Service Homes [14577]	NSW	In buffer area only
Commonwealth Land - Director of War Service Homes [14576]	NSW	In buffer area only
Commonwealth Land - Director of War Service Homes [14574]	NSW	In buffer area only
Commonwealth Land - Director of War Service Homes [14570]	NSW	In buffer area only
Education, Science and Training - CSIRO		
Commonwealth Land - Commonwealth Scientific & Industrial Research Organisation [14605]	NSW	In buffer area only
Commonwealth Land - Commonwealth Scientific & Industrial Research Organisation [14606]	NSW	In buffer area only
Commonwealth Land - Commonwealth Scientific & Industrial Research Organisation [14607]	NSW	In buffer area only
Unknown		
Commonwealth Land - [13408]	NSW	In buffer area only
Commonwealth Land - [15169]	NSW	In buffer area only
Commonwealth Land - [13442]	NSW	In buffer area only
Commonwealth Land - [13823]	NSW	In buffer area only
Commonwealth Land - [13822]	NSW	In buffer area only
Commonwealth Land - [13821]	NSW	In buffer area only
Commonwealth Land - [13826]	NSW	In buffer area only
Commonwealth Land - [13825]	NSW	In buffer area only
Commonwealth Land - [13824]	NSW	In buffer area only
Commonwealth Land - [13885]	NSW	In buffer area only
Commonwealth Land - [13691]	NSW	In buffer area only
Commonwealth Land - [12926]	NSW	In buffer area only
Commonwealth Land - [12925]	NSW	In buffer area only
Commonwealth Land - [13469]	NSW	In buffer area only

Commonwealth Land Name	State	Buffer Status
Commonwealth Land - [13859]	NSW	In buffer area only
Commonwealth Land - [13537]	NSW	In buffer area only
Commonwealth Land - [13858]	NSW	In buffer area only
Commonwealth Land - [13848]	NSW	In buffer area only
Commonwealth Land - [16361]	NSW	In buffer area only
Commonwealth Land - [15694]	NSW	In buffer area only
Commonwealth Land - [15692]	NSW	In buffer area only
Commonwealth Land - [16006]	NSW	In buffer area only
Commonwealth Land - [16303]	NSW	In buffer area only
Commonwealth Land - [15872]	NSW	In buffer area only
Commonwealth Land - [13669]	NSW	In buffer area only
Commonwealth Land - [14538]	NSW	In buffer area only
Commonwealth Land - [13463]	NSW	In buffer area only
Commonwealth Land - [15318]	NSW	In buffer area only
Commonwealth Land - [13397]	NSW	In buffer area only
Commonwealth Land - [13395]	NSW	In buffer area only
Commonwealth Land - [13352]	NSW	In buffer area only
Commonwealth Land - [15465]	NSW	In buffer area only
Commonwealth Land - [16472]	NSW	In buffer area only
Commonwealth Land - [16188]	NSW	In buffer area only
Commonwealth Land - [13362]	NSW	In buffer area only
Commonwealth Land - [13360]	NSW	In buffer area only
Commonwealth Land - [13407]	NSW	In buffer area only
Commonwealth Land - [15663]	NSW	In buffer area only
Commonwealth Land - [15140]	NSW	In buffer area only
Commonwealth Land - [13468]	NSW	In buffer area only
Commonwealth Land - [13461]	NSW	In buffer area only

Commonwealth Land Name	State	Buffer Status
Commonwealth Land - [13465]	NSW	In buffer area only
Commonwealth Land - [13462]	NSW	In buffer area only
Commonwealth Land - [13467]	NSW	In buffer area only
Commonwealth Land - [13464]	NSW	In buffer area only
Commonwealth Land - [13466]	NSW	In buffer area only
Commonwealth Land - [15793]	NSW	In buffer area only
Commonwealth Land - [15792]	NSW	In buffer area only
Commonwealth Land - [16520]	NSW	In buffer area only
Commonwealth Land - [13820]	NSW	In buffer area only
Commonwealth Land - [16184]	NSW	In buffer area only
Commonwealth Land - [13847]	NSW	In buffer area only
Commonwealth Land - [13538]	NSW	In buffer area only
Commonwealth Land - [13623]	NSW	In buffer area only
Commonwealth Land - [13803]	NSW	In buffer area only

Commonwealth Heritage Places			[Resource Information]
Name	State	Status	Buffer Status
Historic			
Bankstown Airport Air Traffic Control Tower	NSW	Listed place	In buffer area only
Old Army / Internment Camp Group Holsworthy	NSW	Listed place	In buffer area only
Villawood Immigration Centre	NSW	Listed place	In buffer area only
Villawood Immigration Centre - former boundary	NSW	Within listed place	In buffer area only

Indigenous			
Cubbitch Barta National Estate Area	NSW	Listed place	In buffer area only

Listed Marine Species			[Resource Information]
Scientific Name	Threatened Category	Presence Text	Buffer Status
Bird			
Actitis hypoleucos			
Common Sandpiper [59309]		Species or species habitat known to occur within area	In feature area

Scientific Name	Threatened Category	Presence Text	Buffer Status
Apus pacificus Fork-tailed Swift [678]		Species or species habitat likely to occur within area overfly marine area	In feature area
Ardena grisea as Puffinus griseus Sooty Shearwater [82651]	Vulnerable	Species or species habitat likely to occur within area	In buffer area only
Bubulcus ibis as Ardea ibis Cattle Egret [66521]		Species or species habitat may occur within area overfly marine area	In feature area
Calidris acuminata Sharp-tailed Sandpiper [874]	Vulnerable	Species or species habitat known to occur within area	In feature area
Calidris canutus Red Knot, Knot [855]	Vulnerable	Species or species habitat may occur within area overfly marine area	In buffer area only
Calidris ferruginea Curlew Sandpiper [856]	Critically Endangered	Species or species habitat likely to occur within area overfly marine area	In feature area
Calidris melanotos Pectoral Sandpiper [858]		Species or species habitat known to occur within area overfly marine area	In feature area
Chalcites osculans as Chrysococcyx osculans Black-eared Cuckoo [83425]		Species or species habitat known to occur within area overfly marine area	In feature area
Charadrius leschenaultii Greater Sand Plover, Large Sand Plover [877]	Vulnerable	Species or species habitat may occur within area	In feature area
Diomedea antipodensis Antipodean Albatross [64458]	Vulnerable	Foraging, feeding or related behaviour likely to occur within area	In buffer area only

Scientific Name	Threatened Category	Presence Text	Buffer Status
Diomedea antipodensis gibsoni as Diomedea gibsoni Gibson's Albatross [82270]	Vulnerable	Foraging, feeding or related behaviour likely to occur within area	In buffer area only
Diomedea epomophora Southern Royal Albatross [89221]	Vulnerable	Foraging, feeding or related behaviour likely to occur within area	In buffer area only
Diomedea exulans Wandering Albatross [89223]	Vulnerable	Foraging, feeding or related behaviour likely to occur within area	In buffer area only
Diomedea sanfordi Northern Royal Albatross [64456]	Endangered	Species or species habitat may occur within area	In buffer area only
Gallinago hardwickii Latham's Snipe, Japanese Snipe [863]	Vulnerable	Species or species habitat known to occur within area overfly marine area	In feature area
Haliaeetus leucogaster White-bellied Sea-Eagle [943]		Species or species habitat known to occur within area	In feature area
Hirundapus caudacutus White-throated Needletail [682]	Vulnerable	Species or species habitat known to occur within area overfly marine area	In feature area
Lathamus discolor Swift Parrot [744]	Critically Endangered	Species or species habitat known to occur within area overfly marine area	In feature area
Limosa lapponica Bar-tailed Godwit [844]		Species or species habitat likely to occur within area	In buffer area only
Macronectes giganteus Southern Giant-Petrel, Southern Giant Petrel [1060]	Endangered	Species or species habitat may occur within area	In buffer area only

Scientific Name	Threatened Category	Presence Text	Buffer Status
Macronectes halli Northern Giant Petrel [1061]	Vulnerable	Foraging, feeding or related behaviour likely to occur within area	In buffer area only
Merops ornatus Rainbow Bee-eater [670]		Species or species habitat may occur within area overfly marine area	In feature area
Monarcha melanopsis Black-faced Monarch [609]		Species or species habitat known to occur within area overfly marine area	In feature area
Motacilla flava Yellow Wagtail [644]		Species or species habitat likely to occur within area overfly marine area	In feature area
Myiagra cyanoleuca Satin Flycatcher [612]		Species or species habitat known to occur within area overfly marine area	In feature area
Neophema chrysogaster Orange-bellied Parrot [747]	Critically Endangered	Species or species habitat may occur within area overfly marine area	In buffer area only
Neophema chrysostoma Blue-winged Parrot [726]	Vulnerable	Species or species habitat may occur within area overfly marine area	In feature area
Numenius madagascariensis Eastern Curlew, Far Eastern Curlew [847]	Critically Endangered	Species or species habitat likely to occur within area	In feature area
Pachyptila turtur Fairy Prion [1066]		Species or species habitat known to occur within area	In buffer area only
Pandion haliaetus Osprey [952]		Species or species habitat known to occur within area	In feature area

Scientific Name	Threatened Category	Presence Text	Buffer Status
Phaethon lepturus White-tailed Tropicbird [1014]		Species or species habitat may occur within area	In buffer area only
Pterodroma cervicalis White-necked Petrel [59642]		Species or species habitat may occur within area	In feature area
Rhipidura rufifrons Rufous Fantail [592]		Species or species habitat known to occur within area overfly marine area	In feature area
Rostratula australis as Rostratula benghalensis (sensu lato) Australian Painted Snipe [77037]	Endangered	Species or species habitat known to occur within area overfly marine area	In feature area
Sterna striata White-fronted Tern [799]		Migration route may occur within area	In feature area
Symposiachrus trivirgatus as Monarcha trivirgatus Spectacled Monarch [83946]		Species or species habitat may occur within area overfly marine area	In buffer area only
Thalassarche bulleri Buller's Albatross, Pacific Albatross [64460]	Vulnerable	Species or species habitat may occur within area	In buffer area only
Thalassarche bulleri platei as Thalassarche sp. nov. Northern Buller's Albatross, Pacific Albatross [82273]	Vulnerable	Species or species habitat may occur within area	In buffer area only
Thalassarche cauta Shy Albatross [89224]	Endangered	Foraging, feeding or related behaviour likely to occur within area	In buffer area only
Thalassarche eremita Chatham Albatross [64457]	Endangered	Foraging, feeding or related behaviour may occur within area	In buffer area only

Scientific Name	Threatened Category	Presence Text	Buffer Status
Thalassarche impavida Campbell Albatross, Campbell Black-browed Albatross [64459]	Vulnerable	Species or species habitat may occur within area	In buffer area only
Thalassarche melanophris Black-browed Albatross [66472]	Vulnerable	Foraging, feeding or related behaviour likely to occur within area	In buffer area only
Thalassarche salvini Salvin's Albatross [64463]	Vulnerable	Foraging, feeding or related behaviour likely to occur within area	In buffer area only
Thalassarche steadi White-capped Albatross [64462]	Vulnerable	Foraging, feeding or related behaviour known to occur within area	In buffer area only
Tringa nebularia Common Greenshank, Greenshank [832]	Endangered	Species or species habitat likely to occur within area overfly marine area	In feature area
Reptile			
Caretta caretta Loggerhead Turtle [1763]	Endangered	Species or species habitat likely to occur within area	In buffer area only
Chelonia mydas Green Turtle [1765]	Vulnerable	Species or species habitat known to occur within area	In buffer area only
Dermochelys coriacea Leatherback Turtle, Leathery Turtle, Luth [1768]	Endangered	Species or species habitat known to occur within area	In buffer area only
Eretmochelys imbricata Hawksbill Turtle [1766]	Vulnerable	Species or species habitat known to occur within area	In buffer area only
Natator depressus Flatback Turtle [59257]	Vulnerable	Species or species habitat known to occur within area	In buffer area only

Extra Information

State and Territory Reserves			[Resource Information]	
Protected Area Name	Reserve Type	State	Buffer Status	
Edmondson	Regional Park	NSW	In buffer area only	
Georges River	National Park	NSW	In buffer area only	
Leacock	Regional Park	NSW	In buffer area only	
Prospect	Nature Reserve	NSW	In buffer area only	
Nationally Important Wetlands			[Resource Information]	
Wetland Name		State	Buffer Status	
Liverpool Military Training Area		NSW	In buffer area only	
Voyager Point		NSW	In buffer area only	
EPBC Act Referrals			[Resource Information]	
Title of referral	Reference	Referral Outcome	Assessment Status	Buffer Status
Riverlands Shared Pathway	2023/09665		Completed	In buffer area only
Upper South Creek Advanced Water Recycling Centre	2020/8816		Post-Approval	In buffer area only
Controlled action				
construction of a regional scale stormwater detention basin, spillway and outlet	2011/5819	Controlled Action	Post-Approval	In buffer area only
Development of an Aged Care Facility	2007/3660	Controlled Action	Post-Approval	In buffer area only
Glenfield Waste Services recycling facility, Glenfield, NSW	2015/7529	Controlled Action	Assessment Approach	In buffer area only
Lot 102, Prestons ??? Industrial Warehouse Space	2021/9010	Controlled Action	Post-Approval	In buffer area only
Lyn Parade Extension	2004/1392	Controlled Action	Post-Approval	In feature area

Title of referral	Reference	Referral Outcome	Assessment Status	Buffer Status
Controlled action				
M12 Motorway Project, Luddenham, NSW	2018/8286	Controlled Action	Post-Approval	In buffer area only
Moorebank Avenue Realignment	2020/8839	Controlled Action	Post-Approval	In buffer area only
Moorebank Intermodal Terminal Facility	2011/6229	Controlled Action	Post-Approval	In buffer area only
Moorebank Intermodal Terminal Project	2011/6086	Controlled Action	Post-Approval	In buffer area only
Phase 2 of the Villawood Immigration Detention Facility Redevelopment Project	2011/5947	Controlled Action	Post-Approval	In buffer area only
Residential subdivision Lot 400 Strathyre Road, Prestons, NSW	2015/7627	Controlled Action	Post-Approval	In buffer area only
Sale of surplus land at Ingleburn	2007/3567	Controlled Action	Post-Approval	In buffer area only
South Sydney Freight Rail Line	2005/2393	Controlled Action	Post-Approval	In feature area
Widening three roads and construction of an access road to Bankstown Business Estate development	2016/7719	Controlled Action	Completed	In buffer area only
Not controlled action				
2A and 2B Mavis Street, Revesby	2020/8665	Not Controlled Action	Completed	In buffer area only
Boral Moorebank Quarry Rehabilitation	2000/115	Not Controlled Action	Completed	In buffer area only
Clearance of 6.3ha of Cumberland Plain Woodland for industrial subdivision cnr of Old Walgrove and W	2004/1445	Not Controlled Action	Completed	In buffer area only
Concrete Batching Plant and Associated Facilities	2005/2067	Not Controlled Action	Completed	In buffer area only
construct access road and install underground water main	2005/2299	Not Controlled Action	Completed	In buffer area only
construction of a road linking Newbridge Road and Nuwarra Road	2004/1843	Not Controlled Action	Completed	In feature area
Construction of Pipelines and Reservoirs at Ingleburn Army Camp as Part of the H	2009/4844	Not Controlled Action	Completed	In buffer area only

Title of referral	Reference	Referral Outcome	Assessment Status	Buffer Status
Not controlled action				
Decommissioning of the Australia Post Mail Distribution Centre	2002/612	Not Controlled Action	Completed	In buffer area only
Demobilisation of Lot 3001, Moorebank Intermodal Terminal, Liverpool, Sydney	2014/7152	Not Controlled Action	Completed	In buffer area only
Demolition and replacement of footbridge	2002/643	Not Controlled Action	Completed	In buffer area only
Demolition of redundant buildings at the Villawood Immigration Detention Centre	2001/403	Not Controlled Action	Completed	In buffer area only
Development of a car & truck parking area at the Boral site	2011/6134	Not Controlled Action	Completed	In buffer area only
Development of Surplus Land at the Potts Hill Reservoirs Site for Residential an	2009/4962	Not Controlled Action	Completed	In buffer area only
Electricity Substation at Old Wallgrove Road	2005/2220	Not Controlled Action	Completed	In buffer area only
Erection of a dwelling and associated access and infrastructure, 19 Tidswell Str	2003/1078	Not Controlled Action	Completed	In buffer area only
Extension to Lucas Heights production building	2003/1114	Not Controlled Action	Completed	In buffer area only
Former CSIRO Clunies Ross Research Station	2002/803	Not Controlled Action	Completed	In buffer area only
gas main installation from Eastern Creek to Erskine Park	2005/2235	Not Controlled Action	Completed	In buffer area only
Georges River Program 2	2003/999	Not Controlled Action	Completed	In feature area
Green Valley NSW residential development	2003/1236	Not Controlled Action	Completed	In buffer area only
Greenway Park Stage 3 residential subdivision	2004/1622	Not Controlled Action	Completed	In buffer area only
Holsworthy Redevelopment Project Program of Works	2004/1391	Not Controlled Action	Completed	In buffer area only
Hoxton Park Residential development	2011/6103	Not Controlled Action	Completed	In buffer area only
Improving rabbit biocontrol: releasing another strain of RHDV, sthrn two thirds of Australia	2015/7522	Not Controlled Action	Completed	In feature area
INDIGO Central Submarine Telecommunications Cable	2017/8127	Not Controlled Action	Completed	In feature area

Title of referral	Reference	Referral Outcome	Assessment Status	Buffer Status
Not controlled action				
Install Window Air-Conditioning Unit to Building 2, 361 Milperra Rd, Bankstown, NSW	2013/7107	Not Controlled Action	Completed	In buffer area only
Mountain View Classrooms Construction	2001/306	Not Controlled Action	Completed	In buffer area only
Playing Field Upgrade Cedar Road	2011/5950	Not Controlled Action	Completed	In buffer area only
Residential development at Doonside Crescent Woodcroft, Blacktown LGA	2004/1378	Not Controlled Action	Completed	In buffer area only
Residential Development in Edmonston Park	2009/4832	Not Controlled Action	Completed	In buffer area only
Residential Subdivision Braidwood Drive	2011/5940	Not Controlled Action	Completed	In buffer area only
Residential subdivision works, Spurway St, Ermington	2003/1130	Not Controlled Action	Completed	In buffer area only
Rezoning & Disposal of Quakers Hill property	2001/281	Not Controlled Action	Completed	In buffer area only
Shipment of Spent Nuclear Fuel to USA	2007/3672	Not Controlled Action	Completed	In buffer area only
Site remediation and waste disposal	2002/837	Not Controlled Action	Completed	In buffer area only
Staged Revelopment of Riverlands Golf Club Site	2008/4464	Not Controlled Action	Completed	In buffer area only
subdivision and development on the Rhodes Peninsula for residential and commerci	2003/1249	Not Controlled Action	Completed	In buffer area only
Subdivision of Residential Lands, Greystanes Estate, western Sydney	2001/499	Not Controlled Action	Completed	In buffer area only
Sydney Primary Loop Gas Pipeline	2006/2622	Not Controlled Action	Completed	In buffer area only
Widening of the M5 Southwest Motorway	2010/5665	Not Controlled Action	Completed	In buffer area only
Wonderland Business Park Precinct, Stage 1, Lot D1	2004/1626	Not Controlled Action	Completed	In buffer area only
Not controlled action (particular manner)				
INDIGO Marine Cable Route Survey (INDIGO)	2017/7996	Not Controlled Action (Particular Manner)	Post-Approval	In feature area

Title of referral	Reference	Referral Outcome	Assessment Status	Buffer Status
Not controlled action (particular manner)				
Moorebank Units Relocation Project, Holsworthy Training Area, NSW	2012/6462	Not Controlled Action (Particular Manner)	Post-Approval	In buffer area only
Villawood Immigration Detention Centre Redevelopment	2006/2725	Not Controlled Action (Particular Manner)	Post-Approval	In buffer area only
Referral decision				
Keyhole Site Horsley Park	2021/9000	Referral Decision	Referral Publication	In buffer area only
Northern Expansion of the Camden Gas Project	2012/6638	Referral Decision	Completed	In buffer area only
Bioregional Assessments			[Resource Information]	
SubRegion	BioRegion	Website	Buffer Status	
Sydney	Sydney Basin	BA website	In feature area	

Caveat

1 PURPOSE

This report is designed to assist in identifying the location of matters of national environmental significance (MNES) and other matters protected by the Environment Protection and Biodiversity Conservation Act 1999 (Cth) (EPBC Act) which may be relevant in determining obligations and requirements under the EPBC Act.

The report contains the mapped locations of:

- World and National Heritage properties;
- Wetlands of International and National Importance;
- Commonwealth and State/Territory reserves;
- distribution of listed threatened, migratory and marine species;
- listed threatened ecological communities; and
- other information that may be useful as an indicator of potential habitat value.

2 DISCLAIMER

This report is not intended to be exhaustive and should only be relied upon as a general guide as mapped data is not available for all species or ecological communities listed under the EPBC Act (see below). Persons seeking to use the information contained in this report to inform the referral of a proposed action under the EPBC Act should consider the limitations noted below and whether additional information is required to determine the existence and location of MNES and other protected matters.

Where data are available to inform the mapping of protected species, the presence type (e.g. known, likely or may occur) that can be determined from the data is indicated in general terms. It is the responsibility of any person using or relying on the information in this report to ensure that it is suitable for the circumstances of any proposed use. The Commonwealth cannot accept responsibility for the consequences of any use of the report or any part thereof. To the maximum extent allowed under governing law, the Commonwealth will not be liable for any loss or damage that may be occasioned directly or indirectly through the use of, or reliance

3 DATA SOURCES

Threatened ecological communities

For threatened ecological communities where the distribution is well known, maps are generated based on information contained in recovery plans, State vegetation maps and remote sensing imagery and other sources. Where threatened ecological community distributions are less well known, existing vegetation maps and point location data are used to produce indicative distribution maps.

Threatened, migratory and marine species

Threatened, migratory and marine species distributions have been discerned through a variety of methods. Where distributions are well known and if time permits, distributions are inferred from either thematic spatial data (i.e. vegetation, soils, geology, elevation, aspect, terrain, etc.) together with point locations and described habitat; or modelled (MAXENT or BIOCLIM habitat modelling) using

Where little information is available for a species or large number of maps are required in a short time-frame, maps are derived either from 0.04 or 0.02 decimal degree cells; by an automated process using polygon capture techniques (static two kilometre grid cells, alpha-hull and convex hull); or captured manually or by using topographic features (national park boundaries, islands, etc.).

In the early stages of the distribution mapping process (1999-early 2000s) distributions were defined by degree blocks, 100K or 250K map sheets to rapidly create distribution maps. More detailed distribution mapping methods are used to update these distributions

4 LIMITATIONS

The following species and ecological communities have not been mapped and do not appear in this report:

- threatened species listed as extinct or considered vagrants;
- some recently listed species and ecological communities;
- some listed migratory and listed marine species, which are not listed as threatened species; and
- migratory species that are very widespread, vagrant, or only occur in Australia in small numbers.

The following groups have been mapped, but may not cover the complete distribution of the species:

- listed migratory and/or listed marine seabirds, which are not listed as threatened, have only been mapped for recorded
- seals which have only been mapped for breeding sites near the Australian continent

The breeding sites may be important for the protection of the Commonwealth Marine environment.

Refer to the metadata for the feature group (using the Resource Information link) for the currency of the information.

Acknowledgements

This database has been compiled from a range of data sources. The department acknowledges the following custodians who have contributed valuable data and advice:

- [-Office of Environment and Heritage, New South Wales](#)
- [-Department of Environment and Primary Industries, Victoria](#)
- [-Department of Primary Industries, Parks, Water and Environment, Tasmania](#)
- [-Department of Environment, Water and Natural Resources, South Australia](#)
- [-Department of Land and Resource Management, Northern Territory](#)
- [-Department of Environmental and Heritage Protection, Queensland](#)
- [-Department of Parks and Wildlife, Western Australia](#)
- [-Environment and Planning Directorate, ACT](#)
- [-Birdlife Australia](#)
- [-Australian Bird and Bat Banding Scheme](#)
- [-Australian National Wildlife Collection](#)
- [-Natural history museums of Australia](#)
- [-Museum Victoria](#)
- [-Australian Museum](#)
- [-South Australian Museum](#)
- [-Queensland Museum](#)
- [-Online Zoological Collections of Australian Museums](#)
- [-Queensland Herbarium](#)
- [-National Herbarium of NSW](#)
- [-Royal Botanic Gardens and National Herbarium of Victoria](#)
- [-Tasmanian Herbarium](#)
- [-State Herbarium of South Australia](#)
- [-Northern Territory Herbarium](#)
- [-Western Australian Herbarium](#)
- [-Australian National Herbarium, Canberra](#)
- [-University of New England](#)
- [-Ocean Biogeographic Information System](#)
- [-Australian Government, Department of Defence](#)
- [Forestry Corporation, NSW](#)
- [-Geoscience Australia](#)
- [-CSIRO](#)
- [-Australian Tropical Herbarium, Cairns](#)
- [-eBird Australia](#)
- [-Australian Government – Australian Antarctic Data Centre](#)
- [-Museum and Art Gallery of the Northern Territory](#)
- [-Australian Government National Environmental Science Program](#)
- [-Australian Institute of Marine Science](#)
- [-Reef Life Survey Australia](#)
- [-American Museum of Natural History](#)
- [-Queen Victoria Museum and Art Gallery, Inveresk, Tasmania](#)
- [-Tasmanian Museum and Art Gallery, Hobart, Tasmania](#)
- [-Other groups and individuals](#)

The Department is extremely grateful to the many organisations and individuals who provided expert advice and information on numerous draft distributions.

Please feel free to provide feedback via the [Contact us](#) page.

[© Commonwealth of Australia](#)

Department of Climate Change, Energy, the Environment and Water

GPO Box 3090

Canberra ACT 2601 Australia

+61 2 6274 1111

APPENDIX B
LIKELIHOOD OF OCCURRENCE

COMMERCIAL IN CONFIDENCE





Recorded The species was observed in the study area during the current survey.	
High	It is highly likely that a species inhabits the study area and is dependent on identified suitable habitat (i.e., for breeding or important life cycle periods such as winter flowering resources), has been recorded recently in the locality (10km) and is known or likely to maintain resident populations in the study area. Also includes species known or likely to visit the study area during regular seasonal movements or migration.
Moderate	Potential habitat is present in the study area. Species unlikely to maintain sedentary populations, however, may seasonally use resources within the study area opportunistically or during migration. The species is unlikely to be dependent (i.e., for breeding or important life cycle periods such as winter flowering resources) on habitat within the study area, or habitat is in a modified or degraded state. Includes cryptic flowering flora species that were not seasonally targeted by surveys and that have not been recorded.
Low	It is unlikely that the species inhabits the study area and has not been recorded recently in the locality (10km). It may be an occasional visitor, but habitat similar to the study area is widely distributed in the local area, meaning that the species is not dependent (i.e., for breeding or important life cycle periods such as winter flowering resources) on available habitat. Specific habitat is not present in the study area, or the species are a non-cryptic perennial flora species that were specifically targeted by surveys and not recorded.
None	Suitable habitat is absent from the study area.

Class	Family	Scientific Name	Common Name	NSW status	Comm .status	Records	Description	Likelihood
Amphibia	Myobatrachidae	<i>Pseudophryne australis</i>	Red-crowned Toadlet	V,P		7	Occurs in open forests, mostly on Hawkesbury and Narrabeen Sandstones. Inhabits periodically wet drainage lines below sandstone ridges that often have shale lenses or cappings. Shelters under rocks and amongst masses of dense vegetation or thick piles of leaf litter.	Low
	Hylidae	<i>Litoria aurea</i>	Green and Golden Bell Frog	E1,P	V	2646	Inhabits marshes, dams and stream-sides, particularly those containing bullrushes (<i>Typha spp.</i>) or spikerushes (<i>Eleocharis spp.</i>). Optimum habitat includes waterbodies that are unshaded, free of predatory fish such as Plague Minnow (<i>Gambusia holbrooki</i>), have a grassy area nearby and diurnal sheltering sites available. Some sites, particularly in the Greater Sydney region occur in highly disturbed areas.	Low



Class	Family	Scientific Name	Common Name	NSW status	Comm .status	Records	Description	Likelihood
Aves	Anatidae	<i>Stictonetta naevosa</i>	Freckled Duck	V,P		1	The Freckled Duck is found primarily in south-eastern and south-western Australia, occurring as a vagrant elsewhere. Prefer permanent freshwater swamps and creeks with heavy growth of Cumbungi, Lignum or Tea-tree. During drier times they move from ephemeral breeding swamps to more permanent waters such as lakes, reservoirs, farm dams and sewage ponds.	Low
	Apodidae	<i>Apus pacificus</i>	Fork-tailed Swift	P	C,J,K	2	They mostly occur over inland plains but sometimes above foothills or in coastal areas. They often occur over cliffs and beaches and also over islands and sometimes well out to sea. They also occur over settled areas, including towns, urban areas and cities. They mostly occur over dry or open habitats, including riparian woodland and tea-tree swamps, low scrub, heathland or saltmarsh. They are also found at treeless grassland and sandplains covered with spinifex, open farmland and inland and coastal sand-dunes. The sometimes occur above rainforests, wet sclerophyll forest or open forest or plantations of pines.	Low
	Apodidae	<i>Hirundapus caudacutus</i>	White-throated Needletail	P	V,C,J,K	22	They are recorded most often above wooded areas, including open forest and rainforest, and may also fly between trees or in clearings, below the canopy. They also commonly occur over heathland, but less often over treeless areas, such as grassland or swamps. When flying above farmland, they are more often recorded above partly cleared pasture, plantations or remnant vegetation at the edge of paddocks. In coastal areas, they are seen flying over sandy beaches or mudflats, and often around coastal cliffs and other areas with prominent updraughts, such as ridges and sand-dunes. They are sometimes recorded above islands well out to sea.	Low



Class	Family	Scientific Name	Common Name	NSW status	Comm .status	Records	Description	Likelihood
	Ardeidae	<i>Botaurus poiciloptilus</i>	Australasian Bittern	E1,P	E	3	Favours permanent freshwater wetlands with tall, dense vegetation, particularly bullrushes (<i>Typha spp.</i>) and spikerushes (<i>Eleocharis spp.</i>). Hides during the day amongst dense reeds or rushes and feed mainly at night on frogs, fish, yabbies, spiders, insects and snails.	Low
	Ardeidae	<i>Ixobrychus flavicollis</i>	Black Bittern	V,P		2	Inhabits both terrestrial and estuarine wetlands, generally in areas of permanent water and dense vegetation. Where permanent water is present, the species may occur in flooded grassland, forest, woodland, rainforest and mangroves.	Low
	Accipitrid ae	<i>Circus assimilis</i>	Spotted Harrier	V,P		1	Occurs in grassy open woodland including Acacia and mallee remnants, inland riparian woodland, grassland and shrub steppe. It is found most commonly in native grassland, but also occurs in agricultural land, foraging over open habitats including edges of inland wetlands. Builds a stick nest in a tree and lays eggs in spring (or sometimes autumn), with young remaining in the nest for several months.	Low
	Accipitrid ae	<i>Haliaeetus leucogaster</i>	White-bellied Sea-Eagle	V,P		99	Habitats are characterised by the presence of large areas of open water including larger rivers, swamps, lakes, and the sea. Occurs at sites near the sea or sea-shore, such as around bays and inlets, beaches, reefs, lagoons, estuaries and mangroves; and at, or in the vicinity of freshwater swamps, lakes, reservoirs, billabongs and saltmarsh. Terrestrial habitats include coastal dunes, tidal flats, grassland, heathland, woodland, and forest (including rainforest).	Low
	Accipitrid ae	<i>Hieraaetus morphnoides</i>	Little Eagle	V,P		4	Occupies open eucalypt forest, woodland or open woodland. Sheoak or Acacia woodlands and riparian woodlands of interior NSW are also used. Nests in tall living trees within a remnant patch, where pairs build a large stick nest in winter.	Low



Class	Family	Scientific Name	Common Name	NSW status	Comm .status	Records	Description	Likelihood
	Accipitridae	<i>Pandion cristatus</i>	Eastern Osprey	V,P,3		5	Favour coastal areas, especially the mouths of large rivers, lagoons and lakes. Feed on fish over clear, open water. Breed from July to September in NSW. Nests are made high up in dead trees or in dead crowns of live trees, usually within one kilometre of the sea.	Low
	Charadriidae	<i>Pluvialis fulva</i>	Pacific Golden Plover	P	C,J,K	6	Within Australia, the Pacific Golden Plover is widespread in coastal regions, though there are also a number of inland records (in all states), sometimes far inland and usually along major river systems, especially the Murray and Darling Rivers and their tributaries. Most Pacific Golden Plovers occur along the east coast, and are especially widespread along the Queensland and NSW coastlines. In non-breeding grounds in Australia this species usually inhabits coastal habitats, though it occasionally occurs around inland wetlands	Low
	Rostratulidae	<i>Rostratula australis</i>	Australian Painted Snipe	E1,P	E	1	Prefers fringes of swamps, dams and nearby marshy areas where there is a cover of grasses, lignum, low scrub or open timber. Nests on the ground amongst tall vegetation, such as grasses, tussocks or reeds.	Low
	Scolopacidae	<i>Actitis hypoleucos</i>	Common Sandpiper	P	C,J,K	3	Found along all coastlines of Australia and in many areas inland, the Common Sandpiper is widespread in small numbers. The population when in Australia is concentrated in northern and western Australia	Low
	Scolopacidae	<i>Calidris acuminata</i>	Sharp-tailed Sandpiper	P	C,J,K	146	The Sharp-tailed Sandpiper spends the non-breeding season in Australia with small numbers occurring regularly in New Zealand. Most of the population migrates to Australia, mostly to the south-east and are widespread in both inland and coastal locations and in both freshwater and saline habitats.	Low



Class	Family	Scientific Name	Common Name	NSW status	Comm .status	Records	Description	Likelihood
	Scolopacidae	<i>Calidris canutus</i>	Red Knot	P	E,C,J,K	1	In NSW the Red Knot mainly occurs in small numbers on intertidal mudflats, estuaries, bays, inlets, lagoons, harbours and sandflats and sandy beaches of sheltered coasts. It is occasionally found on sandy ocean beaches or shallow pools on exposed wave-cut rock platforms and is a rare visitor to terrestrial saline wetlands and freshwater swamps. It usually forages near the water's edge, with feeding activity regulated by the tide as birds closely follow the tide-edge.	Low
	Scolopacidae	<i>Calidris ferruginea</i>	Curlew Sandpiper	E4A,P	CE,C,J,K	3	It generally occupies littoral and estuarine habitats, and in New South Wales is mainly found in intertidal mudflats of sheltered coasts. It also occurs in non-tidal swamps, lakes and lagoons on the coast and sometimes inland. It forages in or at the edge of shallow water, occasionally on exposed algal mats or waterweed, or on banks of beach-cast seagrass or seaweed.	Low
	Scolopacidae	<i>Calidris ruficollis</i>	Red-necked Stint	P	C,J,K	1	It is distributed along most of the Australian coastline with large densities on the Victorian and Tasmanian coasts. The Red-necked Stint has been recorded in all coastal regions, and found inland in all states when conditions are suitable.	Low
	Scolopacidae	<i>Calidris tenuirostris</i>	Great Knot	V,P	V,C,J,K	1	Occurs within sheltered, coastal habitats containing large, intertidal mudflats or sandflats, including inlets, bays, harbours, estuaries and lagoons. Often recorded on sandy beaches with mudflats nearby, sandy spits and islets and sometimes on exposed reefs or rock platforms.	Low
	Scolopacidae	<i>Gallinago hardwickii</i>	Latham's Snipe	V,P	V,J,K	435	In Australia, Latham's Snipe occurs in permanent and ephemeral wetlands up to 2000 m above sea-level (Chapman 1969; Naarding 1981). They usually inhabit open, freshwater wetlands with low, dense vegetation (e.g. swamps, flooded grasslands or heathlands, around bogs and other water bodies)	Low



Class	Family	Scientific Name	Common Name	NSW status	Comm .status	Records	Description	Likelihood
	Scolopaci dae	<i>Limicola falcinellus</i>	Broad-billed Sandpiper	V,P	C,J,K	1	Broad-billed Sandpipers favour sheltered parts of the coast such as estuarine sandflats and mudflats, harbours, embayments, lagoons, saltmarshes and reefs as feeding and roosting habitat. Occasionally, individuals may be recorded in sewage farms or within shallow freshwater lagoons. Broad-billed Sandpipers roost on banks on sheltered sand, shell or shingle beaches.	Low
	Scolopaci dae	<i>Limosa lapponica</i>	Bar-tailed Godwit	P	C,J,K	71	It is found mainly in coastal habitats such as large intertidal sandflats, banks, mudflats, estuaries, inlets, harbours, coastal lagoons and bays. Less frequently it occurs in salt lakes and brackish wetlands, sandy ocean beaches and rock platforms. It often occurs around beds of seagrass, and sometimes in nearby saltmarsh or the outer margins of mangrove areas. In NSW its high tide roost areas on sandy beaches, sandbars, spits and near-coastal saltmarsh are frequently shared with other shorebirds. It is rarely found on inland wetlands or in areas of short grass such as farmland, paddocks and airstrips.	Low
	Scolopaci dae	<i>Limosa limosa</i>	Black-tailed Godwit	V,P	E,C,J,K	1	Primarily a coastal species. Usually found in sheltered bays, estuaries and lagoons with large intertidal mudflats and/or sandflats. Further inland, it can also be found on mudflats and in water less than 10 cm deep, around muddy lakes and swamps. Individuals have been recorded in wet fields and sewerage treatment works.	Low



Class	Family	Scientific Name	Common Name	NSW status	Comm .status	Records	Description	Likelihood
	Scolopacidae	<i>Numenius madagascariensis</i>	Eastern Curlew	P	CE,C,J,K	2	It generally occupies coastal lakes, inlets, bays and estuarine habitats, and in New South Wales is mainly found in intertidal mudflats and sometimes saltmarsh of sheltered coasts. Occasionally, the species occurs on ocean beaches (often near estuaries), and coral reefs, rock platforms, or rocky islets. It forages in or at the edge of shallow water, occasionally on exposed algal mats or waterweed, or on banks of beach-cast seagrass or seaweed. It roosts on sandy spits and islets, especially on dry beach sand near the high-water mark, and among coastal vegetation including low saltmarsh or mangroves. May also roost on wooden oyster leases or other similar structures.	Low
	Scolopacidae	<i>Tringa brevipes</i>	Grey-tailed Tattler	P	C,J,K	1	In NSW the Grey-tailed Tattler is distributed along most of the coast from the Queensland border, south to Tilba Lake. It is more heavily distributed along coastal regions north of Sydney.	Low
	Scolopacidae	<i>Tringa stagnatilis</i>	Marsh Sandpiper	P	C,J,K	1	The Marsh Sandpiper is found on coastal and inland wetlands throughout Australia. It is recorded in all regions of NSW but especially the central and south coasts and (inland) on the western slopes of Great Divide and western plains.	Low
	Laridae	<i>Hydroprogne caspia</i>	Caspian Tern	P	J	42	Widespread east of the Great Divide, mainly in coastal regions, and also in the Riverina and Lower and Upper Western Regions, with occasional records elsewhere. Breeding is recorded from the Menindee Lakes.	Low



Class	Family	Scientific Name	Common Name	NSW status	Comm .status	Records	Description	Likelihood
	Laridae	<i>Sterna hirundo</i>	Common Tern	P	C,J,K	1	In Australia, Common Terns are mainly found along the eastern coast, where they are widespread and common from south-eastern Queensland to eastern Victoria. They are recorded in all marine zones, but are commonly observed in near-coastal waters, both on ocean beaches, platforms and headlands and in sheltered waters, such as bays, harbours and estuaries with muddy, sandy or rocky shores.	Low
	Cacatuidae	<i>Calyptorhynchus lathami lathami</i>	South-eastern Glossy Black-Cockatoo	V,P,2	V	1	Inhabits open forest and woodlands of the coast and the Great Dividing Range where stands of sheoak occur. Black Sheoak (<i>Allocasuarina littoralis</i>) and Forest Sheoak (<i>A. torulosa</i>) are important foods. Inland populations feed on a wide range of sheoaks, including Drooping Sheoak, <i>Allocasuarina diminuta</i> , and <i>A. gymnanthera</i> . Belah is also utilised and may be a critical food source for some populations. Feeds almost exclusively on the seeds of several species of she-oak (<i>Casuarina</i> and <i>Allocasuarina</i> species), shredding the cones with the massive bill. Dependent on large hollow-bearing eucalypts for nest sites. A single egg is laid between March and May.	Low
	Psittacidae	<i>Glossopsitta pusilla</i>	Little Lorikeet	V,P		10	Forages primarily in the canopy of open Eucalyptus forest and woodland, yet also finds food in Angophora, Melaleuca and other tree species. Riparian habitats are particularly used, due to higher soil fertility and hence greater productivity. Isolated flowering trees in open country, e.g. paddocks, roadside remnants and urban trees also help sustain viable populations of the species. Feeds mostly on nectar and pollen, occasionally on native fruits such as mistletoe, and only rarely in orchards	Low



Class	Family	Scientific Name	Common Name	NSW status	Comm .status	Records	Description	Likelihood
	Psittacidae	<i>Lathamus discolor</i>	Swift Parrot	E1,P	CE	7	Migrates to the Australian south-east mainland between February and October. On the mainland they occur in areas where eucalypts are flowering profusely or where there are abundant lerp (from sap-sucking bugs) infestations. Favoured feed trees include winter flowering species such as Swamp Mahogany <i>Eucalyptus robusta</i> , Spotted Gum <i>Corymbia maculata</i> , Red Bloodwood <i>C. gummifera</i> , Forest Red Gum <i>E. tereticornis</i> , Mugga Ironbark <i>E. sideroxylon</i> , and White Box <i>E. albens</i> . Commonly used lerp infested trees include Inland Grey Box <i>E. microcarpa</i> , Grey Box <i>E. moluccana</i> , Blackbutt <i>E. pilularis</i> , and Yellow Box <i>E. melliodora</i> .	Low
	Strigidae	<i>Ninox strenua</i>	Powerful Owl	V,P,3		230	The Powerful Owl inhabits a range of vegetation types, from woodland and open sclerophyll forest to tall open wet forest and rainforest. The Powerful Owl requires large tracts of forest or woodland habitat but can occur in fragmented landscapes as well. The species breeds and hunts in open or closed sclerophyll forest or woodlands and occasionally hunts in open habitats. It roosts by day in dense vegetation comprising species such as Turpentine <i>Syncarpia glomulifera</i> , Black She-oak <i>Allocasuarina littoralis</i> , Blackwood <i>Acacia melanoxylon</i> , Rough-barked Apple <i>Angophora floribunda</i> , Cherry Ballart <i>Exocarpos cupressiformis</i> and a number of eucalypt species.	Low
	Tytonidae	<i>Tyto longimembris</i>	Eastern Grass Owl	V,P,3		1	Eastern Grass Owls are found in areas of tall grass, including grass tussocks, in swampy areas, grassy plains, swampy heath, and in cane grass or sedges on flood plains. They rest by day in a 'form' - a trampled platform in a large tussock or other heavy vegetative growth.	Low



Class	Family	Scientific Name	Common Name	NSW status	Comm .status	Records	Description	Likelihood
	Meliphagi dae	<i>Anthochaera phrygia</i>	Regent Honeyeater	E4A,P, 2	CE	1	The species inhabits dry open forest and woodland, particularly Box-Ironbark woodland, and riparian forests of River Sheoak. Regent Honeyeaters inhabit woodlands that support a significantly high abundance and species richness of bird species. These woodlands have significantly large numbers of mature trees, high canopy cover and abundance of mistletoes.	Low
	Meliphagi dae	<i>Epthianura albifrons</i>	White-fronted Chat population in the Sydney Metropolitan Catchment Management Area	E2,V,P		14	Gregarious species, usually found foraging on bare or grassy ground in wetland areas, singly or in pairs. They are insectivorous, feeding mainly on flies and beetles caught from or close to the ground. Have been observed breeding from late July through to early March, with 'open-cup' nests built in low vegetation. Nests in the Sydney region have also been seen in low isolated mangroves. Nests are usually built about 23 cm above the ground (but have been found up to 2.5 m above the ground).	Low
	Artamida e	<i>Artamus cyanopterus cyanopterus</i>	Dusky Woodswallow	V,P		5	Primarily inhabit dry, open eucalypt forests and woodlands, including mallee associations, with an open or sparse understorey of eucalypt saplings, acacias and other shrubs, and ground-cover of grasses or sedges and fallen woody debris. It has also been recorded in shrublands, heathlands and very occasionally in moist forest or rainforest. Also found in farmland, usually at the edges of forest or woodland.	Low



Class	Family	Scientific Name	Common Name	NSW status	Comm .status	Records	Description	Likelihood
	Petroicidae	<i>Petroica boodang</i>	Scarlet Robin	V,P		1	The Scarlet Robin lives in dry eucalypt forests and woodlands. The understorey is usually open and grassy with few scattered shrubs. This species lives in both mature and regrowth vegetation. It occasionally occurs in mallee or wet forest communities, or in wetlands and tea-tree swamps. The Scarlet Robin breeds on ridges, hills and foothills of the western slopes, the Great Dividing Range and eastern coastal regions; this species is occasionally found up to 1000 metres in altitude. The Scarlet Robin is primarily a resident in forests and woodlands, but some adults and young birds disperse to more open habitats after breeding. In autumn and winter many Scarlet Robins live in open grassy woodlands, and grasslands or grazed paddocks with scattered trees.	Low
	Petroicidae	<i>Petroica phoenicea</i>	Flame Robin	V,P		1	Breeds in upland tall moist eucalypt forests and woodlands, often on ridges and slopes. Prefers clearings or areas with open understoreys. The ground layer of the breeding habitat is dominated by native grasses and the shrub layer may be either sparse or dense. Occasionally occurs in temperate rainforest, and also in herb fields, heathlands, shrublands and sedgeland at high altitudes. In winter, occasionally seen in heathland or other shrublands in coastal areas.	Low
	Motacillidae	<i>Motacilla flava</i>	Yellow Wagtail	P	C,J,K	1	Yellow Wagtails are migrants from the Northern Hemisphere to Australia. There are few sightings in southern Australia although in recent years, the wetlands of the Hunter River estuary in NSW have proved to be a reliable area to see them.	Low



Class	Family	Scientific Name	Common Name	NSW status	Comm .status	Records	Description	Likelihood
Mammalia	Dasyuridae	<i>Dasyurus maculatus</i>	Spotted-tailed Quoll	V,P	E	1	Recorded across a range of habitat types, including rainforest, open forest, woodland, coastal heath and inland riparian forest, from the sub-alpine zone to the coastline. Individual animals use hollow-bearing trees, fallen logs, small caves, rock outcrops and rocky-cliff faces as den sites.	Low
	Phascolarctidae	<i>Phascolarctos cinereus</i>	Koala	E1,P	E	3	Inhabit eucalypt woodlands and forests. Feed on the foliage of more than 70 eucalypt species and 30 non-eucalypt species, but in any one area will select preferred browse species.	Low
	Pseudochiridae	<i>Petauroides volans</i>	Southern Greater Glider	E1,P	E	1	The greater glider is an arboreal nocturnal marsupial, largely restricted to eucalypt forests and woodlands. It is primarily florivorous, with a diet mostly comprising eucalypt leaves, and occasionally flowers. It is typically found in highest abundance in taller, montane, moist eucalypt forests with relatively old trees and abundant hollows. The distribution may be patchy even in suitable habitat. The greater glider favours forests with a diversity of eucalypt species, due to seasonal variation in its preferred tree species.	Low
	Pteropodidae	<i>Pteropus poliocephalus</i>	Grey-headed Flying-fox	V,P	V	226	Occur in subtropical and temperate rainforests, tall sclerophyll forests and woodlands, heaths and swamps as well as urban gardens and cultivated fruit crops. Roosting camps are generally located within 20 km of a regular food source and are commonly found in gullies, close to water, in vegetation with a dense canopy.	Low
	Emballonuridae	<i>Saccolaimus flaviventris</i>	Yellow-bellied Sheath-tail-bat	V,P		12	Roosts singly or in groups of up to six, in tree hollows and buildings; in treeless areas they are known to utilise mammal burrows. When foraging for insects, flies high and fast over the forest canopy, but lower in more open country. Forages in most habitats across its very wide range, with and without trees; appears to defend an aerial territory.	Low



Class	Family	Scientific Name	Common Name	NSW status	Comm .status	Records	Description	Likelihood
	Molossidae	<i>Micronomus norfolkensis</i>	Eastern Coastal Free-tailed Bat	V,P		4	Occur in dry sclerophyll forest, woodland, swamp forests and mangrove forests east of the Great Dividing Range. Roost mainly in tree hollows but will also roost under bark or in man-made structures.	Low
	Vespertilionidae	<i>Chalinolobus dwyeri</i>	Large-eared Pied Bat	V,P	V	4	Roosts in caves (near their entrances), crevices in cliffs, old mine workings and in the disused, bottle-shaped mud nests of the Fairy Martin (<i>Petrochelidon ariel</i>), frequenting low to mid-elevation dry open forest and woodland close to these features. Females have been recorded raising young in maternity roosts (c. 20-40 females) from November through to January in roof domes in sandstone caves and overhangs. They remain loyal to the same cave over many years. Found in well-timbered areas containing gullies.	Low
	Vespertilionidae	<i>Falsistrellus tasmaniensis</i>	Eastern False Pipistrelle	V,P		3	Prefers moist habitats, with trees taller than 20 m. Generally roosts in eucalypt hollows, but has also been found under loose bark on trees or in buildings.	Low
	Vespertilionidae	<i>Myotis macropus</i>	Southern Myotis	V,P		50	Generally roost in groups of 10 - 15 close to water in caves, mine shafts, hollow-bearing trees, storm water channels, buildings, under bridges and in dense foliage.	Low
	Vespertilionidae	<i>Scoteanax rueppellii</i>	Greater Broad-nosed Bat	V,P		3	Utilises a variety of habitats from woodland through to moist and dry eucalypt forest and rainforest, though it is most commonly found in tall wet forest. Although this species usually roosts in tree hollows, it has also been found in buildings. Open woodland habitat and dry open forest suits the direct flight of this species as it searches for beetles and other large, slow-flying insects; this species has been known to eat other bat species.	Low



Class	Family	Scientific Name	Common Name	NSW status	Comm .status	Records	Description	Likelihood
	Miniopteridae	<i>Miniopterus australis</i>	Little Bent-winged Bat	V,P		14	Moist eucalypt forest, rainforest, vine thicket, wet and dry sclerophyll forest, Melaleuca swamps, dense coastal forests and banksia scrub. Generally found in well-timbered areas. Little Bentwing-bats roost in caves, tunnels, tree hollows, abandoned mines, stormwater drains, culverts, bridges and sometimes buildings during the day, and at night forage for small insects beneath the canopy of densely vegetated habitats..	Low
	Miniopteridae	<i>Miniopterus orianae oceanensis</i>	Large Bent-winged Bat	V,P		92	Caves are the High roosting habitat, but also use derelict mines, storm-water tunnels, buildings and other man-made structures. Form discrete populations centred on a maternity cave that is used annually in spring and summer for the birth and rearing of young. Maternity caves have very specific temperature and humidity regimes. Cold caves are used for hibernation in southern Australia.	Low
Gastropoda	Camaenidae	<i>Pommerhelix duralensis</i>	Dural Land Snail	E1	E	15	The species has a strong affinity for communities in the interface region between shale-derived and sandstone-derived soils, with forested habitats that have good native cover and woody debris. It favours sheltering under rocks or inside curled-up bark. It does not burrow nor climb. The species has also been observed resting in exposed areas, such as on exposed rock or leaf litter, however it will also shelter beneath leaves, rocks and light woody debris.	Low



Class	Family	Scientific Name	Common Name	NSW status	Comm .status	Records	Description	Likelihood
Flora	Campanulaceae	<i>Wahlenbergia multicaulis</i>	Tadgell's Bluebell in the local government areas of Auburn, Bankstown, Baulkham Hills, Canterbury, Hornsby, Parramatta and Strathfield	E2		1	In Western Sydney most sites are closely aligned with the Villawood Soil Series, which is a poorly drained, yellow podsolic extensively permeated with fine, concretionary ironstone (laterite). However, the sites in Hornsby LGA are on the 'Hawkesbury' soil landscape. Found in disturbed sites and grows in a variety of habitats including forest, woodland, scrub, grassland and the edges of watercourses and wetlands. Typically occurs in damp, disturbed sites (with natural or human disturbance of various forms), typically amongst other herbs rather than in the open. In Hornsby LGA it occurs in or adjacent to sandstone gully forest. In Western Sydney it is found in remnants of Cooks River/ Castlereagh Ironbark Forest.	Low
	Convolvulaceae	<i>Wilsonia backhousei</i>	Narrow-leafed Wilsonia	V		36	This is a species of the margins of salt marshes and lakes.	
	Ericaceae	<i>Epacris purpurascens</i> var. <i>purpurascens</i>		V		20	Recorded from Gosford in the north, to Narrabeen in the east, Silverdale in the west and Avon Dam vicinity in the South. Found in a range of habitat types, most of which have a strong shale soil influence.	Low



Class	Family	Scientific Name	Common Name	NSW status	Comm .status	Records	Description	Likelihood
	Fabaceae (Faboidea e)	<i>Dillwynia tenuifolia</i>		V		1	In western Sydney, may be locally abundant particularly within scrubby/dry heath areas within Castlereagh Ironbark Forest and Shale Gravel Transition Forest on tertiary alluvium or laterised clays. May also be common in transitional areas where these communities adjoin Castlereagh Scribbly Gum Woodland. At Yengo, is reported to occur in disturbed escarpment woodland on Narrabeen sandstone. Eucalyptus fibrosa is usually the dominant canopy species. <i>Eucalyptus globoidea</i> , <i>E. longifolia</i> , <i>E. parramattensis</i> , <i>E. sclerophylla</i> and <i>E. sideroxylon</i> may also be present or codominant, with <i>Melaleuca decora</i> frequently forming a secondary canopy layer. Associated species may include <i>Allocasuarina littoralis</i> , <i>Angophora bakeri</i> , <i>Aristida spp.</i> <i>Banksia spinulosa</i> , <i>Cryptandra spp.</i> <i>Daviesia ulicifolia</i> , <i>Entolasia stricta</i> , <i>Hakea sericea</i> , <i>Lissanthe strigosa</i> , <i>Melaleuca nodosa</i> , <i>Ozothamnus diosmifolius</i> and <i>Themeda australis</i> .	Low
	Fabaceae (Mimosoi deae)	<i>Acacia pubescens</i>	Downy Wattle	V	V	3	Occurs on alluviums, shales and at the intergrade between shales and sandstones. The soils are characteristically gravelly soils, often with ironstone. Occurs in open woodland and forest, in a variety of plant communities, including Cooks River/Castlereagh Ironbark Forest, Shale/Gravel Transition Forest and Cumberland Plain Woodland.	Low
	Malvacea e	<i>Lasiopetalum joyceae</i>		V	V	1	Has a restricted range occurring on lateritic to shaley ridgetops on the Hornsby Plateau south of the Hawkesbury River. It is currently known from 34 sites between Berrilee and Duffys Forest. Seventeen of these are reserved.	Low



Class	Family	Scientific Name	Common Name	NSW status	Comm .status	Records	Description	Likelihood
	Myrtaceae	<i>Callistemon linearifolius</i>	Netted Bottle Brush	V,3		5	Recorded from the Georges River to Hawkesbury River in the Sydney area, and north to the Nelson Bay area of NSW. Recorded in 2000 at Coalcliff in the northern Illawarra. For the Sydney area, recent records are limited to the Hornsby Plateau area near the Hawkesbury River. The species was more widespread in the past, and there are currently only 5-6 populations remaining from the 22 populations historically recorded in the Sydney area. Three of the remaining populations are reserved in Ku-ring-gai Chase National Park, Lion Island Nature Reserve and Spectacle Island Nature Reserve. The species has also been recorded from Yengo National Park.	Low
	Myrtaceae	<i>Darwinia biflora</i>		V	V	9	Occurs on the edges of weathered shale-capped ridges, where these intergrade with Hawkesbury Sandstone. Associated overstorey species include <i>Eucalyptus haemastoma</i> , <i>Corymbia gummifera</i> and/or <i>E. squamosa</i> . The vegetation structure is usually woodland, open forest or scrub-heath.	Low
	Myrtaceae	<i>Melaleuca deanei</i>	Deane's Paperbark	V	V	1	Deane's Paperbark occurs in two distinct areas, in the Ku-ring-gai/Berowra and Holsworthy/Wedderburn areas respectively. There are also more isolated occurrences at Springwood (in the Blue Mountains), Wollemi National Park, Yalwal (west of Nowra) and Central Coast (Hawkesbury River) areas.	Low
	Myrtaceae	<i>Rhodamnia rubescens</i>	Scrub Turpentine	E4A	CE	1	Occurs in coastal districts north from Batemans Bay in New South Wales, approximately 280 km south of Sydney, to areas inland of Bundaberg in Queensland. Populations of <i>R. rubescens</i> typically occur in coastal regions and occasionally extend inland onto escarpments up to 600 m a.s.l. in areas with rainfall of 1,000-1,600 mm.	Low



Class	Family	Scientific Name	Common Name	NSW status	Comm .status	Records	Description	Likelihood
	Myrtaceae	<i>Syzygium paniculatum</i>	Magenta Lilly Pilly	E1	V	7	On the south coast the Magenta Lilly Pilly occurs on grey soils over sandstone, restricted mainly to remnant stands of littoral (coastal) rainforest. On the central coast Magenta Lilly Pilly occurs on gravels, sands, silts and clays in riverside gallery rainforests and remnant littoral rainforest communities.	Low
	Potamogetonaceae	<i>Zannichellia palustris</i>		E1		2	In NSW, known from the lower Hunter and in Sydney Olympic Park. Grows in fresh or slightly saline stationary or slowly flowing water.	Low
	Rhamnaceae	<i>Pomaderris prunifolia</i>	P. prunifolia in the Parramatta, Auburn, Strathfield and Bankstown Local Government Areas	E2		2	At Rydalmere it occurs along a road reserve near a creek, among grass species on sandstone. At Rookwood Cemetery it occurs in a small gully of degraded Cooks River / Castlereagh Ironbark Forest on shale soils.	Low



APPENDIX C ARBORIST REPORT - REV A

COMMERCIAL IN CONFIDENCE



Melbourne

15 Business Park Drive
Notting Hill VIC 3168
Telephone (03) 8526 0800

Sydney

Suite 3, Level 1, 20 Wentworth Street
Parramatta NSW 2150
Telephone (02) 9354 0300

Brisbane

Level 5, 43 Peel Street
South Brisbane QLD 4101
Telephone (07) 3105 1460

Adelaide

1/198 Greenhill Road
Eastwood SA 5063
Telephone (08) 8378 8000

Perth

Level 1, 21 Adelaide Street
Fremantle WA 6160
Telephone (08) 6555 0105

New Zealand

7/3 Empire Street
Cambridge New Zealand 3434
Telephone +64 27 777 0989

Wangaratta

First Floor, 40 Rowan Street
Wangaratta VIC 3677
Telephone (03) 5721 2650

Geelong

51 Little Fyans Street
Geelong VIC 3220
Telephone (03) 8526 0800

Wimmera

597 Joel South Road
Stawell VIC 3380
Telephone 0438 510 240

Gold Coast

Suite 37, Level 4, 194 Varsity Parade
Varsity Lakes QLD 4227
Telephone (07) 5676 7602

watertech.com.au

